



City of Detroit - Planning & Development Department  
2 Woodward Avenue, Suite 808  
Detroit, Michigan 48226

# HISTORIC DISTRICT COMMISSION ADDITIONAL INFORMATION REQUEST

**Date:** 08/01/2025

**Application Number:** HDC2025-00504

## APPLICANT & PROPERTY INFORMATION

**NAME:** Alvaro Abramuk De la Rosa

**COMPANY NAME:** Abramuk LLC

**ADDRESS:** 1667 pingree st

**CITY:** Detroit

**STATE:** MI

**ZIP:** 48206

**PROJECT ADDRESS:** 4000 tyler St.

**HISTORIC DISTRICT:** Russell Woods-Sullivan

## REQUESTED INFORMATION

We have received your application, but it is not yet complete for review. Please provide additional details based on the comments and questions listed below. Should you need to attach additional files per this request, use the paperclip icons at the end of this form. You may attach up to (5) files per icon up to 25MB:

This application is not yet complete. Please provide the following information:

1. Dimensions, materials, and specs of the front and rear porch railings.

Please note that staff does not have the authority to approve front porch alterations. This application will have to be reviewed by the Historic District Commission. Upon receipt of the missing information, this application will be docketed for the next available HDC meeting.

## APPLICANT RESPONSE

Response Date: 08/04/2025



FRONT PORCHE: No modifications were made to the original dimensions or structure of the front porch. Targeted repairs were completed using brick and cement in the affected areas. A weather-resistant exterior wooden railing was added, maintaining the original porch height and prioritizing safety. The concrete steps were replaced in accordance with city regulations and in harmony with neighboring homes, preserving the original look and façade of the property.

BACK PORCHE: No modifications were made to the original dimensions or structure of the rear porch. Targeted repairs were completed using brick and cement in the damaged areas. A weather-resistant exterior wooden railing was installed, maintaining the original height and ensuring safety. The original steps were preserved, as they were in good condition and posed no safety concerns. All work was done with respect to the original appearance of the property.

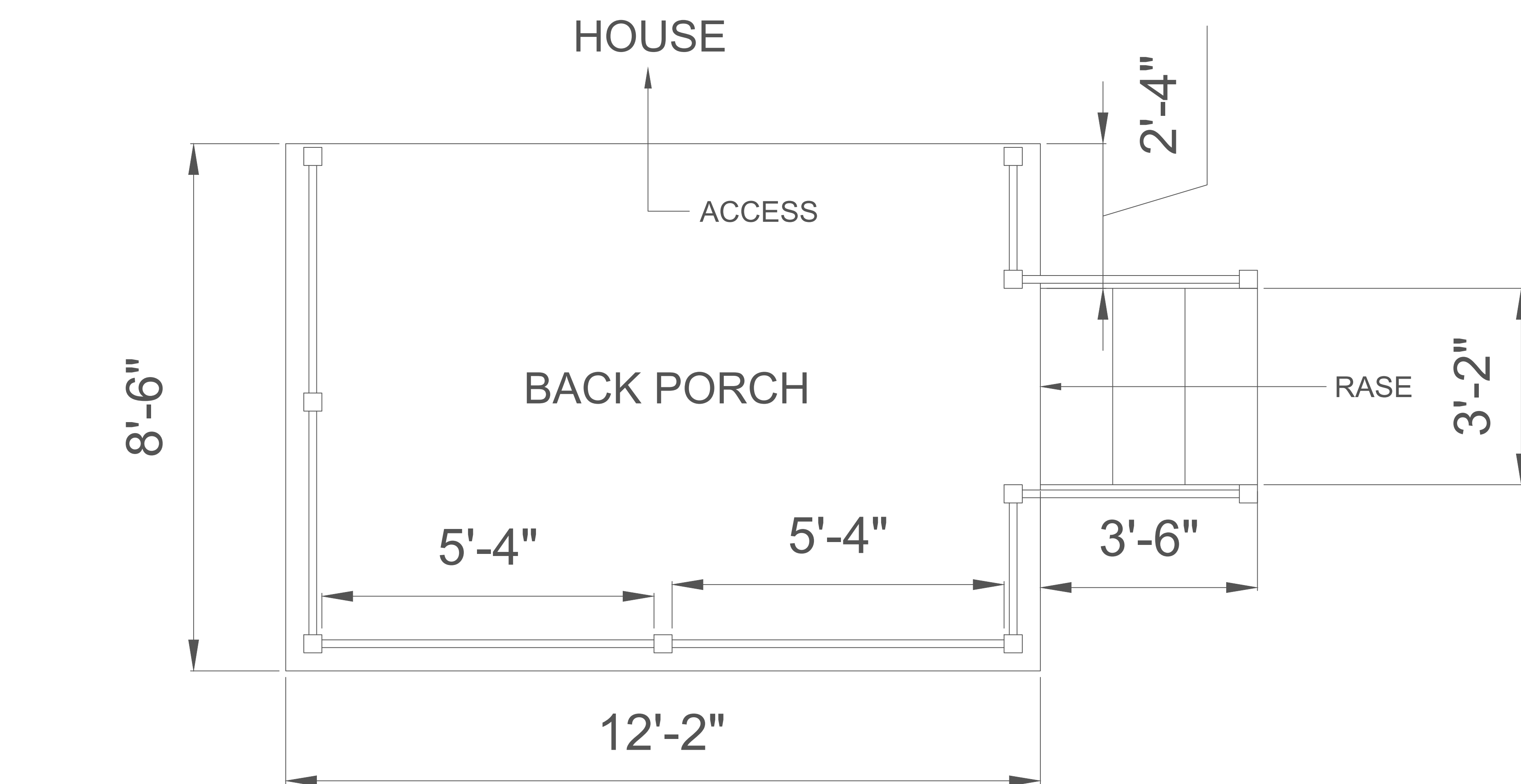

PLAN VIEW.



BACK PORCH - FRONT VIEW.

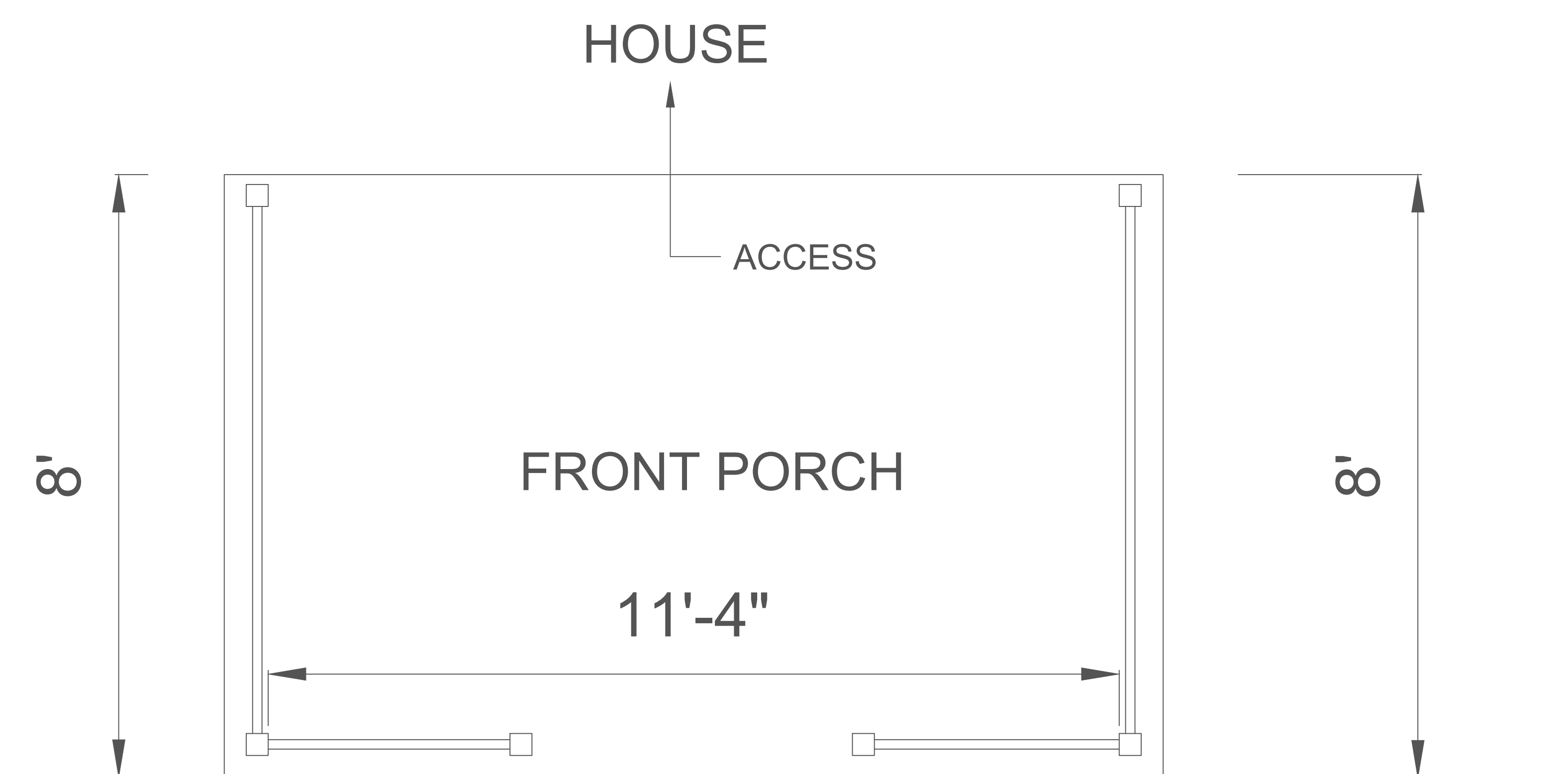

PLAN VIEW.

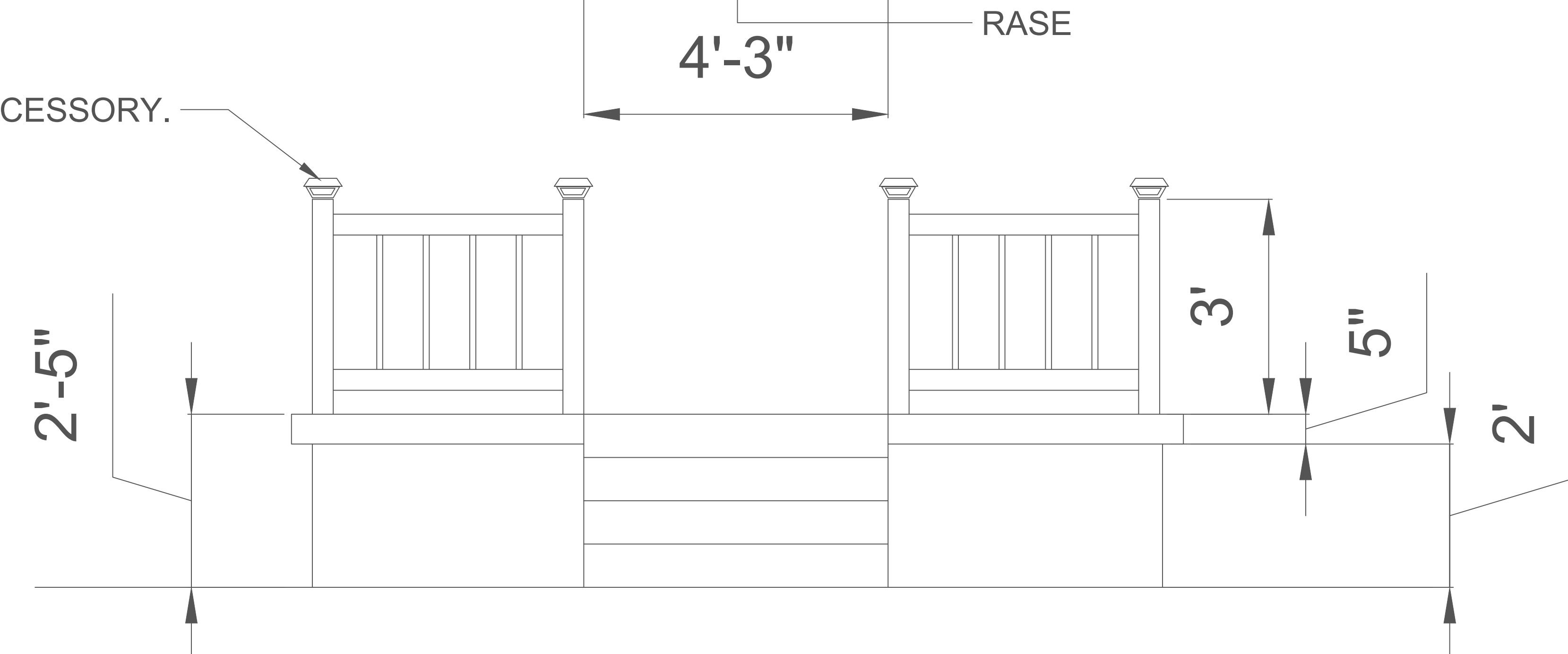

FRONT PORCH - FRONT VIEW.

SIZES AND DIMENSIONS AREA APPROXIMATE , ACTUAL MAY VARY.