



City of Detroit - Planning & Development Department
2 Woodward Avenue, Suite 808
Detroit, Michigan 48226

HISTORIC DISTRICT COMMISSION ADDITIONAL INFORMATION REQUEST

Date: 04/21/2025

Application Number: HDC2025-00191

APPLICANT & PROPERTY INFORMATION

NAME: Alexander Belilovsky

COMPANY NAME: Alexandria Home Solutions

ADDRESS: 24293 Telegraph Road

CITY: Southfield

STATE: MI

ZIP: 48033

PROJECT ADDRESS: 19410 Canterbury Road

HISTORIC DISTRICT: Sherwood Forest

REQUESTED INFORMATION

We have received your application, but it is not yet complete for review. Please provide additional details based on the comments and questions listed below. Should you need to attach additional files per this request, use the paperclip icons at the end of this form. You may attach up to (5) files per icon up to 25MB:

This application is not completed. Please provide the following:

- Window schedule, which describes the existing windows and shows the proposed new windows, their material, operation, dimensions, and color
- Photos of the exterior elevations of the house with labels that show which windows on the window schedule are being placed where

Note: this case will likely need to be reviewed by the Commission at a meeting.

Thank you!

PSR: 250421LS

APPLICANT RESPONSE

Response Date: 04/21/2025



I have attached a detailed window schedule showing each window unit and their respective location in the home. I am meeting with the homeowner later this week to obtain photos of the exterior showing the full facades of the home and will label and upload these photos this week.

- It is the responsibility of the architect and/or contractor to determine proper fit and function of any product relative to code requirements in the municipality of a given building site. - All installations should be performed by an approved, certified installer and be installed in accordance with AAMA Installation Masters methodology. - It is the responsibility of the installer to properly install products and to verify compatibility of sealants, flashing, and all building envelope membrane system components. - It is the responsibility of the installer to adequately shim all windows and doors. The shim placement should start no more than 4 inches from each corner, then every 12 to 16 inches thereafter. Shims are required at the check rails on double hung windows. - For complete and product specific installation instructions please refer to our installation manual or contact your Sierra Pacific Windows Representative. - Blocking, sealant / caulking, installation, interior trim, fasteners, flashing, metal trim, sill pans and shims are not supplied unless otherwise noted. - Sierra Pacific Windows is not responsible for repair or replacement of products damaged by other trades, window protection or storage following delivery, label removal or final cleaning. - For warranty questions, please refer to Sierra Pacific Limited Warranty. - Improper installation will void the warranty. - Manufacturing lead time does not begin until all signed submittals have been received at the Sierra Pacific Windows Office. - Sierra Pacific is not responsible for the design of, conditions in, or performance of building construction beyond the perimeters of the Sierra Pacific units. - Sierra Pacific is not responsible for any errors incurred through the use of these drawings by others. - Sierra Pacific is not responsible for improper installation. - It is the Distributor's responsibility to verify that all items specified on the order are correct. TEMPERED GLASS NOTES: The manufacturing of tempered glass involves heating and cooling processes that impart a minor wave distortion in the glass surface resulting in non-flat reflection. Currently, there is no industry standard for wave distortion in tempered glass. There are no methods or tools available for measuring wave distortion in the field and any attempt at measurement is subjective at best. Most field applications are insulated glass units which, due to their construction and in combination with various environmental factors, also affect reflection. Wave distortion is an unavoidable characteristic of tempered glass that does not impair the integrity of the glass, is not recognized in the industry as a defect and is, therefore, a non-warrantable item.

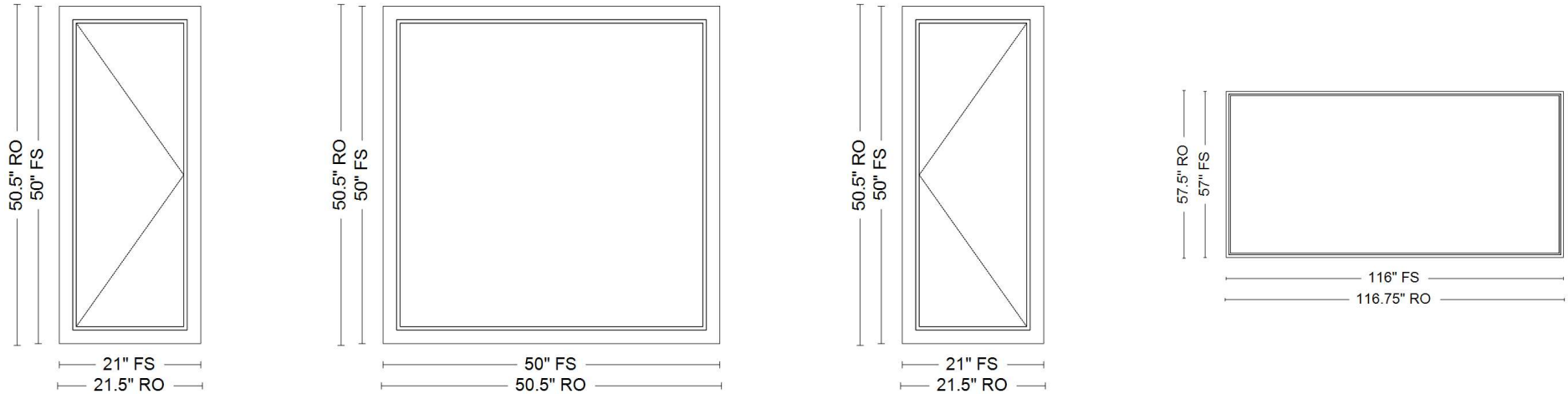

Room Location:
KITCHEN

Line Item: 100 Qty: 1

Casement

•21" X 50" FRAME SIZE
•21.5" X 50.5" ROUGH OPENING

Room Location:
KITCHEN

Line Item: 200 Qty: 1

Casement Picture

•50" X 50" FRAME SIZE
•50.5" X 50.5" ROUGH OPENING

Room Location:
KITCHEN

Line Item: 300 Qty: 1

Casement

•21" X 50" FRAME SIZE
•21.5" X 50.5" ROUGH OPENING

Room Location:
DINING

Line Item: 400 Qty: 1

Rectangle

•116" X 57" FRAME SIZE
•116.75" X 57.5" ROUGH OPENING

APPROVED SHOP DRAWINGS MUST BE SIGNED OR STAMPED BY THE FOLLOWING BEFORE THIS PROJECT WILL BE RELEASED INTO A PRODUCTION ORDER. THE SIGNATURES REQUIRED ARE TO CONFIRM THAT QUANTITIES, SIZES AND HANDING. HAVE BEEN REVIEWED AND APPROVED.

Distributor _____ Date _____ Architect _____ Date _____ Contractor _____ Date _____

- It is the responsibility of the architect and/or contractor to determine proper fit and function of any product relative to code requirements in the municipality of a given building site. - All installations should be performed by an approved, certified installer and be installed in accordance with AAMA Installation Masters methodology. - It is the responsibility of the installer to properly install products and to verify compatibility of sealants, flashing, and all building envelope membrane system components. - It is the responsibility of the installer to adequately shim all windows and doors. The shim placement should start no more than 4 inches from each corner, then every 12 to 16 inches thereafter. Shims are required at the check rails on double hung windows. - For complete and product specific installation instructions please refer to our installation manual or contact your Sierra Pacific Windows Representative. - Blocking, sealant / caulking, installation, interior trim, fasteners, flashing, metal trim, sill pans and shims are not supplied unless otherwise noted. - Sierra Pacific Windows is not responsible for repair or replacement of products damaged by other trades, window protection or storage following delivery, label removal or final cleaning. - For warranty questions, please refer to Sierra Pacific Limited Warranty. - Improper installation will void the warranty. - Manufacturing lead time does not begin until all signed submittals have been received at the Sierra Pacific Windows Office. - Sierra Pacific is not responsible for the design of, conditions in, or performance of building construction beyond the perimeters of the Sierra Pacific units. - Sierra Pacific is not responsible for any errors incurred through the use of these drawings by others. - Sierra Pacific is not responsible for improper installation. - It is the Distributor's responsibility to verify that all items specified on the order are correct. TEMPERED GLASS NOTES: The manufacturing of tempered glass involves heating and cooling processes that impart a minor wave distortion in the glass surface resulting in non-flat reflection. Currently, there is no industry standard for wave distortion in tempered glass. There are no methods or tools available for measuring wave distortion in the field and any attempt at measurement is subjective at best. Most field applications are insulated glass units which, due to their construction and in combination with various environmental factors, also affect reflection. Wave distortion is an unavoidable characteristic of tempered glass that does not impair the integrity of the glass, is not recognized in the industry as a defect and is, therefore, a non-warrantable item.

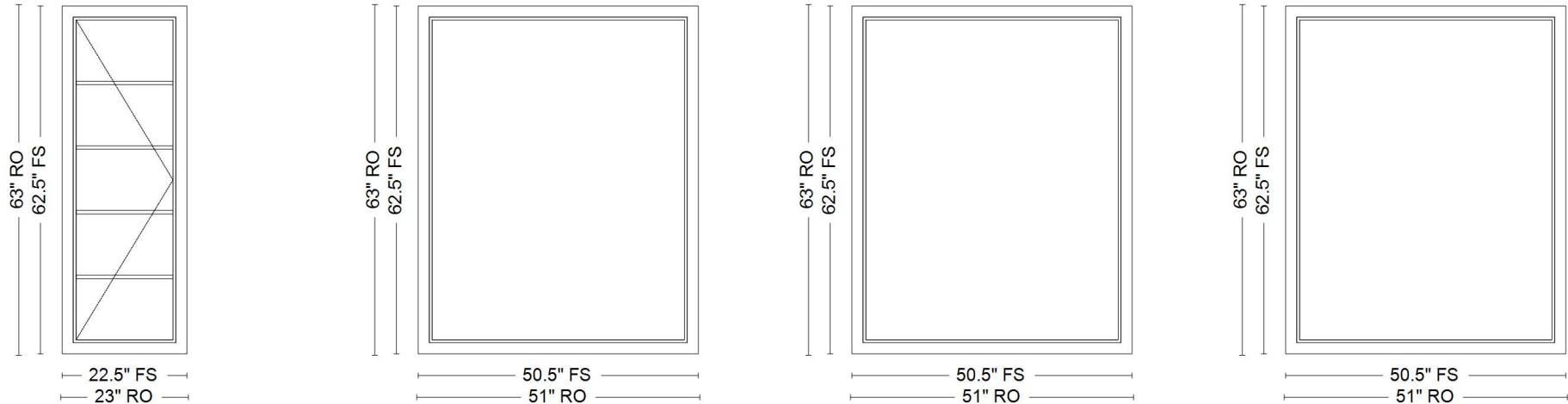

Room Location:
LIVING

Line Item: 500 Qty: 1

Casement

- 22.5" X 62.5" FRAME SIZE
- 23" X 63" ROUGH OPENING

Room Location:
LIVING

Line Item: 600 Qty: 1

Casement Picture

- 50.5" X 62.5" FRAME SIZE
- 51" X 63" ROUGH OPENING

Room Location:
LIVING

Line Item: 700 Qty: 1

Casement Picture

- 50.5" X 62.5" FRAME SIZE
- 51" X 63" ROUGH OPENING

Room Location:
LIVING

Line Item: 800 Qty: 1

Casement Picture

- 50.5" X 62.5" FRAME SIZE
- 51" X 63" ROUGH OPENING

APPROVED SHOP DRAWINGS MUST BE SIGNED OR STAMPED BY THE FOLLOWING BEFORE THIS PROJECT WILL BE RELEASED INTO A PRODUCTION ORDER. THE SIGNATURES REQUIRED ARE TO CONFIRM THAT QUANTITIES, SIZES AND HANDING. HAVE BEEN REVIEWED AND APPROVED.

Distributor _____ Date _____ Architect _____ Date _____ Contractor _____ Date _____

- It is the responsibility of the architect and/or contractor to determine proper fit and function of any product relative to code requirements in the municipality of a given building site. - All installations should be performed by an approved, certified installer and be installed in accordance with AAMA Installation Masters methodology. - It is the responsibility of the installer to properly install products and to verify compatibility of sealants, flashing, and all building envelope membrane system components. - It is the responsibility of the installer to adequately shim all windows and doors. The shim placement should start no more than 4 inches from each corner, then every 12 to 16 inches thereafter. Shims are required at the check rails on double hung windows. - For complete and product specific installation instructions please refer to our installation manual or contact your Sierra Pacific Windows Representative. - Blocking, sealant / caulking, installation, interior trim, fasteners, flashing, metal trim, sill pans and shims are not supplied unless otherwise noted. - Sierra Pacific Windows is not responsible for repair or replacement of products damaged by other trades, window protection or storage following delivery, label removal or final cleaning. - For warranty questions, please refer to Sierra Pacific Limited Warranty. - Improper installation will void the warranty. - Manufacturing lead time does not begin until all signed submittals have been received at the Sierra Pacific Windows Office. - Sierra Pacific is not responsible for the design of, conditions in, or performance of building construction beyond the perimeters of the Sierra Pacific units. - Sierra Pacific is not responsible for any errors incurred through the use of these drawings by others. - Sierra Pacific is not responsible for improper installation. - It is the Distributor's responsibility to verify that all items specified on the order are correct. **TEMPERED GLASS NOTES:** The manufacturing of tempered glass involves heating and cooling processes that impart a minor wave distortion in the glass surface resulting in non-flat reflection. Currently, there is no industry standard for wave distortion in tempered glass. There are no methods or tools available for measuring wave distortion in the field and any attempt at measurement is subjective at best. Most field applications are insulated glass units which, due to their construction and in combination with various environmental factors, also affect reflection. Wave distortion is an unavoidable characteristic of tempered glass that does not impair the integrity of the glass, is not recognized in the industry as a defect and is, therefore, a non-warrantable item.

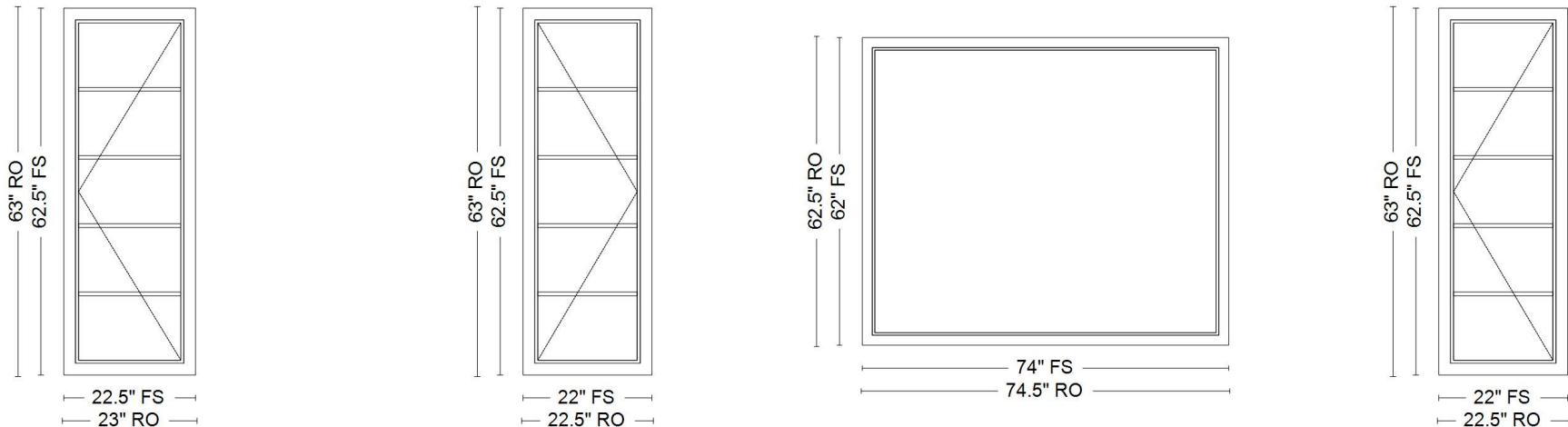

Room Location:
LIVING

Line Item: 900 Qty: 1

Casement

- 22.5" X 62.5" FRAME SIZE
- 23" X 63" ROUGH OPENING

Room Location:
OFFICE

Line Item: 1000 Qty: 1

Casement

- 22" X 62.5" FRAME SIZE
- 22.5" X 63" ROUGH OPENING

Room Location:
OFFICE

Line Item: 1100 Qty: 1

Casement Picture

- 74" X 62" FRAME SIZE
- 74.5" X 62.5" ROUGH OPENING

Room Location:
OFFICE

Line Item: 1200 Qty: 1

Casement

- 22" X 62.5" FRAME SIZE
- 22.5" X 63" ROUGH OPENING

APPROVED SHOP DRAWINGS MUST BE SIGNED OR STAMPED BY THE FOLLOWING BEFORE THIS PROJECT WILL BE RELEASED INTO A PRODUCTION ORDER. THE SIGNATURES REQUIRED ARE TO CONFIRM THAT QUANTITIES, SIZES AND HANDING. HAVE BEEN REVIEWED AND APPROVED.

Distributor _____ Date _____ Architect _____ Date _____ Contractor _____ Date _____

- It is the responsibility of the architect and/or contractor to determine proper fit and function of any product relative to code requirements in the municipality of a given building site. - All installations should be performed by an approved, certified installer and be installed in accordance with AAMA Installation Masters methodology. - It is the responsibility of the installer to properly install products and to verify compatibility of sealants, flashing, and all building envelope membrane system components. - It is the responsibility of the installer to adequately shim all windows and doors. The shim placement should start no more than 4 inches from each corner, then every 12 to 16 inches thereafter. Shims are required at the check rails on double hung windows. - For complete and product specific installation instructions please refer to our installation manual or contact your Sierra Pacific Windows Representative. - Blocking, sealant / caulking, installation, interior trim, fasteners, flashing, metal trim, sill pans and shims are not supplied unless otherwise noted. - Sierra Pacific Windows is not responsible for repair or replacement of products damaged by other trades, window protection or storage following delivery, label removal or final cleaning. - For warranty questions, please refer to Sierra Pacific Limited Warranty. - Improper installation will void the warranty. - Manufacturing lead time does not begin until all signed submittals have been received at the Sierra Pacific Windows Office. - Sierra Pacific is not responsible for the design of, conditions in, or performance of building construction beyond the perimeters of the Sierra Pacific units. - Sierra Pacific is not responsible for any errors incurred through the use of these drawings by others. - Sierra Pacific is not responsible for improper installation. - It is the Distributor's responsibility to verify that all items specified on the order are correct. **TEMPERED GLASS NOTES:** The manufacturing of tempered glass involves heating and cooling processes that impart a minor wave distortion in the glass surface resulting in non-flat reflection. Currently, there is no industry standard for wave distortion in tempered glass. There are no methods or tools available for measuring wave distortion in the field and any attempt at measurement is subjective at best. Most field applications are insulated glass units which, due to their construction and in combination with various environmental factors, also affect reflection. Wave distortion is an unavoidable characteristic of tempered glass that does not impair the integrity of the glass, is not recognized in the industry as a defect and is, therefore, a non-warrantable item.

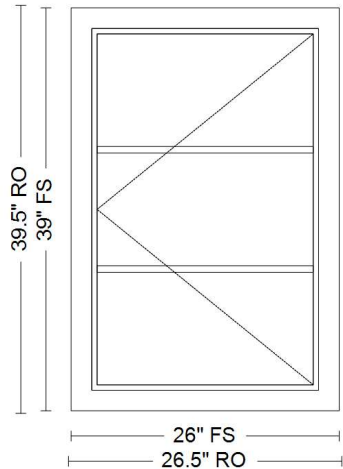
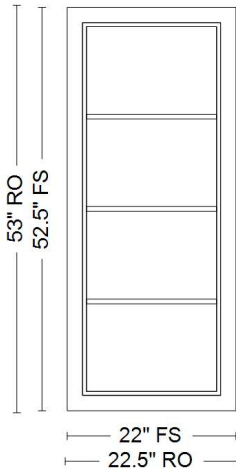
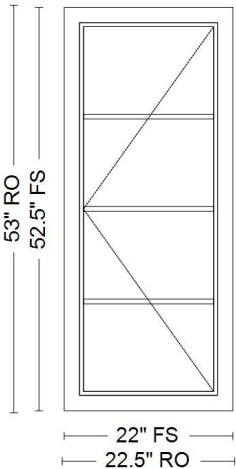
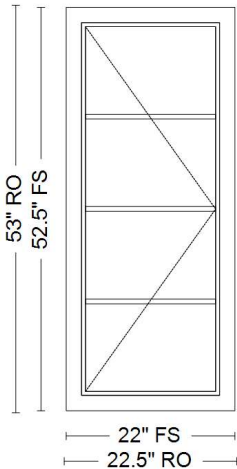

Room Location:
OFFICE

Line Item: 1300 Qty: 1

Casement

- 22" X 52.5" FRAME SIZE
- 22.5" X 53" ROUGH OPENING

Room Location:
OFFICE

Line Item: 1400 Qty: 1

Casement

- 22" X 52.5" FRAME SIZE
- 22.5" X 53" ROUGH OPENING

Room Location:
OFFICE

Line Item: 1500 Qty: 1

Casement

- 22" X 52.5" FRAME SIZE
- 22.5" X 53" ROUGH OPENING

Room Location:
BATH

Line Item: 1600 Qty: 1

Casement

- 26" X 39" FRAME SIZE
- 26.5" X 39.5" ROUGH OPENING

APPROVED SHOP DRAWINGS MUST BE SIGNED OR STAMPED BY THE FOLLOWING BEFORE THIS PROJECT WILL BE RELEASED INTO A PRODUCTION ORDER. THE SIGNATURES REQUIRED ARE TO CONFIRM THAT QUANTITIES, SIZES AND HANDING. HAVE BEEN REVIEWED AND APPROVED.

Distributor _____ Date _____ Architect _____ Date _____ Contractor _____ Date _____

- It is the responsibility of the architect and/or contractor to determine proper fit and function of any product relative to code requirements in the municipality of a given building site. - All installations should be performed by an approved, certified installer and be installed in accordance with AAMA Installation Masters methodology. - It is the responsibility of the installer to properly install products and to verify compatibility of sealants, flashing, and all building envelope membrane system components. - It is the responsibility of the installer to adequately shim all windows and doors. The shim placement should start no more than 4 inches from each corner, then every 12 to 16 inches thereafter. Shims are required at the check rails on double hung windows. - For complete and product specific installation instructions please refer to our installation manual or contact your Sierra Pacific Windows Representative. - Blocking, sealant / caulking, installation, interior trim, fasteners, flashing, metal trim, sill pans and shims are not supplied unless otherwise noted. - Sierra Pacific Windows is not responsible for repair or replacement of products damaged by other trades, window protection or storage following delivery, label removal or final cleaning. - For warranty questions, please refer to Sierra Pacific Limited Warranty. - Improper installation will void the warranty. - Manufacturing lead time does not begin until all signed submittals have been received at the Sierra Pacific Windows Office. - Sierra Pacific is not responsible for the design of, conditions in, or performance of building construction beyond the perimeters of the Sierra Pacific units. - Sierra Pacific is not responsible for any errors incurred through the use of these drawings by others. - Sierra Pacific is not responsible for improper installation. - It is the Distributor's responsibility to verify that all items specified on the order are correct. **TEMPERED GLASS NOTES:** The manufacturing of tempered glass involves heating and cooling processes that impart a minor wave distortion in the glass surface resulting in non-flat reflection. Currently, there is no industry standard for wave distortion in tempered glass. There are no methods or tools available for measuring wave distortion in the field and any attempt at measurement is subjective at best. Most field applications are insulated glass units which, due to their construction and in combination with various environmental factors, also affect reflection. Wave distortion is an unavoidable characteristic of tempered glass that does not impair the integrity of the glass, is not recognized in the industry as a defect and is, therefore, a non-warrantable item.

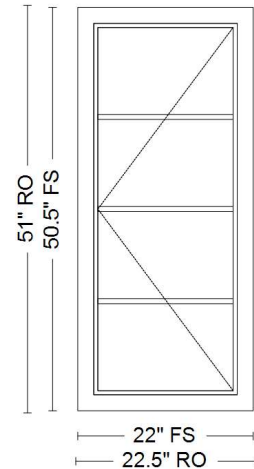
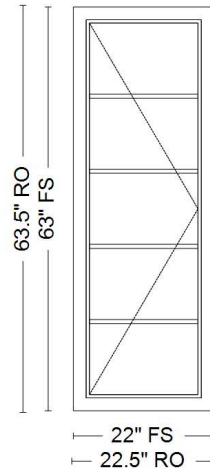
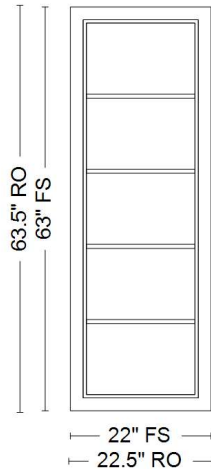
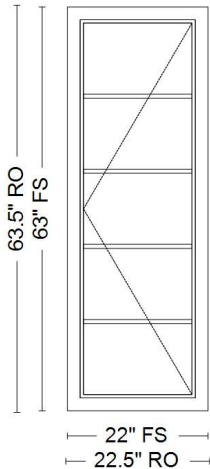

Room Location:
STAIRS

Line Item: 1700 Qty: 1

Casement

- 22" X 63" FRAME SIZE
- 22.5" X 63.5" ROUGH OPENING

Room Location:
STAIRS

Line Item: 1800 Qty: 1

Casement

- 22" X 63" FRAME SIZE
- 22.5" X 63.5" ROUGH OPENING

Room Location:
STAIRS

Line Item: 1900 Qty: 1

Casement

- 22" X 63" FRAME SIZE
- 22.5" X 63.5" ROUGH OPENING

Room Location:
BED 1

Line Item: 2000 Qty: 1

Casement

- 22" X 50.5" FRAME SIZE
- 22.5" X 51" ROUGH OPENING

APPROVED SHOP DRAWINGS MUST BE SIGNED OR STAMPED BY THE FOLLOWING BEFORE THIS PROJECT WILL BE RELEASED INTO A PRODUCTION ORDER. THE SIGNATURES REQUIRED ARE TO CONFIRM THAT QUANTITIES, SIZES AND HANDING. HAVE BEEN REVIEWED AND APPROVED.

Distributor _____ Date _____ Architect _____ Date _____ Contractor _____ Date _____

- It is the responsibility of the architect and/or contractor to determine proper fit and function of any product relative to code requirements in the municipality of a given building site. - All installations should be performed by an approved, certified installer and be installed in accordance with AAMA Installation Masters methodology. - It is the responsibility of the installer to properly install products and to verify compatibility of sealants, flashing, and all building envelope membrane system components. - It is the responsibility of the installer to adequately shim all windows and doors. The shim placement should start no more than 4 inches from each corner, then every 12 to 16 inches thereafter. Shims are required at the check rails on double hung windows. - For complete and product specific installation instructions please refer to our installation manual or contact your Sierra Pacific Windows Representative. - Blocking, sealant / caulking, installation, interior trim, fasteners, flashing, metal trim, sill pans and shims are not supplied unless otherwise noted. - Sierra Pacific Windows is not responsible for repair or replacement of products damaged by other trades, window protection or storage following delivery, label removal or final cleaning. - For warranty questions, please refer to Sierra Pacific Limited Warranty. - Improper installation will void the warranty. - Manufacturing lead time does not begin until all signed submittals have been received at the Sierra Pacific Windows Office. - Sierra Pacific is not responsible for the design of, conditions in, or performance of building construction beyond the perimeters of the Sierra Pacific units. - Sierra Pacific is not responsible for any errors incurred through the use of these drawings by others. - Sierra Pacific is not responsible for improper installation. - It is the Distributor's responsibility to verify that all items specified on the order are correct. **TEMPERED GLASS NOTES:** The manufacturing of tempered glass involves heating and cooling processes that impart a minor wave distortion in the glass surface resulting in non-flat reflection. Currently, there is no industry standard for wave distortion in tempered glass. There are no methods or tools available for measuring wave distortion in the field and any attempt at measurement is subjective at best. Most field applications are insulated glass units which, due to their construction and in combination with various environmental factors, also affect reflection. Wave distortion is an unavoidable characteristic of tempered glass that does not impair the integrity of the glass, is not recognized in the industry as a defect and is, therefore, a non-warrantable item.

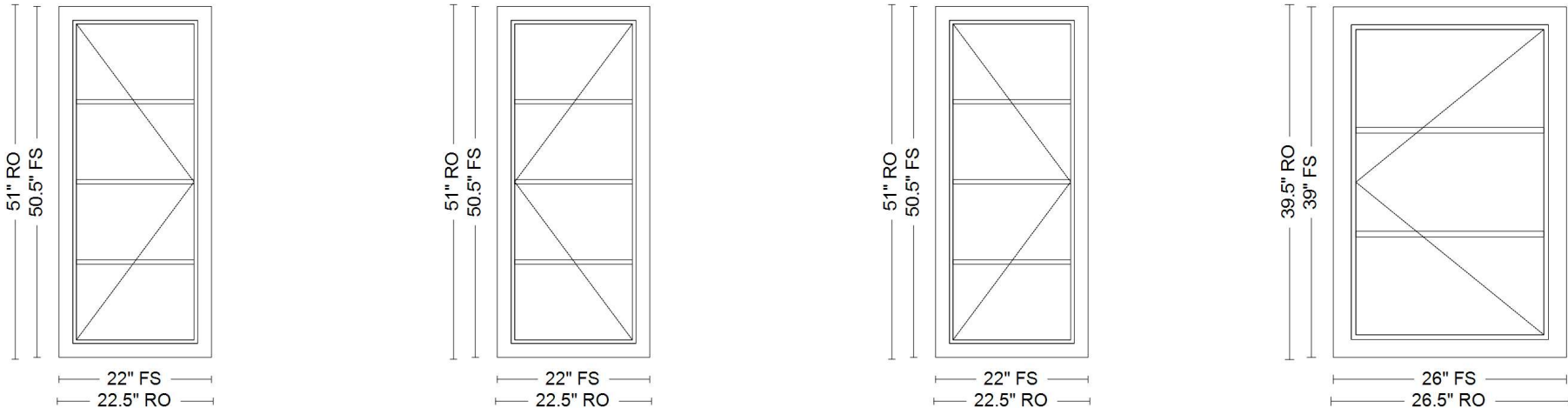

<div>Room Location: BED 1</div> <div>Line Item: 2100 Qty: 1</div> <div>Casement</div> <div>•22" X 50.5" FRAME SIZE •22.5" X 51" ROUGH OPENING</div>	<div>Room Location: BED 1</div> <div>Line Item: 2200 Qty: 1</div> <div>Casement</div> <div>•22" X 50.5" FRAME SIZE •22.5" X 51" ROUGH OPENING</div>	<div>Room Location: BED 1</div> <div>Line Item: 2300 Qty: 1</div> <div>Casement</div> <div>•22" X 50.5" FRAME SIZE •22.5" X 51" ROUGH OPENING</div>	<div>Room Location: BATH 1</div> <div>Line Item: 2400 Qty: 1</div> <div>Casement</div> <div>•26" X 39" FRAME SIZE •26.5" X 39.5" ROUGH OPENING</div>
---	---	---	--

APPROVED SHOP DRAWINGS MUST BE SIGNED OR STAMPED BY THE FOLLOWING BEFORE THIS PROJECT WILL BE RELEASED INTO A PRODUCTION ORDER.THE SIGNATURES REQUIRED ARE TO CONFIRM THAT QUANTITIES, SIZES AND HANDING. HAVE BEEN REVIEWED AND APPROVED.

Distributor

Date

Architect

Date

Contractor

Date

- It is the responsibility of the architect and/or contractor to determine proper fit and function of any product relative to code requirements in the municipality of a given building site. - All installations should be performed by an approved, certified installer and be installed in accordance with AAMA Installation Masters methodology. - It is the responsibility of the installer to properly install products and to verify compatibility of sealants, flashing, and all building envelope membrane system components. - It is the responsibility of the installer to adequately shim all windows and doors. The shim placement should start no more than 4 inches from each corner, then every 12 to 16 inches thereafter. Shims are required at the check rails on double hung windows. - For complete and product specific installation instructions please refer to our installation manual or contact your Sierra Pacific Windows Representative. - Blocking, sealant / caulking, installation, interior trim, fasteners, flashing, metal trim, sill pans and shims are not supplied unless otherwise noted. - Sierra Pacific Windows is not responsible for repair or replacement of products damaged by other trades, window protection or storage following delivery, label removal or final cleaning. - For warranty questions, please refer to Sierra Pacific Limited Warranty. - Improper installation will void the warranty. - Manufacturing lead time does not begin until all signed submittals have been received at the Sierra Pacific Windows Office. - Sierra Pacific is not responsible for the design of, conditions in, or performance of building construction beyond the perimeters of the Sierra Pacific units. - Sierra Pacific is not responsible for any errors incurred through the use of these drawings by others. - Sierra Pacific is not responsible for improper installation. - It is the Distributor's responsibility to verify that all items specified on the order are correct. TEMPERED GLASS NOTES: The manufacturing of tempered glass involves heating and cooling processes that impart a minor wave distortion in the glass surface resulting in non-flat reflection. Currently, there is no industry standard for wave distortion in tempered glass. There are no methods or tools available for measuring wave distortion in the field and any attempt at measurement is subjective at best. Most field applications are insulated glass units which, due to their construction and in combination with various environmental factors, also affect reflection. Wave distortion is an unavoidable characteristic of tempered glass that does not impair the integrity of the glass, is not recognized in the industry as a defect and is, therefore, a non-warrantable item.

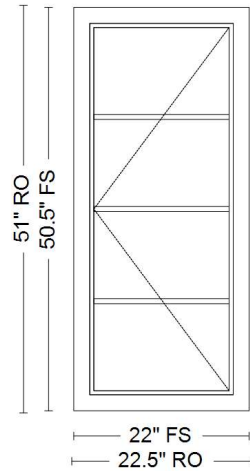
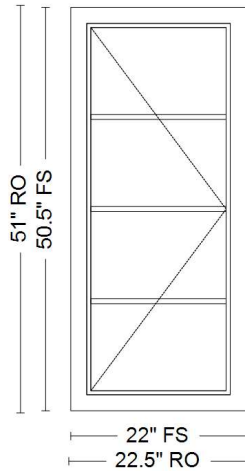
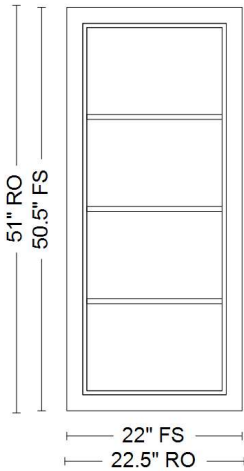
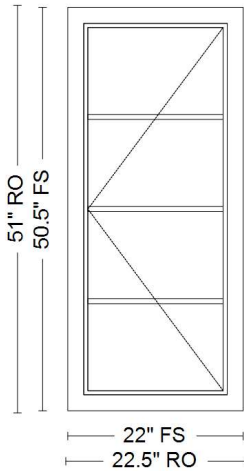

Room Location:
BABY

Line Item: 2500 Qty: 1

Casement

- 22" X 50.5" FRAME SIZE
- 22.5" X 51" ROUGH OPENING

Room Location:
BABY

Line Item: 2600 Qty: 1

Casement

- 22" X 50.5" FRAME SIZE
- 22.5" X 51" ROUGH OPENING

Room Location:
BABY

Line Item: 2700 Qty: 1

Casement

- 22" X 50.5" FRAME SIZE
- 22.5" X 51" ROUGH OPENING

Room Location:
MASTER

Line Item: 2800 Qty: 1

Casement

- 22" X 50.5" FRAME SIZE
- 22.5" X 51" ROUGH OPENING

APPROVED SHOP DRAWINGS MUST BE SIGNED OR STAMPED BY THE FOLLOWING BEFORE THIS PROJECT WILL BE RELEASED INTO A PRODUCTION ORDER. THE SIGNATURES REQUIRED ARE TO CONFIRM THAT QUANTITIES, SIZES AND HANDING. HAVE BEEN REVIEWED AND APPROVED.

Distributor _____ Date _____ Architect _____ Date _____ Contractor _____ Date _____

- It is the responsibility of the architect and/or contractor to determine proper fit and function of any product relative to code requirements in the municipality of a given building site. - All installations should be performed by an approved, certified installer and be installed in accordance with AAMA Installation Masters methodology. - It is the responsibility of the installer to properly install products and to verify compatibility of sealants, flashing, and all building envelope membrane system components. - It is the responsibility of the installer to adequately shim all windows and doors. The shim placement should start no more than 4 inches from each corner, then every 12 to 16 inches thereafter. Shims are required at the check rails on double hung windows. - For complete and product specific installation instructions please refer to our installation manual or contact your Sierra Pacific Windows Representative. - Blocking, sealant / caulking, installation, interior trim, fasteners, flashing, metal trim, sill pans and shims are not supplied unless otherwise noted. - Sierra Pacific Windows is not responsible for repair or replacement of products damaged by other trades, window protection or storage following delivery, label removal or final cleaning. - For warranty questions, please refer to Sierra Pacific Limited Warranty. - Improper installation will void the warranty. - Manufacturing lead time does not begin until all signed submittals have been received at the Sierra Pacific Windows Office. - Sierra Pacific is not responsible for the design of, conditions in, or performance of building construction beyond the perimeters of the Sierra Pacific units. - Sierra Pacific is not responsible for any errors incurred through the use of these drawings by others. - Sierra Pacific is not responsible for improper installation. - It is the Distributor's responsibility to verify that all items specified on the order are correct. TEMPERED GLASS NOTES: The manufacturing of tempered glass involves heating and cooling processes that impart a minor wave distortion in the glass surface resulting in non-flat reflection. Currently, there is no industry standard for wave distortion in tempered glass. There are no methods or tools available for measuring wave distortion in the field and any attempt at measurement is subjective at best. Most field applications are insulated glass units which, due to their construction and in combination with various environmental factors, also affect reflection. Wave distortion is an unavoidable characteristic of tempered glass that does not impair the integrity of the glass, is not recognized in the industry as a defect and is, therefore, a non-warrantable item.

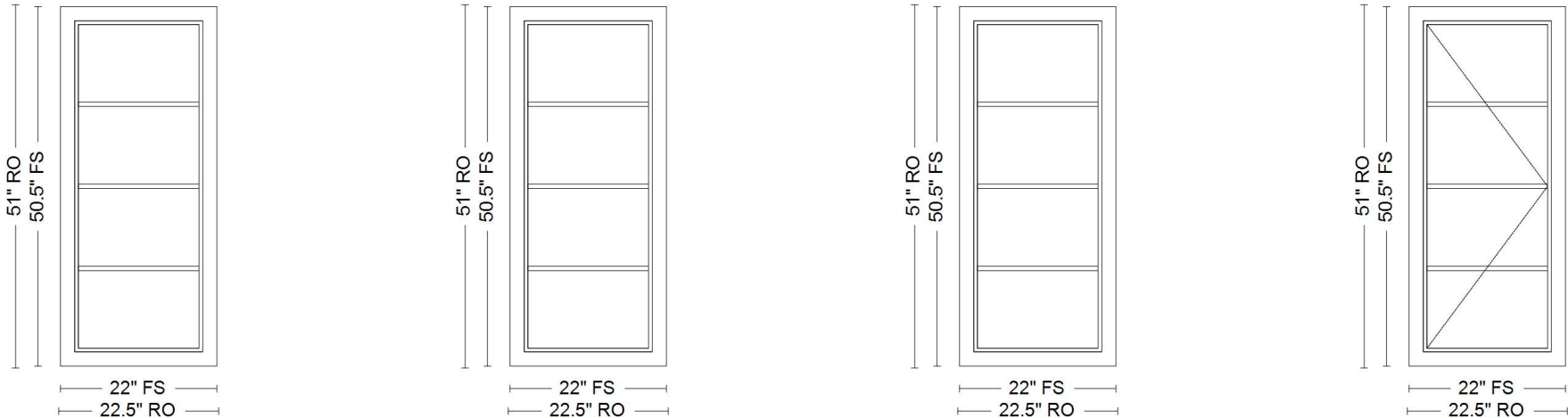

Room Location:
MASTER

Line Item: 2900 Qty: 1
Casement
•22" X 50.5" FRAME SIZE
•22.5" X 51" ROUGH OPENING

Room Location:
MASTER

Line Item: 3000 Qty: 1
Casement
•22" X 50.5" FRAME SIZE
•22.5" X 51" ROUGH OPENING

Room Location:
MASTER

Line Item: 3100 Qty: 1
Casement
•22" X 50.5" FRAME SIZE
•22.5" X 51" ROUGH OPENING

Room Location:
MASTER

Line Item: 3200 Qty: 1
Casement
•22" X 50.5" FRAME SIZE
•22.5" X 51" ROUGH OPENING

APPROVED SHOP DRAWINGS MUST BE SIGNED OR STAMPED BY THE FOLLOWING BEFORE THIS PROJECT WILL BE RELEASED INTO A PRODUCTION ORDER. THE SIGNATURES REQUIRED ARE TO CONFIRM THAT QUANTITIES, SIZES AND HANDING. HAVE BEEN REVIEWED AND APPROVED.

Distributor _____ Date _____ Architect _____ Date _____ Contractor _____ Date _____

- It is the responsibility of the architect and/or contractor to determine proper fit and function of any product relative to code requirements in the municipality of a given building site. - All installations should be performed by an approved, certified installer and be installed in accordance with AAMA Installation Masters methodology. - It is the responsibility of the installer to properly install products and to verify compatibility of sealants, flashing, and all building envelope membrane system components. - It is the responsibility of the installer to adequately shim all windows and doors. The shim placement should start no more than 4 inches from each corner, then every 12 to 16 inches thereafter. Shims are required at the check rails on double hung windows. - For complete and product specific installation instructions please refer to our installation manual or contact your Sierra Pacific Windows Representative. - Blocking, sealant / caulking, installation, interior trim, fasteners, flashing, metal trim, sill pans and shims are not supplied unless otherwise noted. - Sierra Pacific Windows is not responsible for repair or replacement of products damaged by other trades, window protection or storage following delivery, label removal or final cleaning. - For warranty questions, please refer to Sierra Pacific Limited Warranty. - Improper installation will void the warranty. - Manufacturing lead time does not begin until all signed submittals have been received at the Sierra Pacific Windows Office. - Sierra Pacific is not responsible for the design of, conditions in, or performance of building construction beyond the perimeters of the Sierra Pacific units. - Sierra Pacific is not responsible for any errors incurred through the use of these drawings by others. - Sierra Pacific is not responsible for improper installation. - It is the Distributor's responsibility to verify that all items specified on the order are correct. TEMPERED GLASS NOTES: The manufacturing of tempered glass involves heating and cooling processes that impart a minor wave distortion in the glass surface resulting in non-flat reflection. Currently, there is no industry standard for wave distortion in tempered glass. There are no methods or tools available for measuring wave distortion in the field and any attempt at measurement is subjective at best. Most field applications are insulated glass units which, due to their construction and in combination with various environmental factors, also affect reflection. Wave distortion is an unavoidable characteristic of tempered glass that does not impair the integrity of the glass, is not recognized in the industry as a defect and is, therefore, a non-warrantable item.

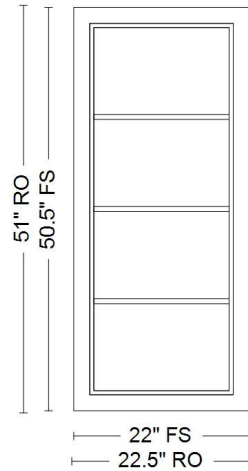
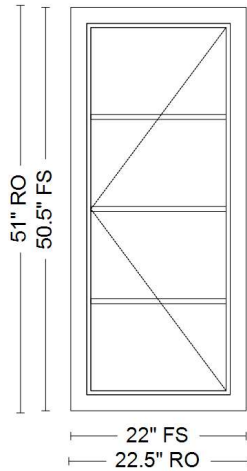
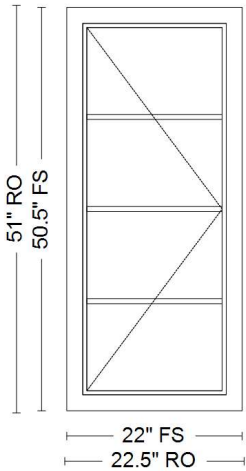
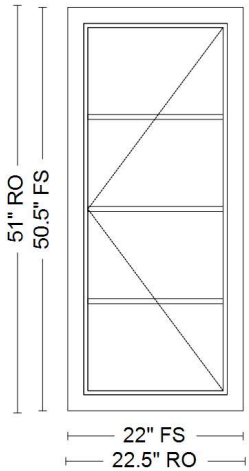

Room Location:
MASTER BATH

Line Item: 3300 Qty: 1
Casement
•22" X 50.5" FRAME SIZE
•22.5" X 51" ROUGH OPENING

Room Location:
MASTER BATH

Line Item: 3400 Qty: 1
Casement
•22" X 50.5" FRAME SIZE
•22.5" X 51" ROUGH OPENING

Room Location:
KIDS

Line Item: 3500 Qty: 1
Casement
•22" X 50.5" FRAME SIZE
•22.5" X 51" ROUGH OPENING

Room Location:
KIDS

Line Item: 3600 Qty: 1
Casement
•22" X 50.5" FRAME SIZE
•22.5" X 51" ROUGH OPENING

APPROVED SHOP DRAWINGS MUST BE SIGNED OR STAMPED BY THE FOLLOWING BEFORE THIS PROJECT WILL BE RELEASED INTO A PRODUCTION ORDER. THE SIGNATURES REQUIRED ARE TO CONFIRM THAT QUANTITIES, SIZES AND HANDING. HAVE BEEN REVIEWED AND APPROVED.

Distributor _____ Date _____ Architect _____ Date _____ Contractor _____ Date _____

- It is the responsibility of the architect and/or contractor to determine proper fit and function of any product relative to code requirements in the municipality of a given building site. - All installations should be performed by an approved, certified installer and be installed in accordance with AAMA Installation Masters methodology. - It is the responsibility of the installer to properly install products and to verify compatibility of sealants, flashing, and all building envelope membrane system components. - It is the responsibility of the installer to adequately shim all windows and doors. The shim placement should start no more than 4 inches from each corner, then every 12 to 16 inches thereafter. Shims are required at the check rails on double hung windows. - For complete and product specific installation instructions please refer to our installation manual or contact your Sierra Pacific Windows Representative. - Blocking, sealant / caulking, installation, interior trim, fasteners, flashing, metal trim, sill pans and shims are not supplied unless otherwise noted. - Sierra Pacific Windows is not responsible for repair or replacement of products damaged by other trades, window protection or storage following delivery, label removal or final cleaning. - For warranty questions, please refer to Sierra Pacific Limited Warranty. - Improper installation will void the warranty. - Manufacturing lead time does not begin until all signed submittals have been received at the Sierra Pacific Windows Office. - Sierra Pacific is not responsible for the design of, conditions in, or performance of building construction beyond the perimeters of the Sierra Pacific units. - Sierra Pacific is not responsible for any errors incurred through the use of these drawings by others. - Sierra Pacific is not responsible for improper installation. - It is the Distributor's responsibility to verify that all items specified on the order are correct. TEMPERED GLASS NOTES: The manufacturing of tempered glass involves heating and cooling processes that impart a minor wave distortion in the glass surface resulting in non-flat reflection. Currently, there is no industry standard for wave distortion in tempered glass. There are no methods or tools available for measuring wave distortion in the field and any attempt at measurement is subjective at best. Most field applications are insulated glass units which, due to their construction and in combination with various environmental factors, also affect reflection. Wave distortion is an unavoidable characteristic of tempered glass that does not impair the integrity of the glass, is not recognized in the industry as a defect and is, therefore, a non-warrantable item.

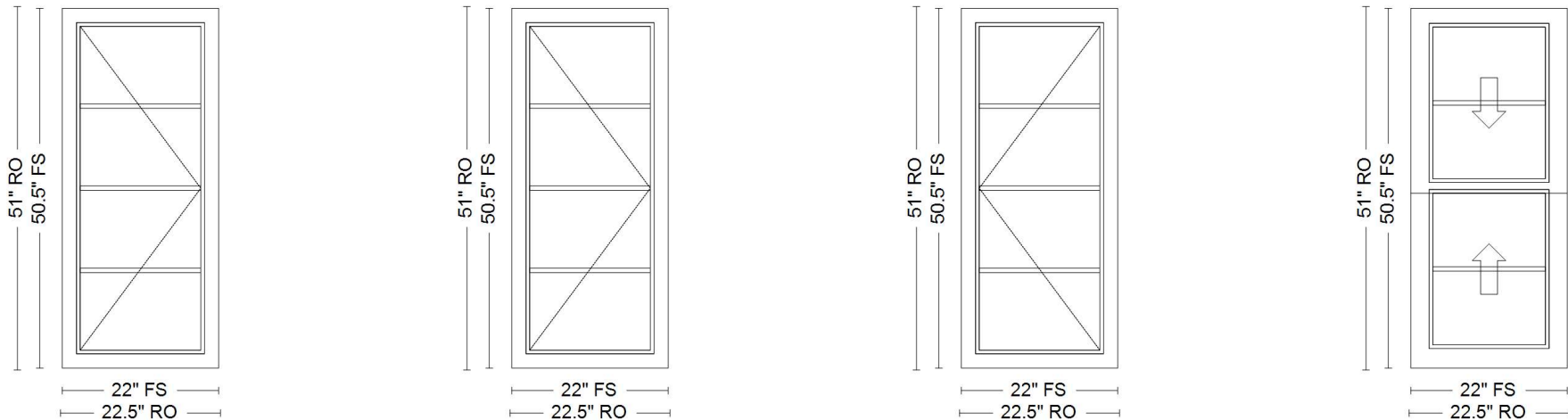

Room Location: KIDS	Room Location: KIDS	Room Location: KIDS	Room Location: MASTER BATH
Line Item: 3700 Qty: 1	Line Item: 3800 Qty: 1	Line Item: 3900 Qty: 1	Line Item: 4000 Qty: 1
Casement	Casement	Casement	Double Hung
•22" X 50.5" FRAME SIZE •22.5" X 51" ROUGH OPENING	•22" X 50.5" FRAME SIZE •22.5" X 51" ROUGH OPENING	•22" X 50.5" FRAME SIZE •22.5" X 51" ROUGH OPENING	•22" X 50.5" FRAME SIZE •22.5" X 51" ROUGH OPENING

APPROVED SHOP DRAWINGS MUST BE SIGNED OR STAMPED BY THE FOLLOWING BEFORE THIS PROJECT WILL BE RELEASED INTO A PRODUCTION ORDER. THE SIGNATURES REQUIRED ARE TO CONFIRM THAT QUANTITIES, SIZES AND HANDING. HAVE BEEN REVIEWED AND APPROVED.

Distributor _____ Date _____
Architect _____ Date _____
Contractor _____ Date _____

- It is the responsibility of the architect and/or contractor to determine proper fit and function of any product relative to code requirements in the municipality of a given building site. - All installations should be performed by an approved, certified installer and be installed in accordance with AAMA Installation Masters methodology. - It is the responsibility of the installer to properly install products and to verify compatibility of sealants, flashing, and all building envelope membrane system components. - It is the responsibility of the installer to adequately shim all windows and doors. The shim placement should start no more than 4 inches from each corner, then every 12 to 16 inches thereafter. Shims are required at the check rails on double hung windows. - For complete and product specific installation instructions please refer to our installation manual or contact your Sierra Pacific Windows Representative. - Blocking, sealant / caulking, installation, interior trim, fasteners, flashing, metal trim, sill pans and shims are not supplied unless otherwise noted. - Sierra Pacific Windows is not responsible for repair or replacement of products damaged by other trades, window protection or storage following delivery, label removal or final cleaning. - For warranty questions, please refer to Sierra Pacific Limited Warranty. - Improper installation will void the warranty. - Manufacturing lead time does not begin until all signed submittals have been received at the Sierra Pacific Windows Office. - Sierra Pacific is not responsible for the design of, conditions in, or performance of building construction beyond the perimeters of the Sierra Pacific units. - Sierra Pacific is not responsible for any errors incurred through the use of these drawings by others. - Sierra Pacific is not responsible for improper installation. - It is the Distributor's responsibility to verify that all items specified on the order are correct. **TEMPERED GLASS NOTES:** The manufacturing of tempered glass involves heating and cooling processes that impart a minor wave distortion in the glass surface resulting in non-flat reflection. Currently, there is no industry standard for wave distortion in tempered glass. There are no methods or tools available for measuring wave distortion in the field and any attempt at measurement is subjective at best. Most field applications are insulated glass units which, due to their construction and in combination with various environmental factors, also affect reflection. Wave distortion is an unavoidable characteristic of tempered glass that does not impair the integrity of the glass, is not recognized in the industry as a defect and is, therefore, a non-warrantable item.

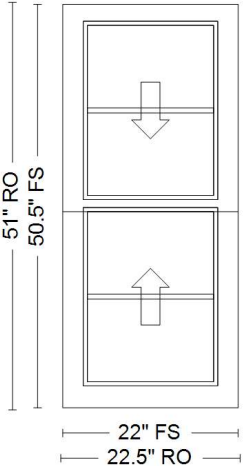

Room Location:
MASTER BATH

Line Item: 4100 Qty: 1

Double Hung

- 22" X 50.5" FRAME SIZE
- 22.5" X 51" ROUGH OPENING

APPROVED SHOP DRAWINGS MUST BE SIGNED OR STAMPED BY THE FOLLOWING BEFORE THIS PROJECT WILL BE RELEASED INTO A PRODUCTION ORDER. THE SIGNATURES REQUIRED ARE TO CONFIRM THAT QUANTITIES, SIZES AND HANDING. HAVE BEEN REVIEWED AND APPROVED.

_____	_____	_____	_____	_____	_____
Distributor	Date	Architect	Date	Contractor	Date