



City of Detroit - Planning & Development Department
2 Woodward Avenue, Suite 808
Detroit, Michigan 48226

HISTORIC DISTRICT COMMISSION ADDITIONAL INFORMATION REQUEST

Date: 05/05/25

Application Number: HDC2025-00172

APPLICANT & PROPERTY INFORMATION

NAME: Anthony A King

COMPANY NAME: Anthony A king

ADDRESS: 13204 Broadstreet Ave

CITY: Detroit

STATE: CA

ZIP: 48238

PROJECT ADDRESS: 4000 Cortland

HISTORIC DISTRICT: Russell Woods-Sullivan

REQUESTED INFORMATION

We have received your application, but it is not yet complete for review. Please provide additional details based on the comments and questions listed below. Should you need to attach additional files per this request, use the paperclip icons at the end of this form. You may attach up to (5) files per icon up to 25MB:

This application is not complete, and staff understands you have additional information/drawings to submit for review. Thank you!

Please provide the following:

- Product information with the specific material, design, and paint color of the proposed new siding (screenshot of product information is OK, but website links are not)
- Product information with the specific material, design, and color of the proposed replacement screens (screenshot of product information is OK, but website links are not) — if it will be handmade screen frames, please described the specific material, design, and color of the proposed replacement screens
- The style/type of gutters
- Photo of house with location call outs of the downspouts proposed locations
- Confirmation that the project scope does not include the eaves (including soffits or fascia)

PSR: 250505AD

APPLICANT RESPONSE

Response Date: 05/13/2025



Again, the details of the materials to be used are what is currently there. The rotten 2x4 will be replaced by new ones.

The replacement for the siding will be new T11 boards that replaced the rotted ones.

The white paint will be a White Sherwin Williams outdoor paint as the last structure was painted white.

The diagram below will take the two very large screened area and make the three equal sized ones so that the structure is smaller so that the chances of falling through are less. It's more of a safety concern to make the openings smaller.

Gutters

Again, all of these details have been provided. The are replacement gutters to be placed into the same location that they are currently. The will be new aluminum ones to replace the old ones with rusted openings which are not affective.

The will be black in color and all ornate pieces will be placed back into position as there were.

5" K style Residential gap is .27

All downspouts are commercial 3x4 gap 0.32

The gutter install is very familiar with historic and has done many homes in the area.

The past pictures have been send which outlines where the old gutters are placed.

Thank you

A King

Street

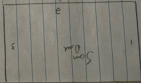

125' 94' 79' 100'

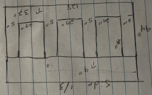

133' 94' 79' 100' Street side 1/3 2 Square foot ground w/wood 25/49

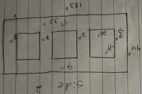

133' 94' 79' 100' Side 2



