

**KEYED NOTES:**

- ① EXISTING EVERGREEN TREES ALONG EDGE OF PROPERTY LINE TO REMAIN
- ② EXISTING DECORATIVE WROUGHT IRON METAL FENCE TO REMAIN
- ③ NEW CONCRETE GARAGE PAD
- ④ NEW ARBOR VITAE ALONG EAST PROPERTY LINE / CITY PARK

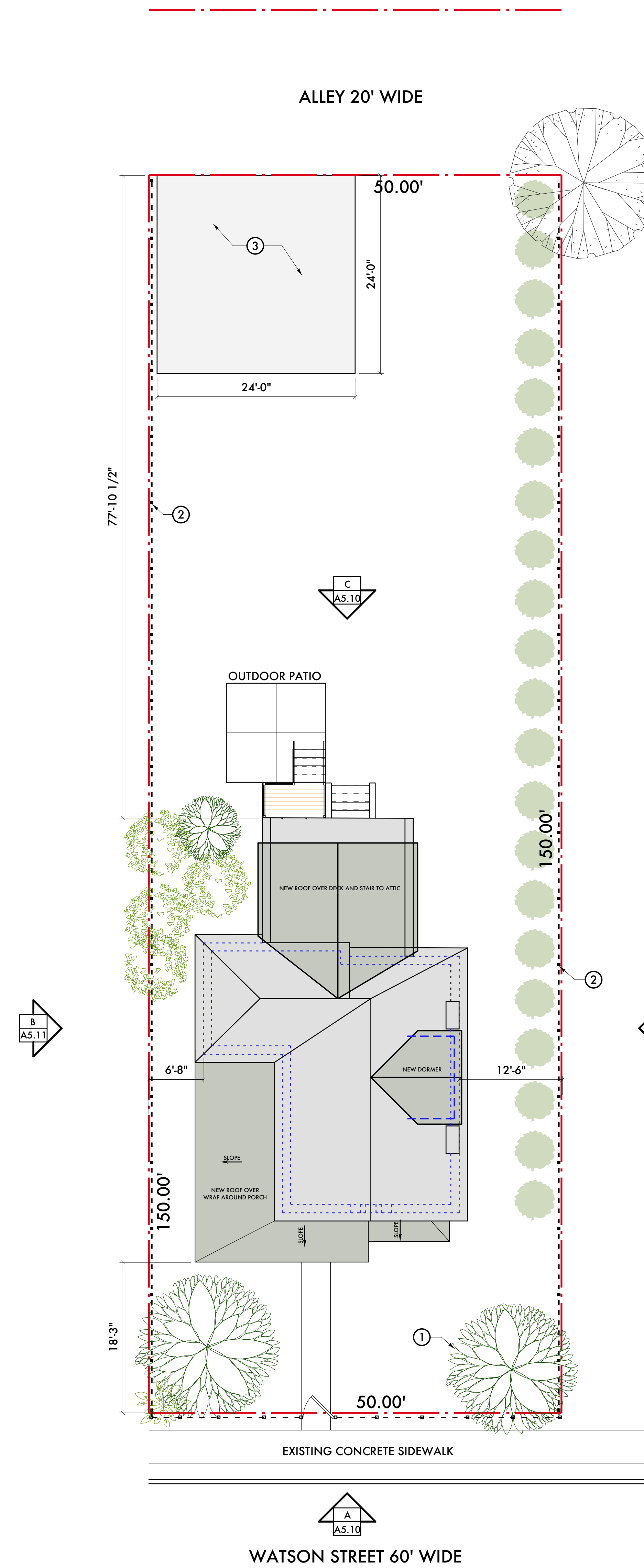

**PROPERTY DESCRIPTION:**

LEGAL DESCRIPTION:  
S WATSON 19BLK 7 BRUSH SUB L2 P25 PLATS,  
WCR 1/43 50 X 150

PROPERTY ID: 01000741

SITE AREA:  
50' WIDE X 150' DEEP = 7,500 SF TOTAL LOT AREA

SITE COVERAGE:  
MAIN HOUSE (EXISTING) = 943 SF  
% COVERAGE (EXISTING) = 8.0%



\_\_\_\_\_

\_\_\_\_\_

\_\_\_\_\_

\_\_\_\_\_

\_\_\_\_\_

\_\_\_\_\_

\_\_\_\_\_

11/20/24 Historic Commission

11/15/24 Historic Commission

Date: Issued For:

**Watson Residence**  
**Historic Home**  
264 E Watson  
Detroit, Michigan 48201

**studiozONE : DETROIT**

architectural  
urban | DESIGN  
interior

350 Madison Avenue  
4th Floor  
Detroit, Michigan 48226

studiozonedetroit.com  
313.549.2790 (p)  
jpb@watsonhome.com

Project Number: 2024

Sheet Title:

**SITE PLAN**

Sheet Number:

**A2.10**

© 2024 studiozONE, llc

**1 SITE PLAN**

1/8" = 1'-0"

