

1459 Edison St, Detroit, MI 48206

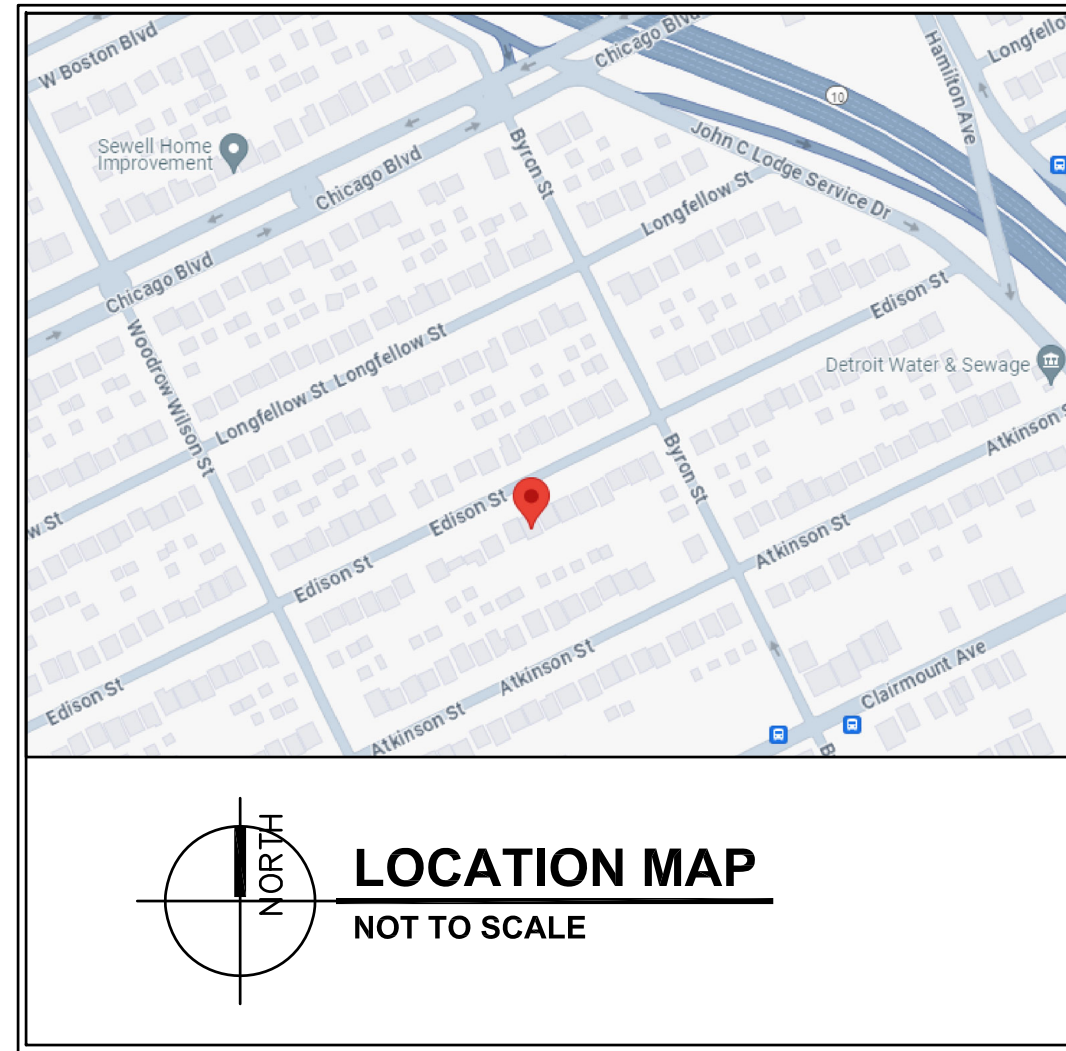

PROJECT DIRECTORY

ARCHITECT:
JEFFREY NICKEL
STUDIO515,LLC
628 E PARENT AVE, SUITE 104
ROYAL OAK, MI 48067
248.207.6579

CONTACT:
RED POINT VENTURES LLC.
STEVEN LUCARELLI
6 PARKLANE BLVD, SUITE 545
DEARBORN, MI 48126
303.669.1747

DRAWING LIST

A0.0- COVER SHEET AND PROJECT INFORMATION

A1.0- PROPOSED DECK PLANS, PROPOSED DECK STRUCTURAL FRAMING PLANS AND PROPOSED DECK ELEVATIONS

A2.0- PROPOSED DECK SECTIONS 1, 2 AND DECK LEDGER DETAILS



GENERAL NOTES

- ALL WORK SHALL BE DONE IN ACCORDANCE WITH ALL LOCAL AND STATE CODE AND ORDINANCE (MICHIGAN RESIDENTIAL CODE 2015)
- THE G.C. IS REQUIRED TO FAMILIARIZE HIM / HER SELF WITH THE ENTIRE SET OF CONSTRUCTION DOCUMENTS AND ALL OF THE CONSTRUCTION DETAILS AND METHODOLOGIES PRESENTED PRIOR TO CONSTRUCTION. ANY QUESTIONS AND CONCERNS WILL BE DOCUMENTED AND PRESENTED IN A PRE-CONSTRUCTION MEETING.
- THE G.C. IS RESPONSIBLE TO SET UP AND ATTEND A PRE-CONSTRUCTION MEETING WITH THE ARCHITECT AND HOME OWNER TO COVER ALL QUESTIONS, CONCERNS, POTENTIAL DISCREPANCIES AND ALTERNATES.
- IN EVENT OF ANY DISCREPANCY IN THESE DOCUMENTS, THE CONTRACTOR IS TO STOP WORK IMMEDIATELY AND NOTIFY THE ARCHITECT.
- THE ARCHITECT ASSUMES NO RESPONSIBILITY FOR ANY CHANGE ORDERS OR ADDENDUMS RESULTING FROM CHANGE OF MIND, ERRORS, OMISSIONS, OR DISCREPANCIES CAUSING ADDITIONAL WORK BY THE CONTRACTOR WITHOUT PROPER NOTIFICATION IN COMPLETE COMPLIANCE WITH THESE DOCUMENTS AND PRIOR WRITTEN CONSENT BY THE ARCHITECT.
- THE ARCHITECT ASSUMES NO RESPONSIBILITY FOR THE ACCURACY AND PROPER ASSEMBLY OF THE STRUCTURE WITHOUT VERIFYING ALL AS-BUILT CONSTRUCTION MEASUREMENTS. THE STRUCTURE MUST MATCH EXACTLY TO THE PROPOSED DRAWING DIMENSIONS. ANY NECESSARY ADJUSTMENTS OR COORDINATION TO THE STRUCTURE TO DUE DISCREPANCIES IN THE AS-BUILT CONSTRUCTION SHALL BE THE RESPONSIBILITY OF THE SELECTED GENERAL CONTRACTOR.
- THE ARCHITECT WILL NOT BE RESPONSIBLE FOR PROVIDING ANY INFORMATION REGARDING EXISTING OR PROPOSED HVAC, PLUMBING OR ELECTRICAL SYSTEMS OR ENGINEERING. ALL PROPOSED SYSTEMS TO BE COORDINATED WITH THE ARCHITECT.

STRUCTURAL NOTES

CONCRETE

- MINIMUM CONCRETE STRENGTH TO BE 4000 P.S.I. @ 28 DAYS, U.N.O. ; WITH 6% + 1% ENTRAINED, U.N.O., WHERE EXPOSED.
- ALL CONCRETE WORK AND PLACEMENT SHALL CONFORM TO THE LATEST RECOMMENDATIONS OF A.C.I. 3" CONCRETE FOR PATCHING EXISTING SLABS SHALL BE EPOXY BASED HIGH STRENGTH (MIN. 4000 P.S.I.) CONTRACTOR TO SUBMIT PRODUCT DATA FOR REVIEW.

MASONRY

- ALL MASONRY WORK IS TO BE IN ACCORDANCE WITH THE LATEST BUILDING CODE REQUIREMENTS FOR MASONRY STRUCTURES [A.C.I. 530/ASCE 5] AND SPECIFICATIONS FOR MASONRY STRUCTURES [A.C.I. 530.1/ASCE 6] AND N.C.M.A.
- MORTAR SHALL BE TYPE "S" (1800 P.S.I.) CONFORMING TO ASTM C-270, U.N.O. TYPE "N" MORTAR SHALL BE USED FOR TUCK POINTING TO BRICK.
- ALL EXISTING JOINTS REQUIRING TUCK POINTING SHALL BE CUT BACK TO A DEPTH OF 1/2" MINIMUM.
- PRIOR TO TUCK POINTING, ALL MORTAR JOINTS SHALL BE THOROUGHLY BRUSHED OUT REMOVING ALL DUST AND DIRT.
- PREMOISTEN JOINT STRUCTURE AND WHILE THE SURFACE IS STILL DAMP, THE JOINT SHALL BE TUCK POINTED USING A MIXTURE AS SPECIFIED.
- ALL MORTAR SHALL BE PRESSED INTO THE PREPARED JOINT STRUCTURE UNTIL THE JOINT IS PACKED FULL IN MAXIMUM 1/4" LAYERS. JOINT SHAPE SHALL MATCH EXISTING.
- ALL CRACKED AND BROKEN UNITS SHALL BE REMOVED AND REPLACED, WITH NEW JOINTS STRUCK TO MATCH EXISTING.

SHORING

- ALL SHORING SHALL BE PERFORMED BY EXPERIENCED CONTRACTORS.
- SHORE ALL AREAS PRIOR TO REMOVAL OF ANY STRUCTURAL SUPPORT TO INSURE STRUCTURAL INTEGRITY.
- MAINTAIN SHORING UNTIL NEW PERMANENT STRUCTURE IS IN PLACE AND SECURE TO MAINTAIN STRUCTURAL INTEGRITY.
- REMOVE SHORING AFTER NEW WORK IS IN PLACE AND CONNECTED.

WOOD

- WOOD CONSTRUCTION SHALL BE PER AMERICAN INSTITUTE OF TIMBER CONSTRUCTION (AITC) STANDARDS AND SPECIFICATIONS, AND NATIONAL DESIGN SPECIFICATION FOR WOOD CONSTRUCTION (NDS) AS PUBLISHED BY NATIONAL FOREST PRODUCTS ASSOCIATION.
- ALL LUMBER FRAMING MEMBERS ARE TO HAVE THE FOLLOWING MINIMUM BASE DESIGN VALUES IN ACCORDANCE WITH THE LATEST ISSUE OF THE NATIONAL DESIGN SPECIFICATION FOR WOOD CONSTRUCTION (NDS) AS PUBLISHED BY THE NATIONAL FOREST PRODUCTS ASSOCIATION (NAPA):
Fb = 850 P.S.I.
Fv = 75 P.S.I.
E = 1,200,000
NO. 2 OR BETTER
- PROVIDE DOUBLE STUD AT EACH END OF WOOD HEADERS, TYPICAL, UNLESS NOTED OTHERWISE.
- ALL LAMINATED VENEER LUMBER (L.V.L.) TO HAVE THE FOLLOWING MINIMUM DESIGN PROPERTIES BASED ON AITC GRADING STANDARDS :
Fb = 2800 P.S.I.
Fv = 285 P.S.I.
E = 1,800,000
- UNLESS OTHERWISE NOTED, PROVIDE (2) 2 x 8 HEADER FOR OPENINGS IN STUD WALLS FOR SPANS UP TO 3'-0" MAXIMUM.

STUDIO515,LLC

628 E. PARENT AVE.
SUITE 104
ROYAL OAK, MI 48067
(P)248.207.6579

3D VISUALIZATION
DESIGN
DOCUMENTATION

Private Residence

1459 Edison St,
Detroit, MI 48206

SHEET NAME:
COVER SHEET
PROJECT INFORMATION

ISSUE:	HRC SUBMITTAL
DATE:	06.12.2024

SHEET

A0.0

DATE:	05.31.2024
REVIEW:	06.12.2024
ISSUE:	HRC SUBMITTAL

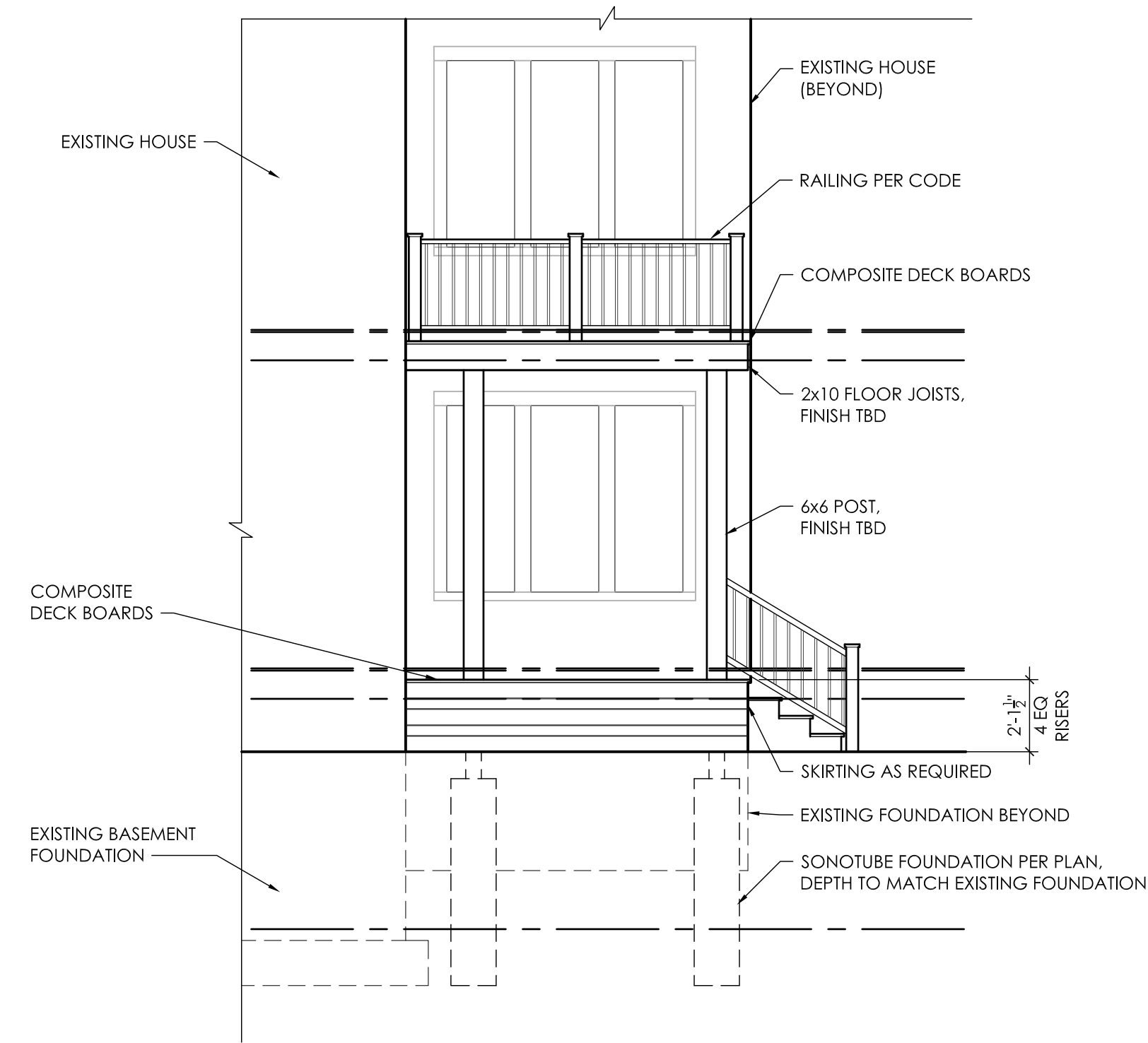

7 PROPOSED SIDE DECK ELEVATION
 A1.0 1/4" = 1'-0"

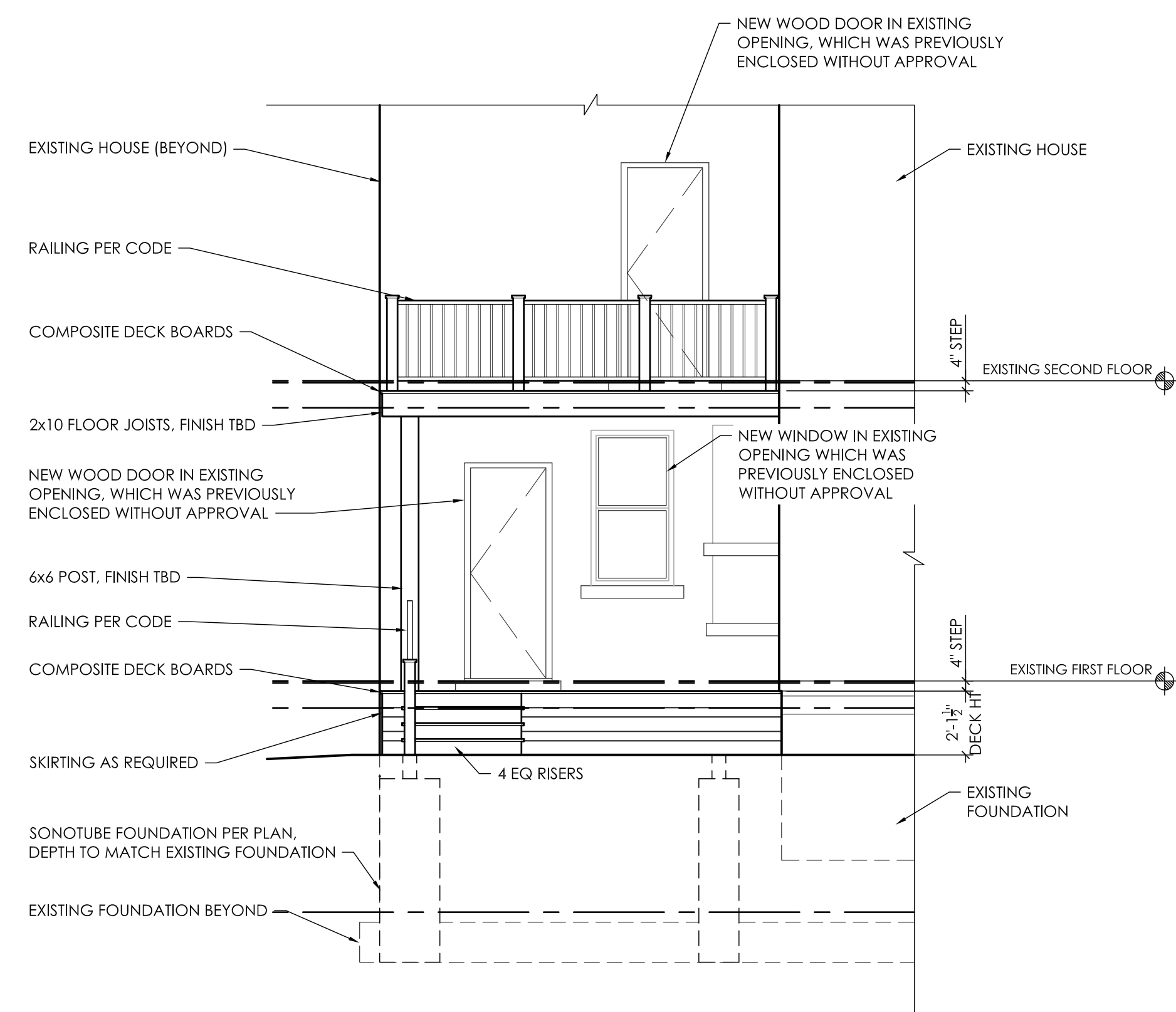

6 PROPOSED REAR DECK ELEVATION
 A1.0 1/4" = 1'-0"

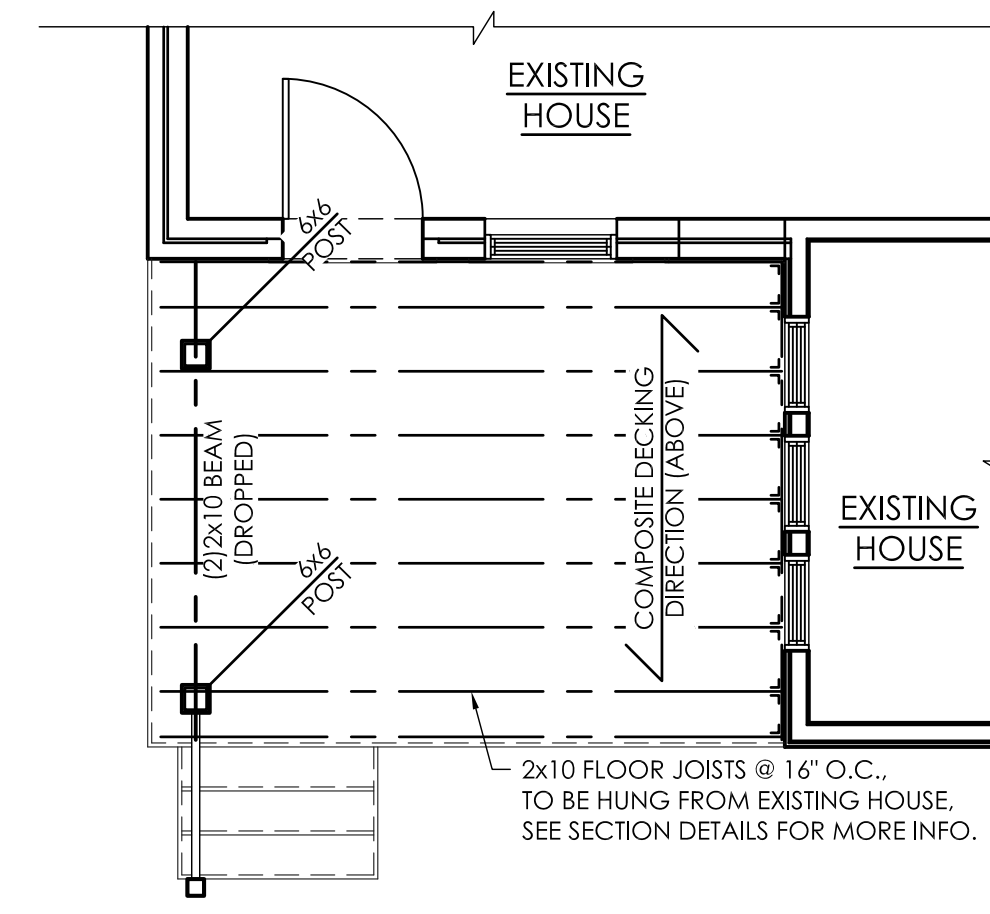

5 PROPOSED SECOND LEVEL DECK FRAMING PLAN
 A1.0 1/4" = 1'-0"

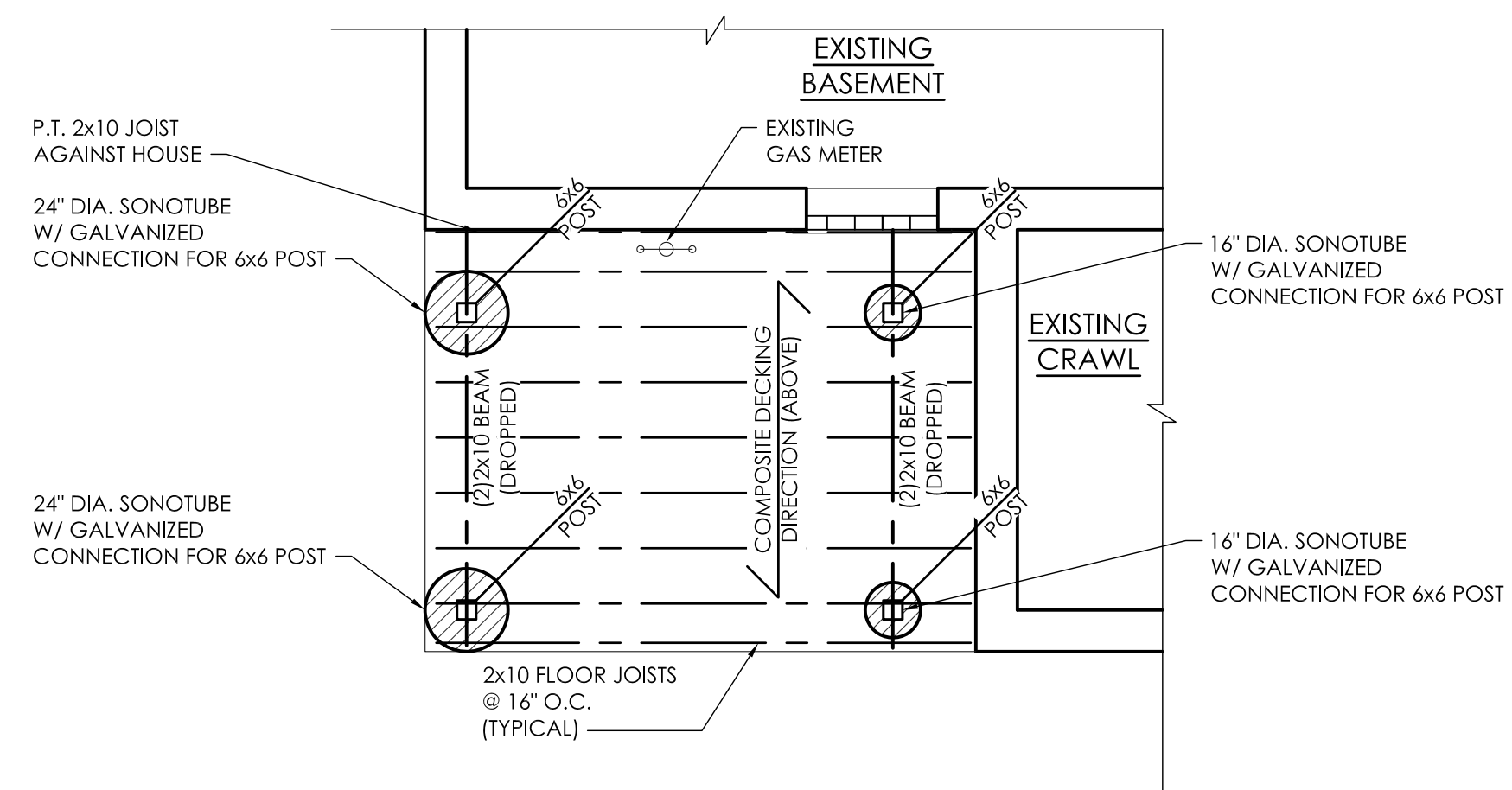

4 PROPOSED FIRST LEVEL DECK FRAMING PLAN
 A1.0 1/4" = 1'-0"

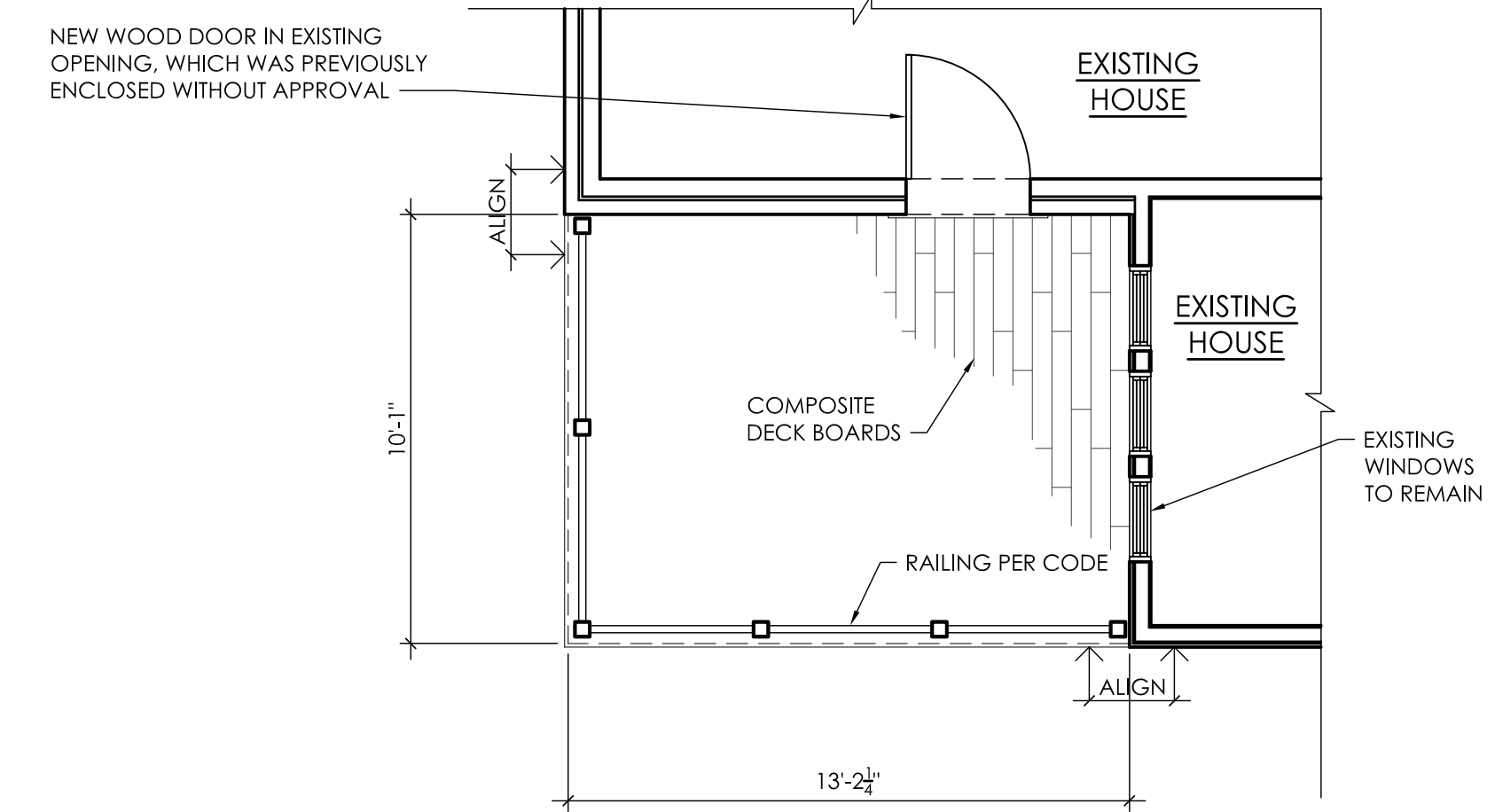

3 PROPOSED SECOND LEVEL DECK PLAN
 A1.0 1/4" = 1'-0"

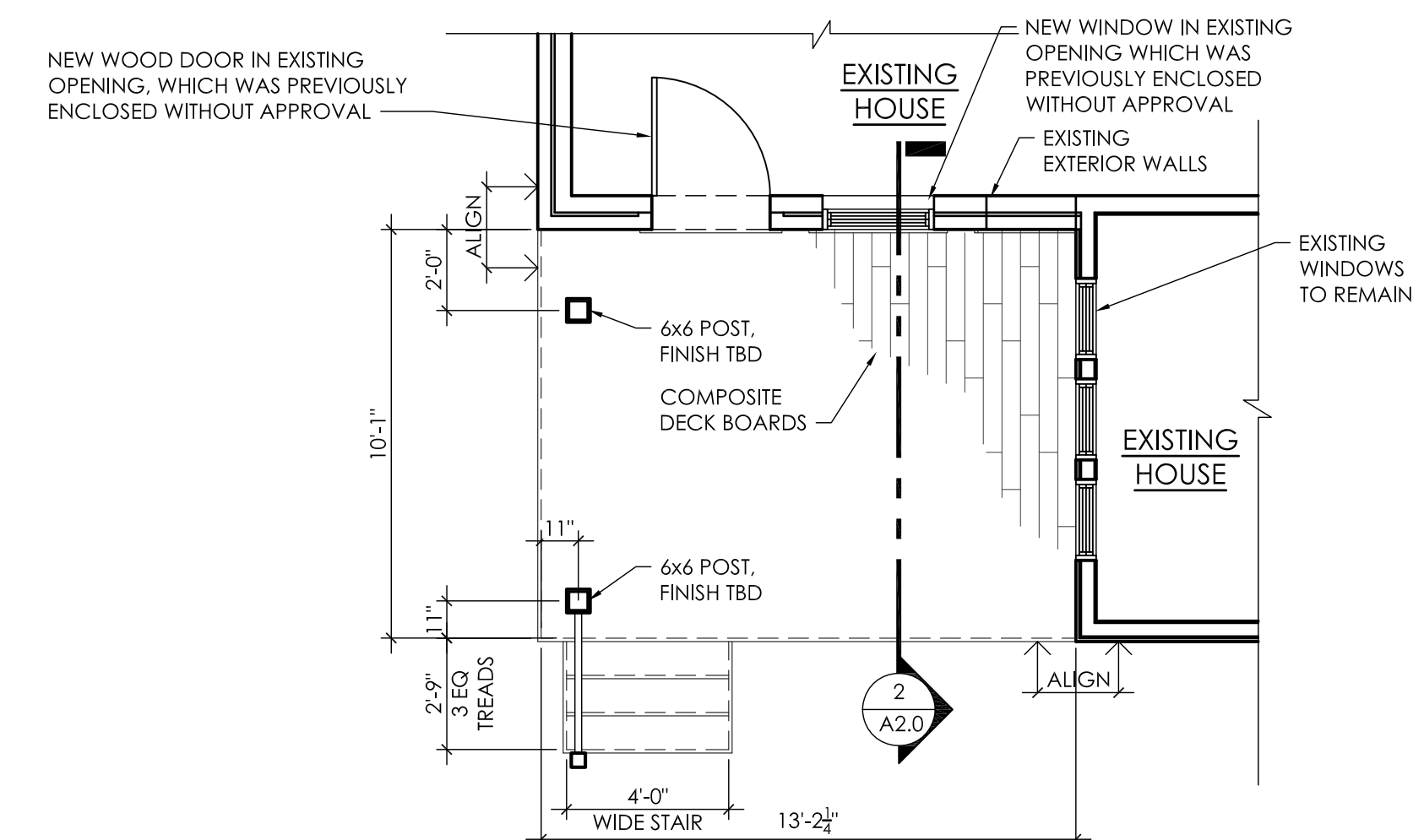

2 PROPOSED FIRST LEVEL DECK PLAN
 A1.0 1/4" = 1'-0"

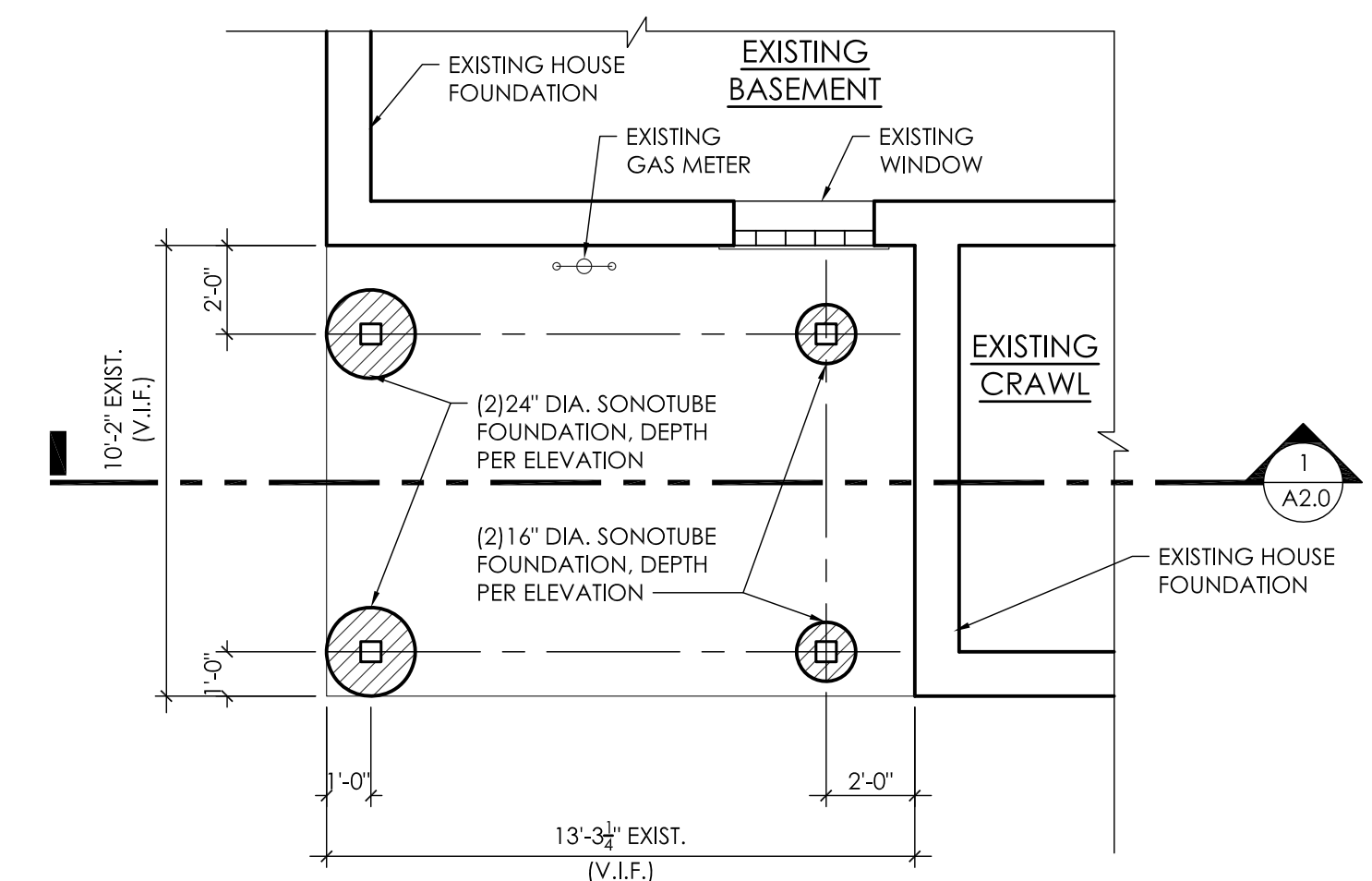

1 PROPOSED DECK FOUNDATION PLAN
 A1.0 1/4" = 1'-0"

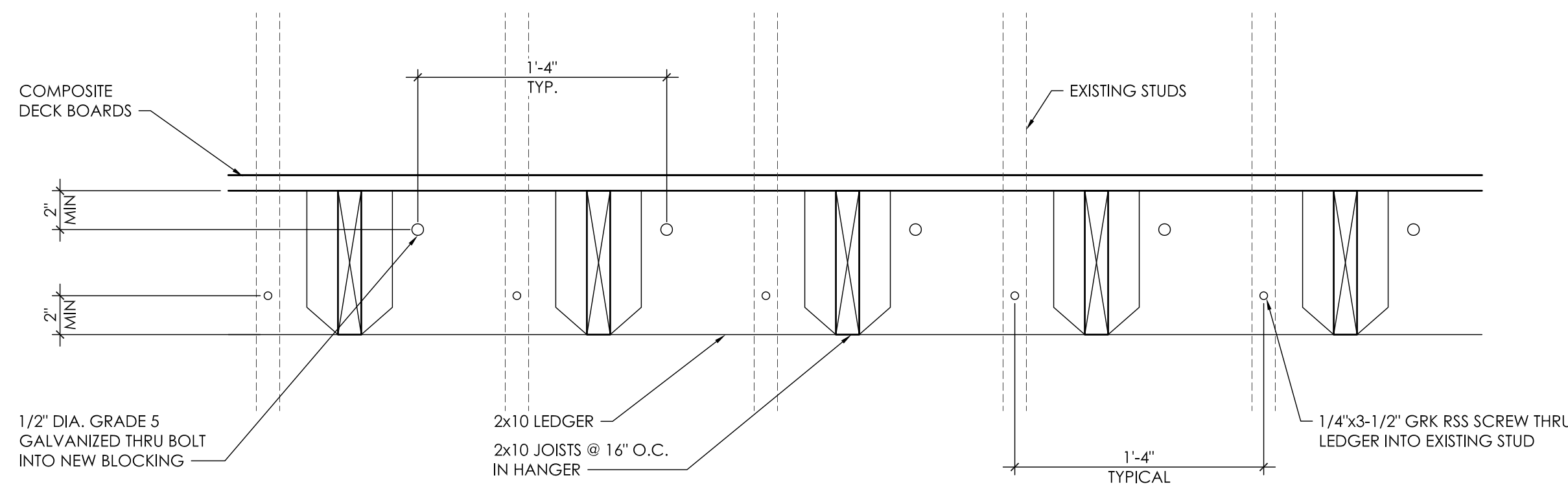

4 DECK LEDGER DETAIL - 2
A2.0 1-1/2" = 1'-0"

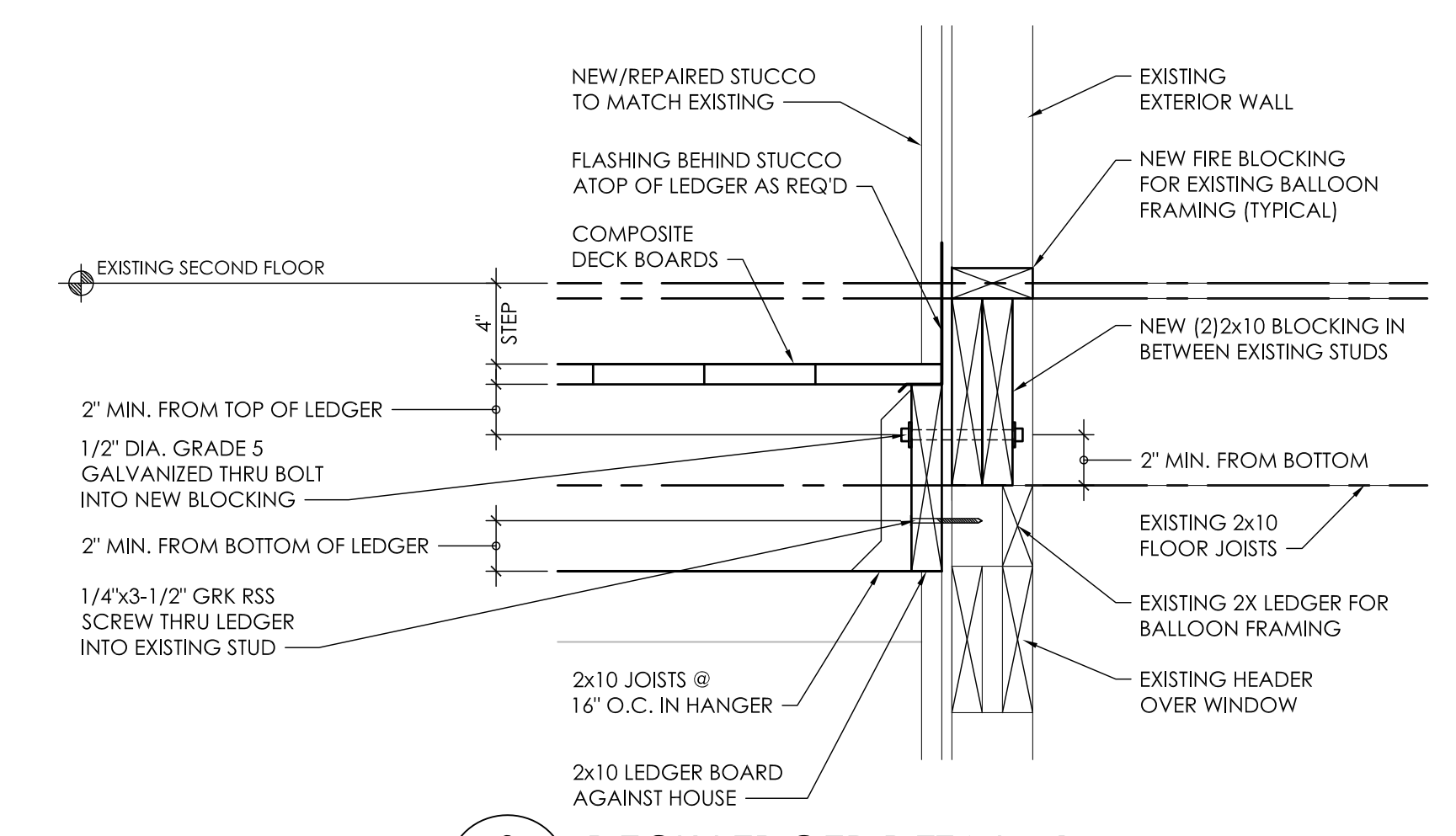

3 DECK LEDGER DETAIL - 1
A2.0 1-1/2" = 1'-0"

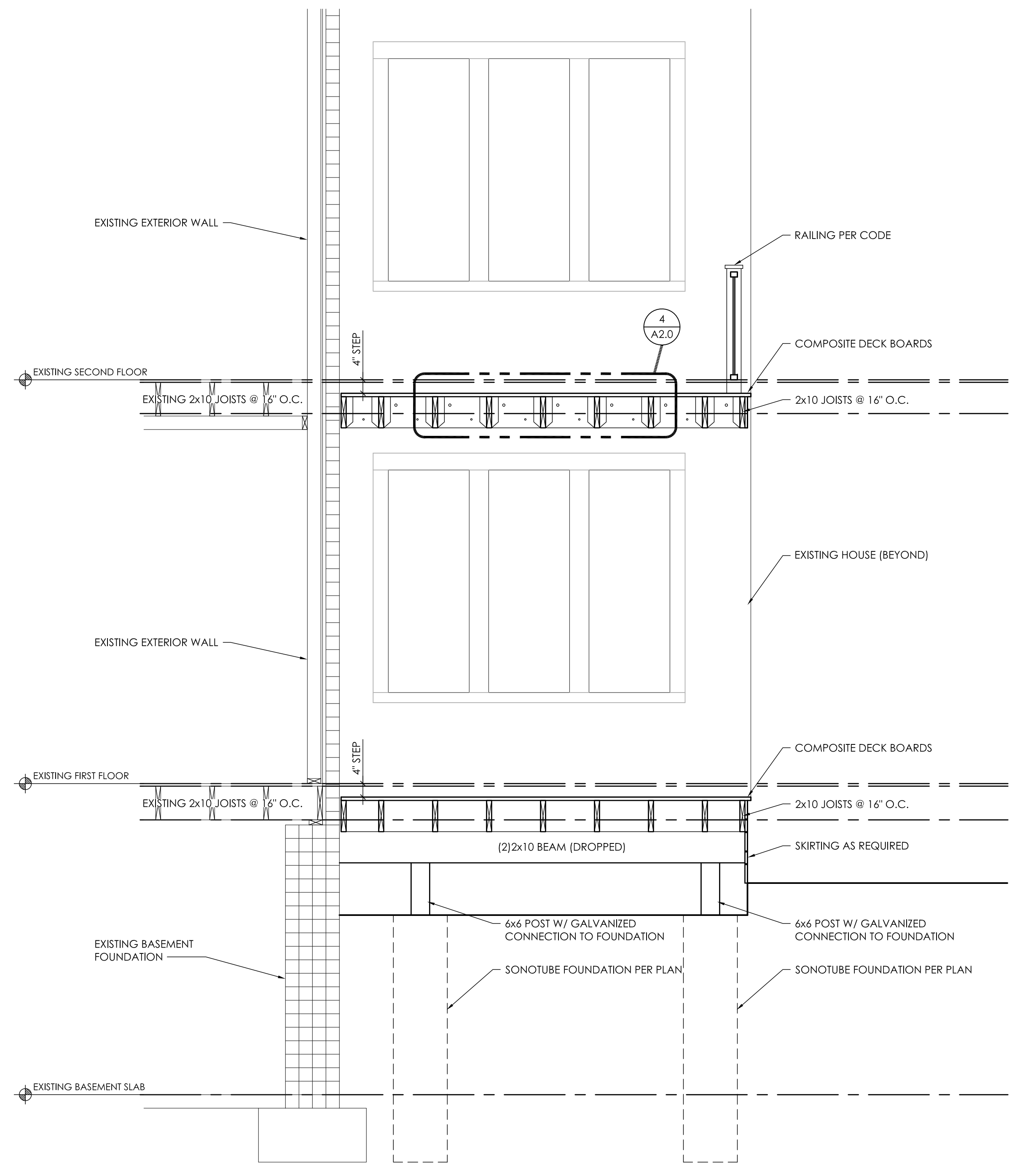

2 PROPOSED DECK SECTION 2
A2.0 1/4" = 1'-0"

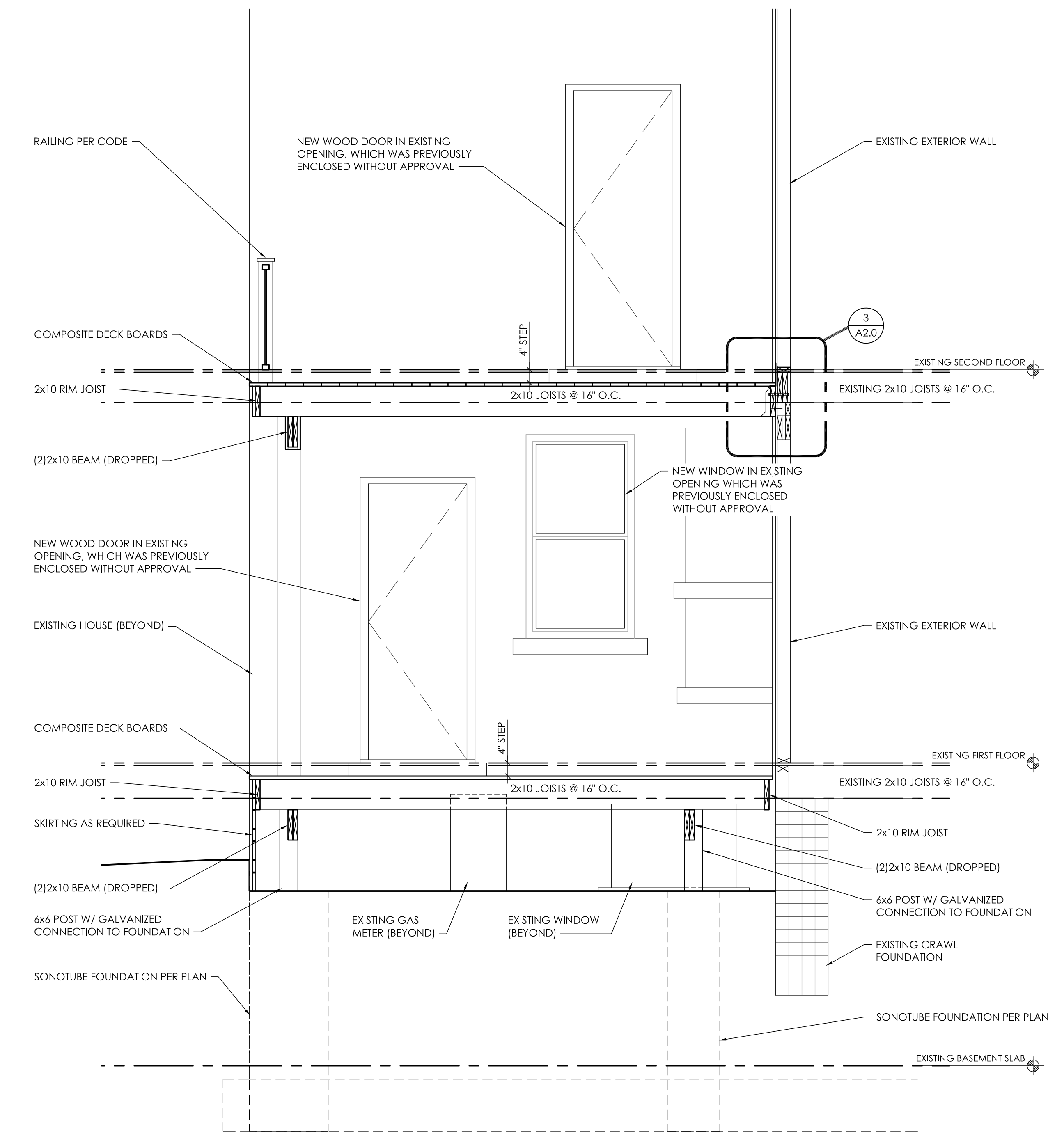

1 PROPOSED DECK SECTION 1
A2.0 1/4" = 1'-0"

DATE:	05.31.2024
REVIEW:	06.12.2024
HRC SUBMITTAL	