

4500 Series Storefront Framing

Our 4500 Series Storefront framing is ideal for a wide variety of interior or low-rise exterior applications. Profiles of 1-3/4" x 4-1/2" are designed for 1/4" to 3/8" exterior glazing, and can be assembled by screw spline or clip joinery. The roll-in gasket is easy to install at the interior and exterior of the glass. The 1-3/4" framing is compatible with Tubelite Narrow, Medium and Wide Stile Doors.

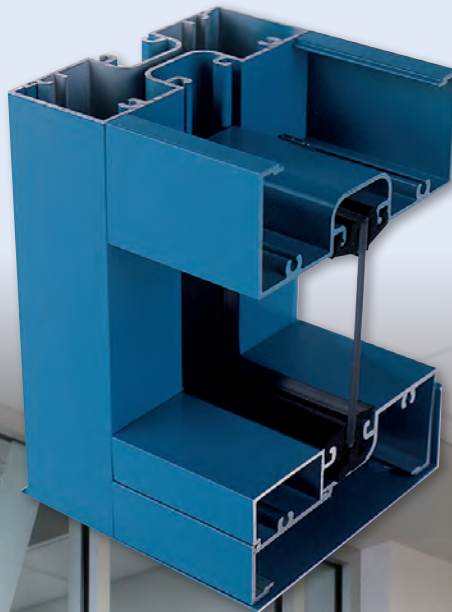

Standard Medium Stile Entrances



200 Series Curtainwall

ALSO
USED
WITH

TUBELITE[®]
DEPENDABLE

LEADERS IN ECO-EFFICIENT STOREFRONT,
CURTAINWALL AND ENTRANCE SYSTEMS

4500 Series Storefront Framing

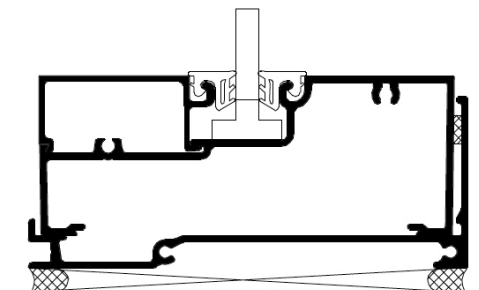
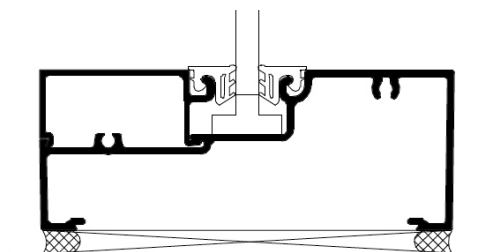
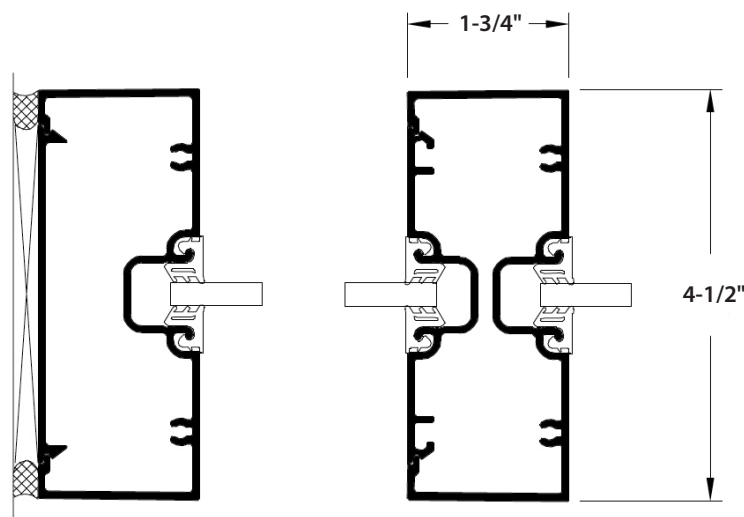

System Features:

- Standard 1 3/4" (44.5mm) sight-line on verticals and horizontals
- 4-1/2" (114.3mm) system depth
- EPDM wedge type gaskets for 1" glass or panel thickness
- Glass centered in the system depth

Optional Features:

- Screw-spline or shear block connections
- Steel reinforcing if required
- Easily integrates with standard doors & operable vent windows
- A wide variety of standard anodized and painted colors are available to complement any project with warranted protection, as well as street appeal.

4500 Series Product Specifications

Application: Low and mid-rise commercial buildings including retail, office, healthcare, schools, etc.

Description: 1-3/4" x 4-1/2" center set, screw spline or shear block construction non thermal storefront field glazed, shear block construction storefront.

Face Width:	Overall Depths:	Glass:	Air Infiltration:	Water Infiltration:	Structural:	Acoustic:
1-3/4"	4-1/2"	1/4" std. (3/16" to 3/8")	0.06 CFM/Ft.2 @ 6.24 PSF	12 PSF - Static 12 PSF - Dynamic	30 PSF - Design 45 PSF - Overload	28 STC 27 OITC

DISCLAIMER: Tubelite takes no responsibility for product selection or application, including, but not limited to, compliance with building codes, safety codes, laws, merchantability or fitness for a particular purpose; and further disclaims all liability for the use, in whole or in part, of this Technical Guide in preparation of project specifications and/or other documents. Technical Guides are subject to change at any time, without notice, and at Tubelite's sole discretion. ©2020 Tubelite Inc.

072920

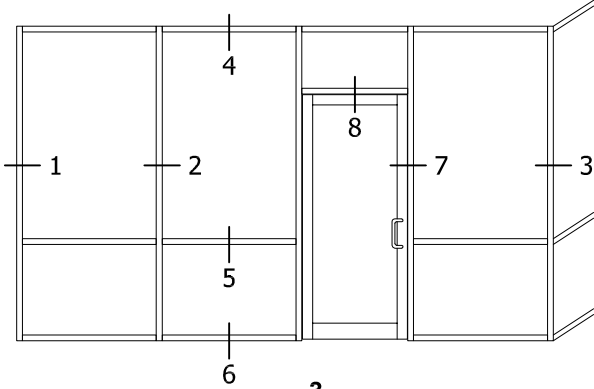

Tubelite reserves the right to change system configuration without prior notice when deemed necessary for product improvements.

Laws and building & safety codes governing the design and use of glazed entrance, window and curtain wall systems vary widely. Tubelite does not control the selection of product configurations, operating hardware or glazing materials, and assumes no responsibility thereof.

Standard Details
1/4 scale

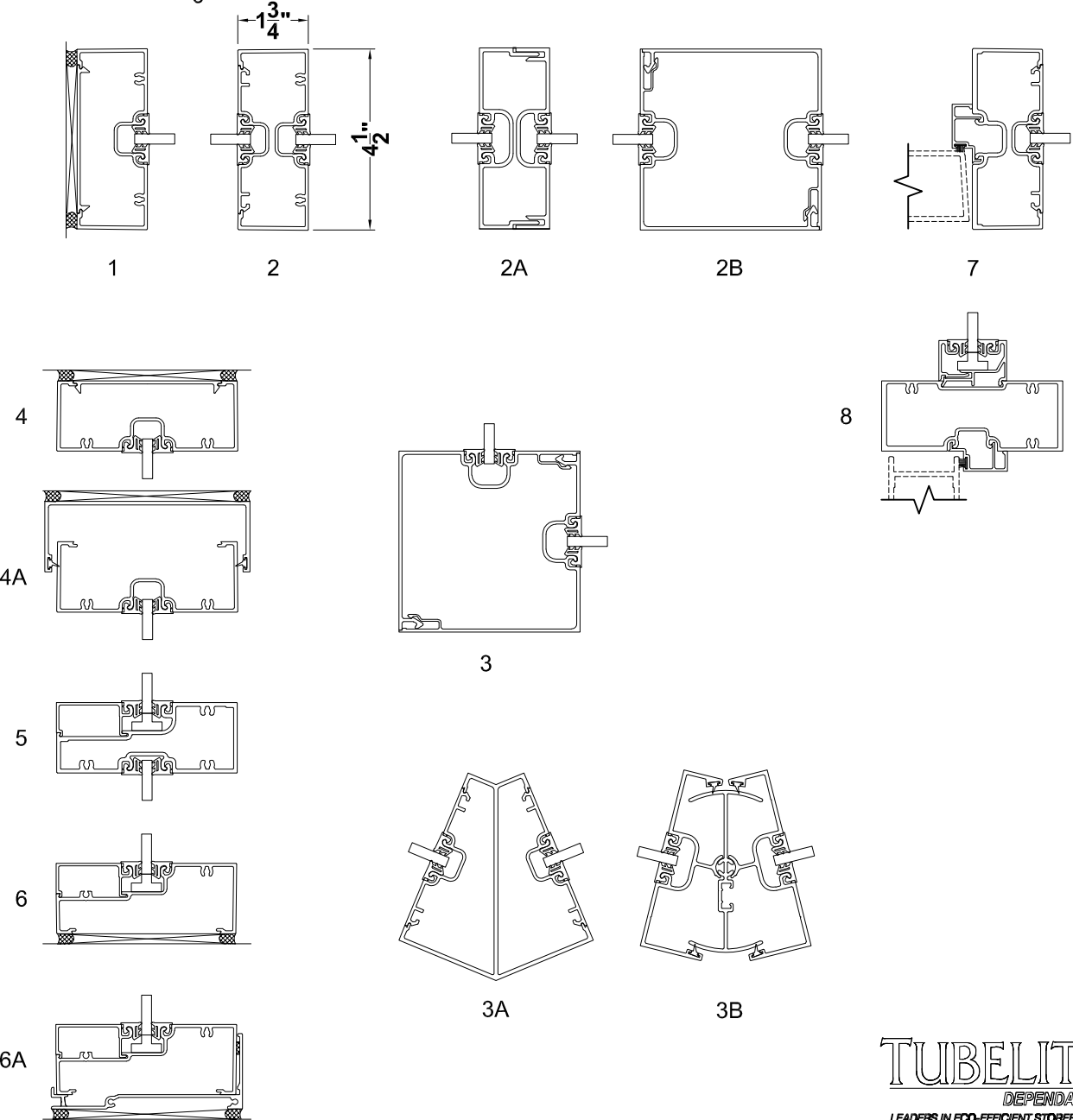

MARCH 2019



For specific product applications, contact your Tubelite representative.
Details on this page represent standard details found on our website.
For more options, visit our website at www.tubeliteinc.com/4500-series-storefront-framing/