

Allowable Heights:

6' side lot lines, at the front face of the house

8' rear property line

3' front yard -- applies only to corner lots on the side of the public right of way, otherwise front yard fencing is not allowed

Allowable Colors:

The most common colors for historic fencing are: black, white, green, brown

Optionally, the color of the fence could be a color complimenting the colors of the house and comparable to the colors found in the Detroit Historic Districts Style and Color Guide systems A through F (as available from the Historic District Commission Staff).

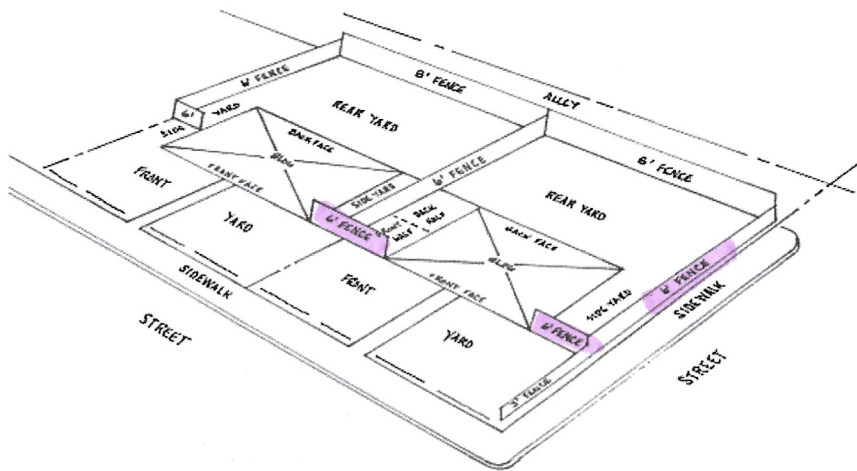

Variations

The Detroit Historic District Commission may allow variance to the previously stated guidelines if the Commission views such variance as beneficial to the overall appropriateness of a fencing proposal.

The Historic District Commission reserves all rights to amend or update this guideline or to deny the use of certain fencing if they are deemed inappropriate in any specific location.

Any questions pertaining to this guideline can be directed to the Historic District Commission Staff.









