

# CONCEPT SITE PLAN

## PROPOSED TREE REMOVAL

POTENTIAL TREE TO BE REMOVED

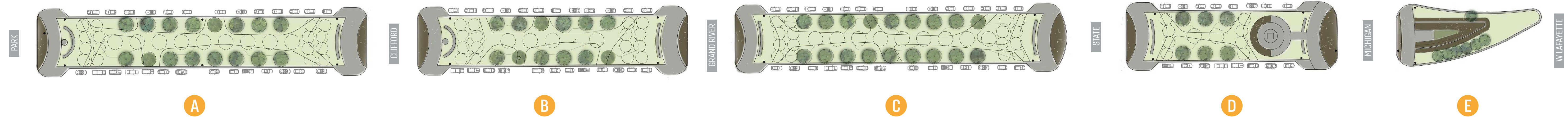

## PROPOSED DESIGN

DECOMPOSED GRANITE  
 ORNAMENTAL GRASSES, GROUNDCOVER & FLOWERING PERENNIALS  
 TURF  
 POTENTIAL TREE TO BE REMOVED

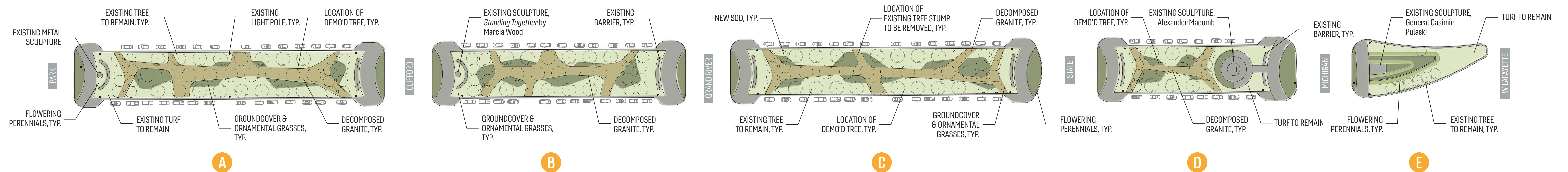

## KEY PLAN

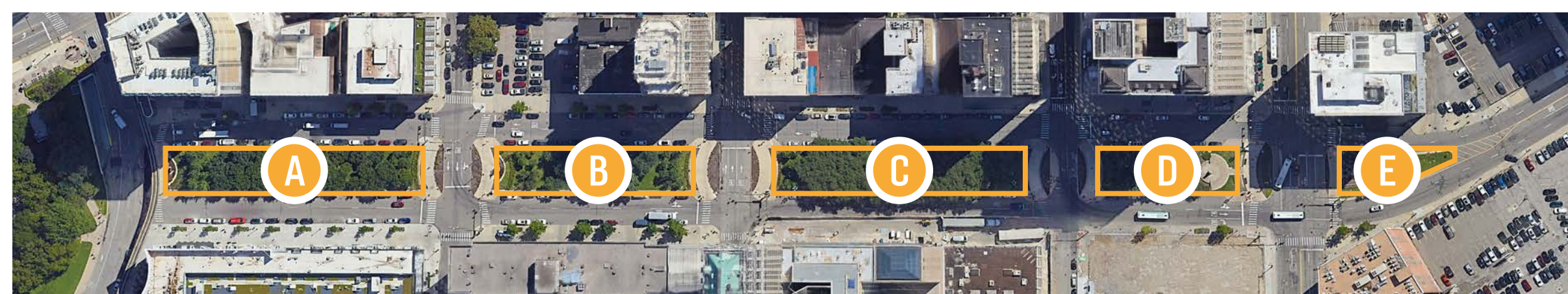

NORTH

### Note:

- The concept plan above is not to scale.
- Additional site elements may be added after further investigation, including path lighting and site furnishings such as benches.
- Tree assessment and removal recommendations were provided by a professional arborist.
- Final site plan to be determined following receipt of site survey and after all project elements have been confirmed and city approvals received.

## TREES

The trees along the medians are a mix of Zelkovas, Elms, Hawthorns, Japanese Lilacs, and Ginkgos. In an effort to increase **VISIBILITY** into the medians and **CONNECTIVITY** down the boulevard, (15) Elms and (9) Zelkovas are proposed for removal from the center of the medians. Also proposed for removal are smaller ornamental trees located at the ends of the medians: (4) Ginkgo trees, (4) Hawthorn trees, and (48) Japanese Lilac trees. Removing these select trees will relieve the medians from being overplanted, provide much needed sunlight to the plants beneath the trees, and prevent overcrowding of tree roots.

The remaining trees will be pruned to remove damaged limbs, encourage strong growth, increase visibility through the median, and improve the overall health of the trees. These measures will ensure **HEALTHY PLANTS AND TREES** for years to come.

Note: The ornamental trees identified for removal are listed under Add. Alternates.

## PLANTINGS

The proposed plantings are a mix of groundcover, ornamental grasses, and flowering perennials. The plants provide a **LUSH MIX OF COLORS AND TEXTURES**, and the proposed species provide habitat for bees and butterflies. Where a steep grade exists, tall steel edging is proposed to prevent erosion and ensure soil and plants will remain in place. All plants in the palette are low maintenance and will thrive in shade and sun.

## PATH

The proposed path will promote **CONNECTIVITY** down and across Washington Boulevard, creating an **INVITING** space that encourages workers, residents, and visitors to engage with Washington Boulevard but not linger.

A decomposed granite path with a stabilizer is proposed along the center of the medians. Decomposed granite is like gravel, but finer and generally more stable. It is formed from the natural weathering and erosion of solid granite and is very durable and low maintenance. Decomposed granite provides a soft path underfoot yet is still an **ACCESSIBLE** surface for wheelchairs and scooters.

Note: The layout of the path and ADA accessibility will be further refined once the survey is complete.

# PLANTING PALETTE & PATH PAVING

PLANTED IN FULL SUN

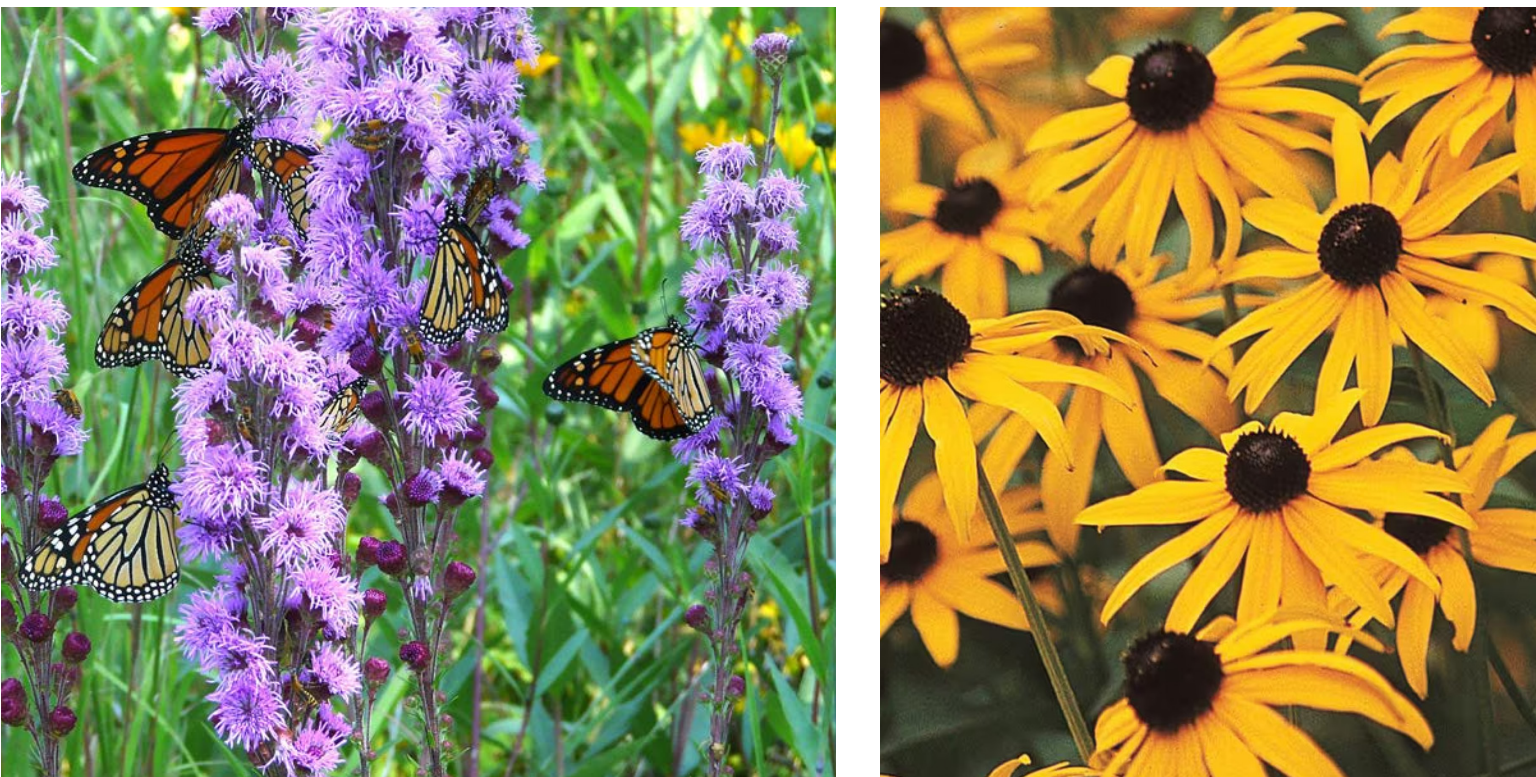

PLANTED IN PARTIAL SUN



PLANTED IN SHADE



PAVING



# CURRENT IMAGES OF THE BOULEVARD



# HISTORIC IMAGERY OF THE BOULEVARD

