



Frame

- Frame is Duracast® fiberglass composite – five-layer pultruded fiberglass material [with optional foam insulation₁] reinforced with a Pella patented interlocking mat.
- Overall frame depth is 3".
- Nominal wall thickness of Duracast fiberglass composite members is .050" to .070" thick.
- Frame corners are mitered, joined and bonded with corner lock and mechanically fastened with injected polyurethane adhesive.
- Sill is fitted with weep valve assemblies.
- Jambs contain factory drilled (counter-bored) installation screw holes. Block and Flush Flange frames only.

Sash

- Sash is Duracast fiberglass composite–five-layer pultruded fiberglass material [with optional foam insulation₁] reinforced with a Pella patented interlocking mat.
- All sash members have mitered corners bonded with corner lock and sealed with injected polyurethane adhesive.

EXTERIOR / INTERIOR

- Duracast fiberglass composite surfaces with powder-coat paint finish.
 - Color is [White] [Brown] [Black].
 - or –
 - Dual-color option [Brown] [Black] exterior with White interior.

Glazing System

- Quality float glass complying with ASTM C 1036.
- 11/16" insulating glass [[annealed] [tempered]] [obscure₃] [clear] [[Advanced] [SunDefense™] [AdvancedComfort] [NaturalSun] Low-E coated, [with argon]] [[bronze] [gray] [green] Advanced Low-E [with Argon]] sealed and bonded to sash.
- High altitude glazing available.

Weatherstripping

- Sash is weatherstripped around the perimeter with a dual fin-type pile weatherstrip.

Hardware

- Galvanized block-and-tackle balances connected to sash with polyester cord and concealed within the frame.
- Lower sash shall be fully operable for ventilation.
- Window jamb has take-out clips to remove vent.
- All fasteners are of a corrosion-resistant material.
- Two locks are installed on units 37" wide or greater.
- Locks are zinc die-cast, self-aligning cam action factory-installed on the interlocker [powder-coat painted [White] [Brown] [Matte Black] to match finish] [Satin Nickel] [Bright Brass] [Oil-Rubbed Bronze].

Foam Insulation Inserts ¹

Single Hung

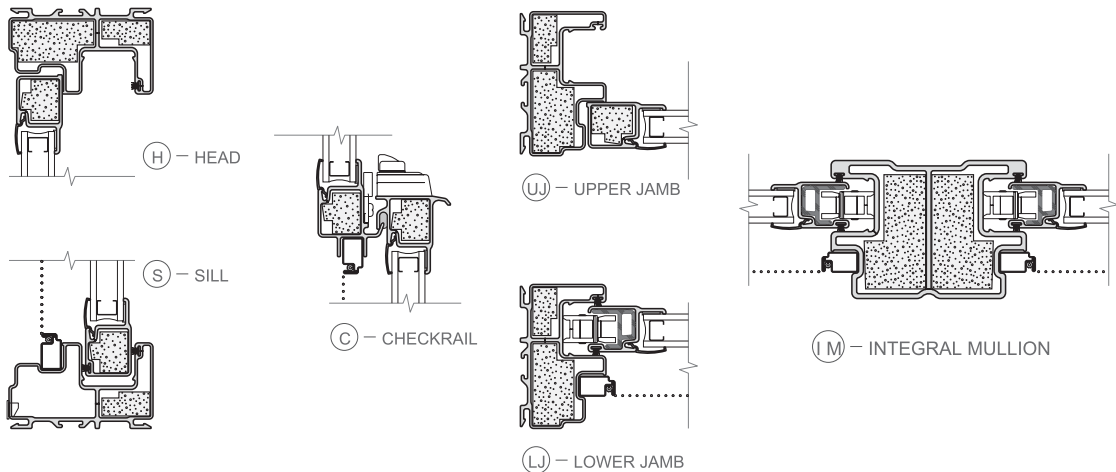

(1) Foam insulation inserts are not available with clear glazing.
 (2) Dual-color finish is not available on products with integral nailing fin.
 (3) Obscure glazing is not available when AdvancedComfort Low-E coated IG is specified.

Optional Products

Screens

- InView™ Screen
 - Half-size with black vinyl coated 18/18 mesh fiberglass screen cloth complying with SMA 1201.
 - Set in aluminum frame and fitted to outside of window.
 - Supplied complete with all necessary hardware.
 - Screen frame finish is baked enamel, color to match exterior.

Grilles

- Grilles-Between-the-Glass
 - Insulating glass contains 3/4" contoured aluminum grilles permanently installed between two panes of glass.
 - Grilles are factory prefinished [White] [Brown] [Black] to match interior and exterior finish.

Hardware

- Optional limited opening device available for field installation on vent units in [White] [Brown] [Black] vinyl to match interior of unit; nominal 3-3/4" opening.
- Optional window opening control device available for field installation. Device allows window to open less than 4" with normal operation, with a release mechanism that allows the sash to open completely. Complies with ASTM F2090-10.
- Optional field applied Duracast sash lift available for vent units in [White] [Brown] [Black].



Impervia® Single-Hung Windows

Frame Types

STANDARD
BLOCK FRAME

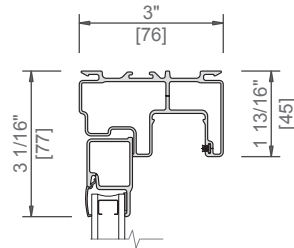

INTEGRAL NAILING FIN

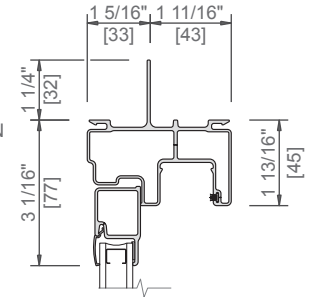

BLOCK FRAME
STANDARD FIN

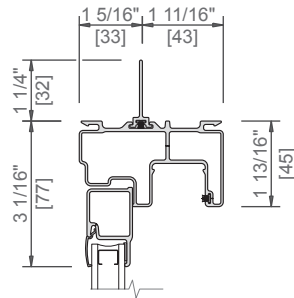

FLUSH FLANGE

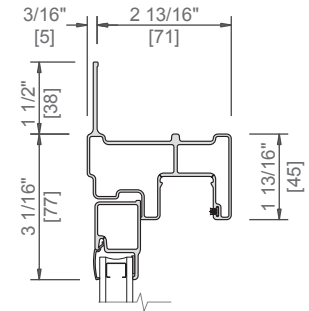

BLOCK FRAME
OFFSET FIN

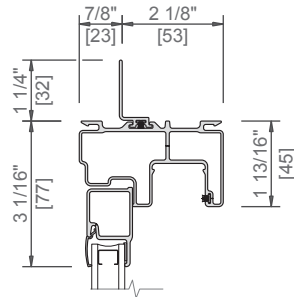

BLOCK FRAME
DP50 SILL DAM

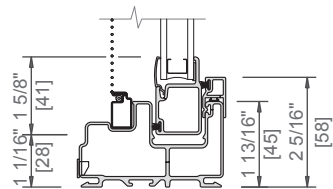

Scale 3" = 1' 0"

All dimensions are approximate.



Impervia® Single-Hung Windows

Unit Sections

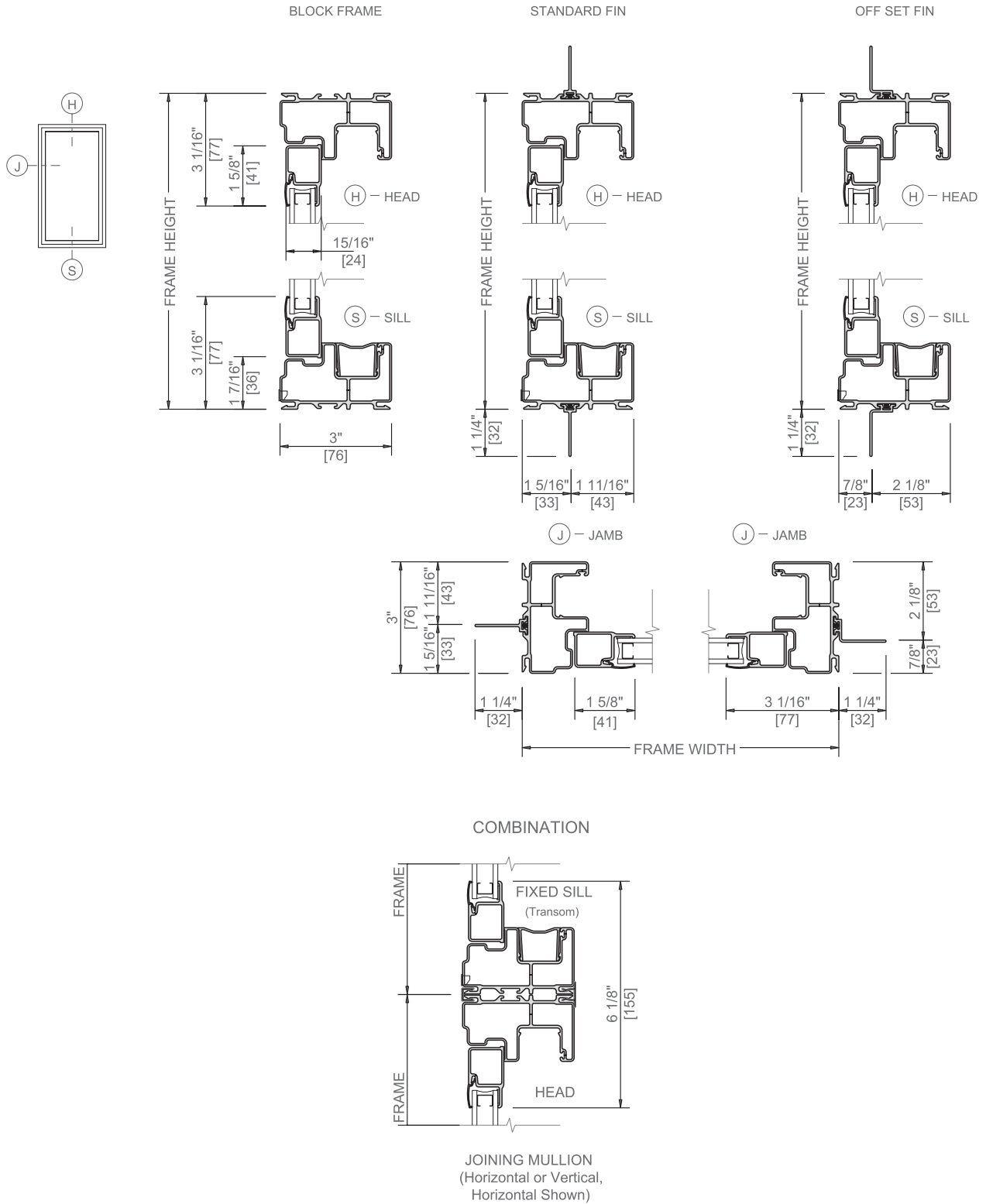

Scale 3" = 1' 0"

All dimensions are approximate.

See Combination section for mullion application and structural limitations.



Impervia® Single-Hung Windows

Unit Sections

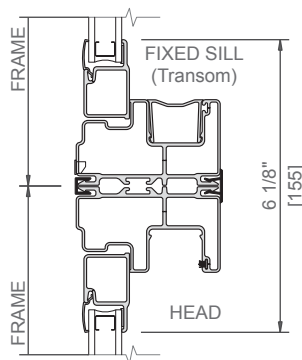
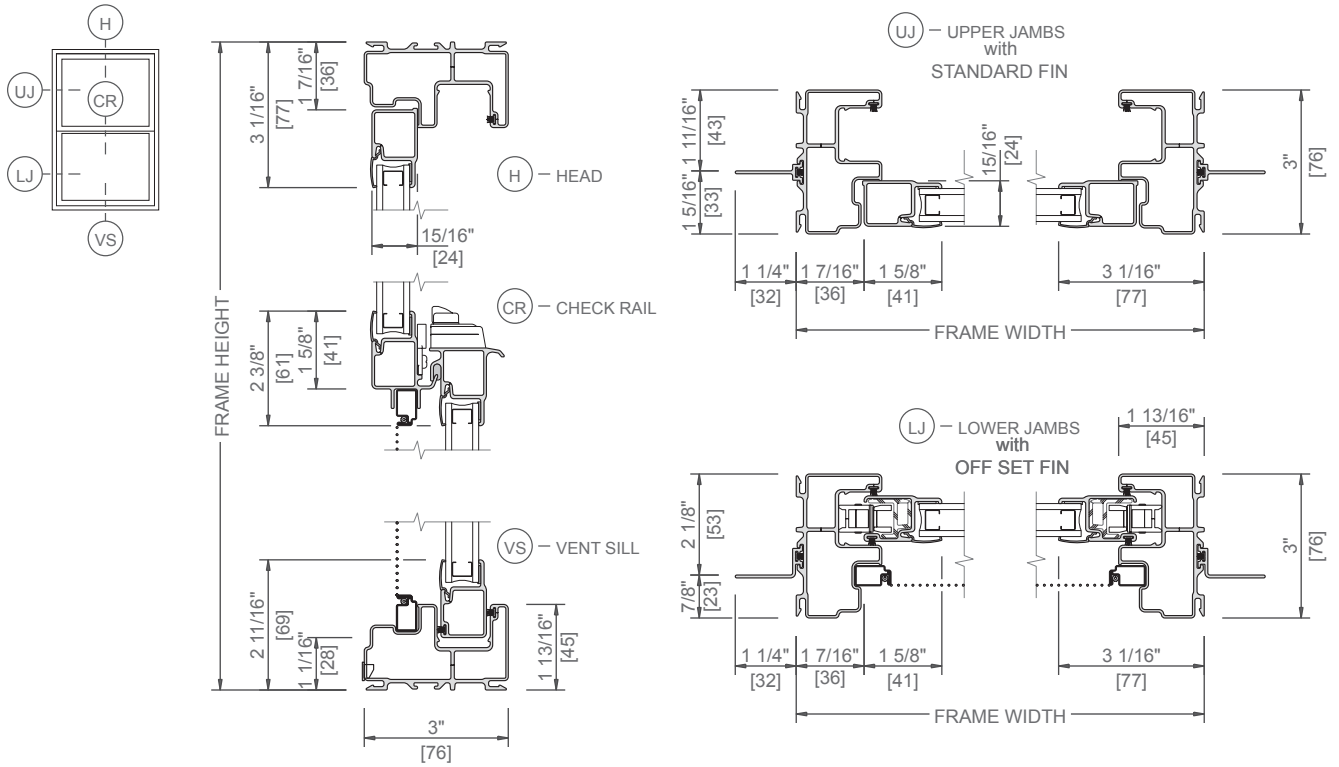

Scale 3" = 1' 0"
All dimensions are approximate.



Impervia® Single-Hung Windows

Unit Sections

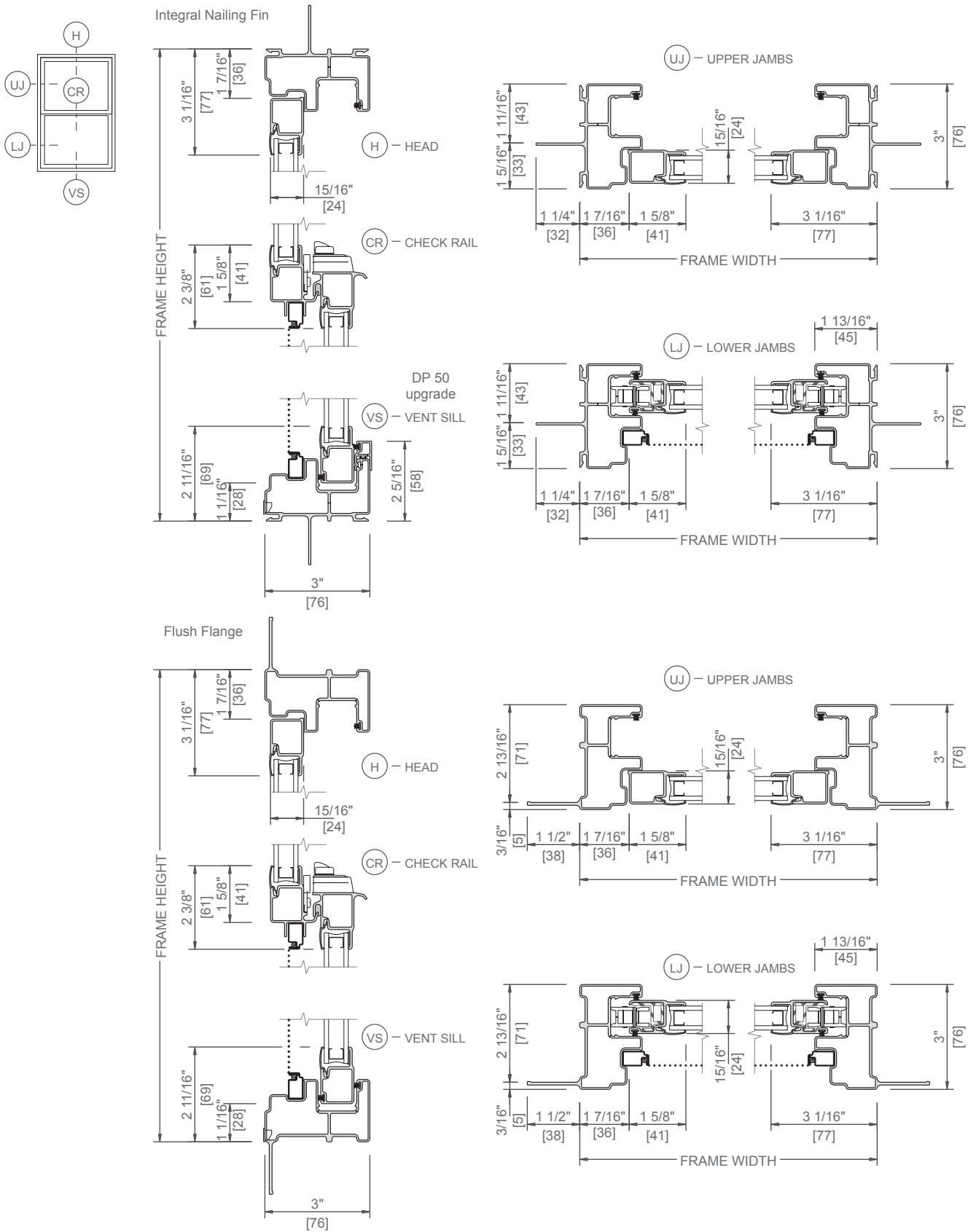

Scale 3" = 1' 0"
All dimensions are approximate.



Impervia® Single-Hung Windows

Unit Sections - Composites

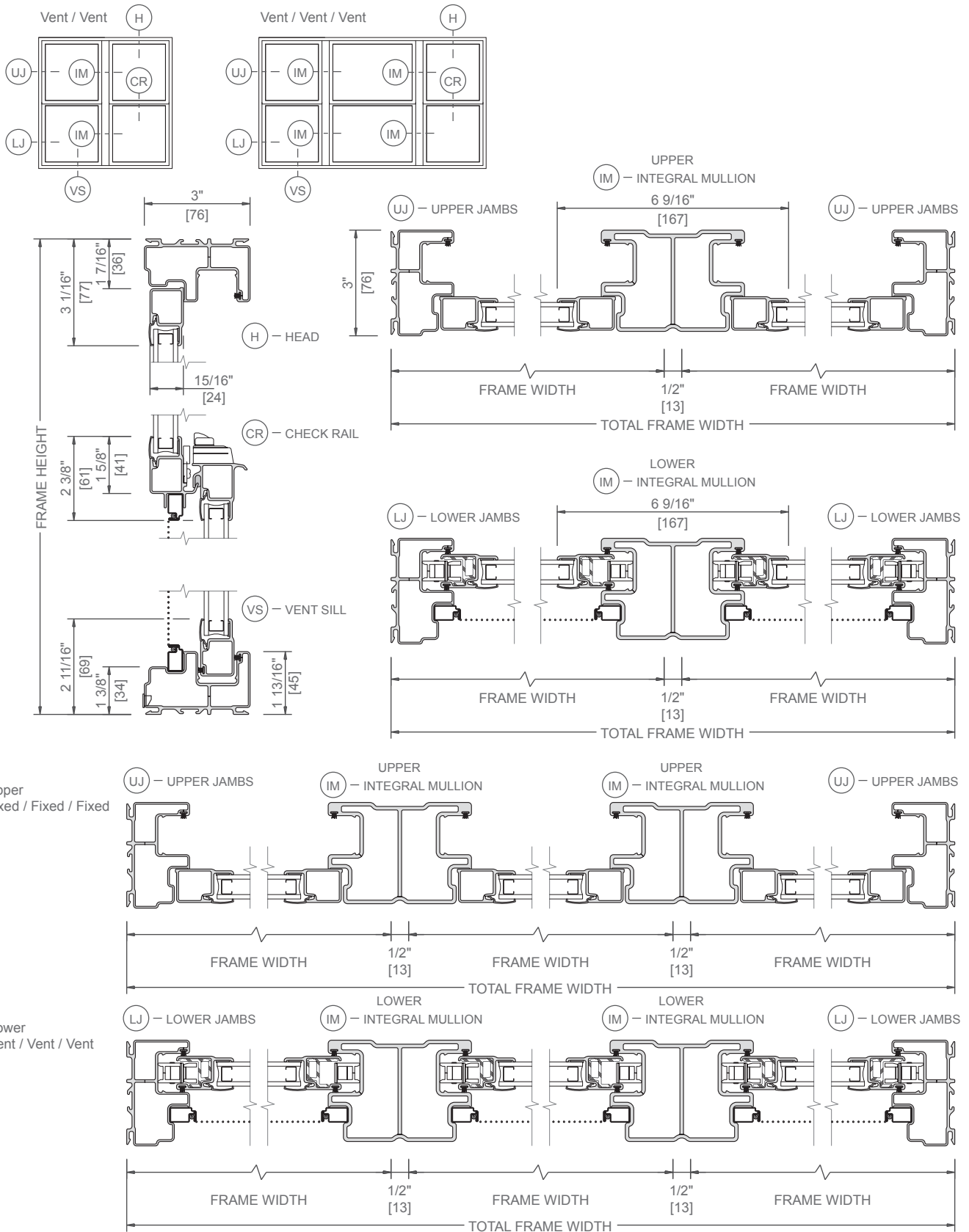

Scale 3" = 1' 0"

All dimensions are approximate.



Impervia® Single-Hung Windows

Unit Sections - Composites

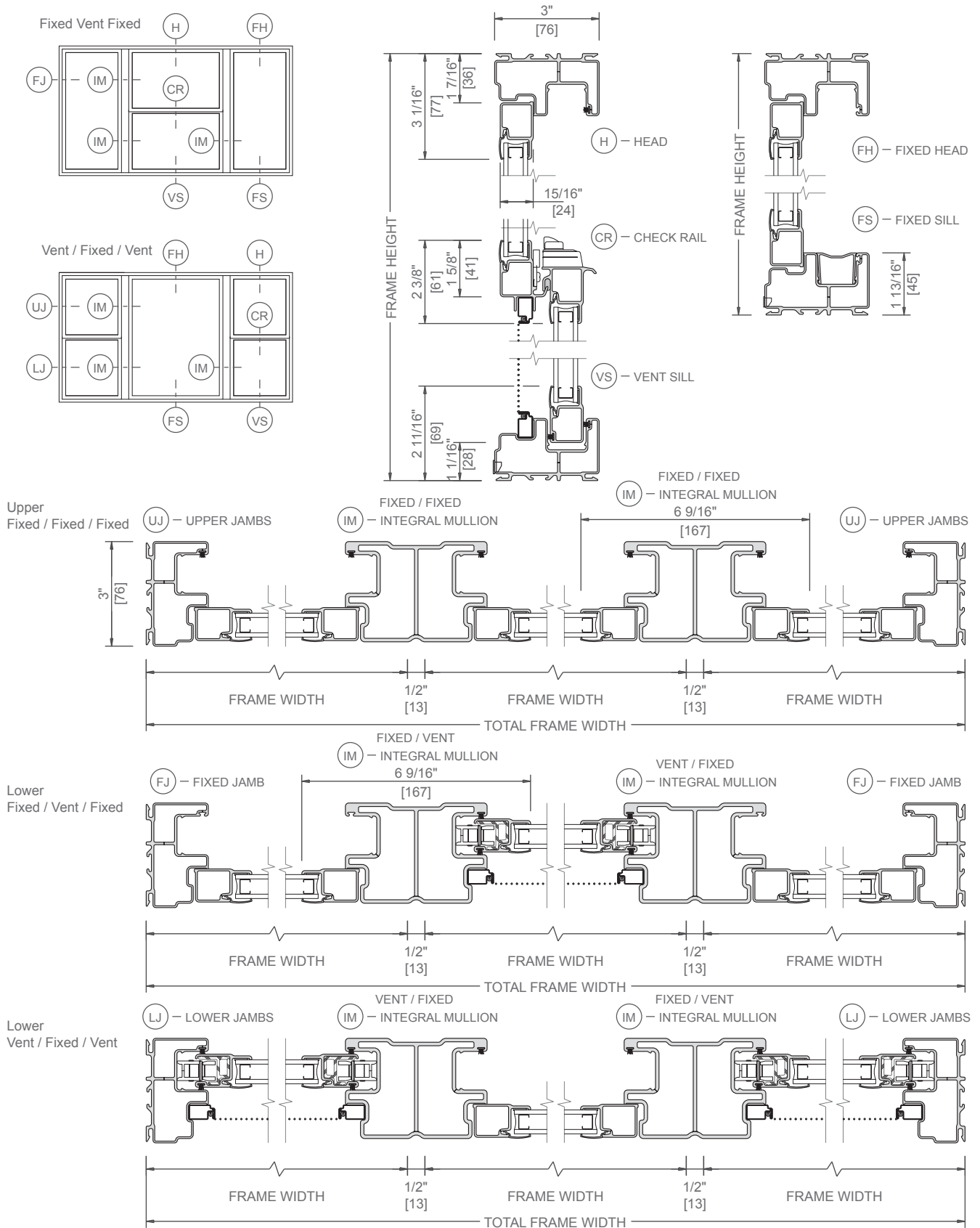

Scale 3" = 1' 0"
All dimensions are approximate.