

From: [redacted]
To: [redacted]
Subject: RE: [redacted]
Date: Wednesday, October 26, 2022 8:12:28 AM

This Message is From an External Sender
ATTENTION: This email was sent from an external source. Please be extra cautious when opening attachments or clicking links.

Entryway Layout

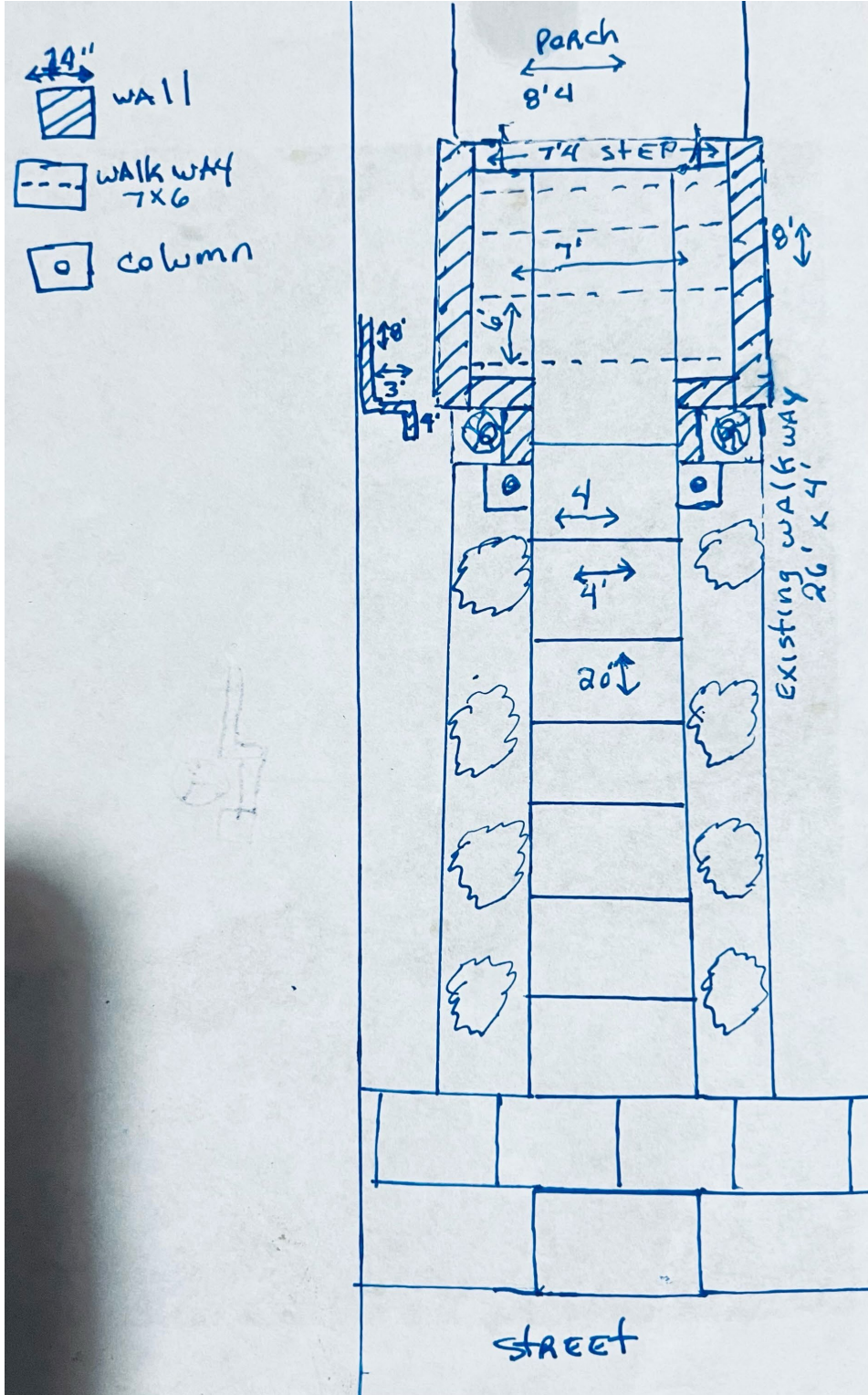

Kendin Paul
313-7174242

On Oct 26, 2022, at 7:33 AM, skilbee10@gmail.com wrote:

Good morning Dan,

- 1.2. I no longer want the piers and coping at driveway. They will be at the front walkway. If concrete stamping isn't permitted, I think exposed aggregate would be my next choice.
- 3. Yes, this is the same wall by the front walkway. However, the walkway will be widened at the porch where the wall will be located. Then the lighted column will be located midway down walkway. The walkway will remain current width from this point to street. The planter boxes will be the back door. I will keep a smaller landscaped area in the middle of the driveway in the backyard. No water feature. Just a pine tree, that's currently there, with bolder rock perimeter.

I will be sending dimensions and pictures