

**DESIGN CRITERIA:**  
 THE AWNING SUPPORTS ARE DESIGNED FOR 115 MPH, 3 SEC. GUST ULTIMATE WIND SPEED WIND UPLIFT @ 22 PSF & 30 PSF GROUND SNOW LOADS FOR EXPOSURE B, RISK CATEGORY II AS PER 2018 - MBC AND ASCE 7-10

ALL MOUNTING HARDWARE SHALL BE NON-CORROSIVE

ALL WELDING SHOULD BE USING E70 ELECTRODES AS PER AWS D 1.1 & D 1.2

ALL ALUMINUM SECTIONS SHALL BE 6063-T6 ALLOY

A PROTECTIVE BARRIER SHALL BE PROVIDED BETWEEN ALL STEEL AND ALUMINUM TO PREVENT CORROSION

THIS PROJECT SHALL ADHERE TO THE FOLLOWING CODES:  
 2015 MICHIGAN BUILDING CODE  
 2015 INTERNATIONAL FIRE PREVENTION CODE  
 2009 ANSI ACCESSIBILITY CODE

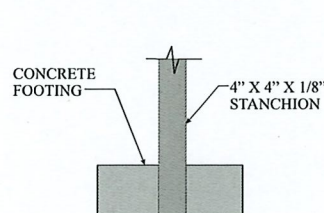

**STANCHION TO CONCRETE ATTACHMENT DETAIL**

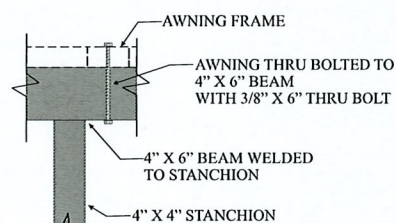

**STANCHION TO SUBSTRUCTURE ATTACHMENT DETAIL**

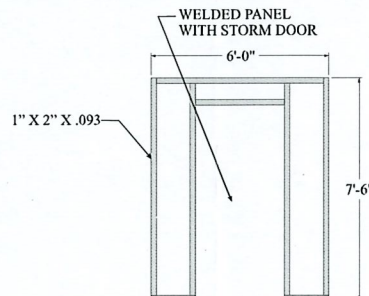

**WELDED PANEL WITH STORM DOOR DETAIL**

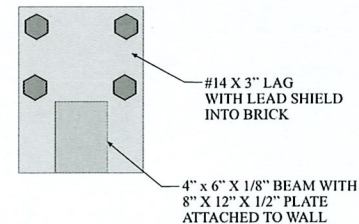
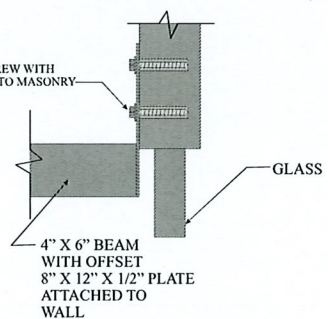
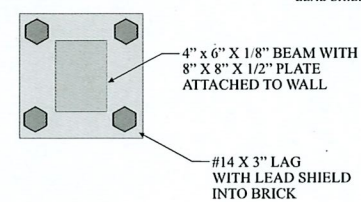
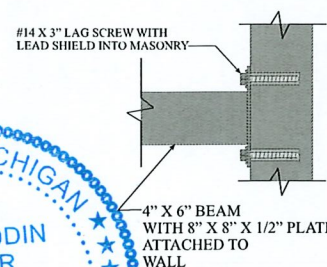
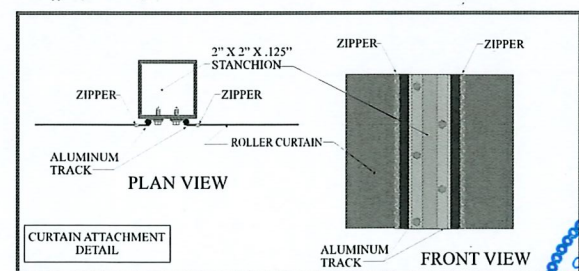
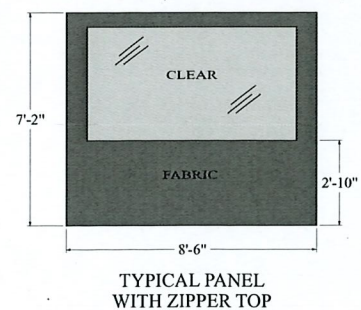
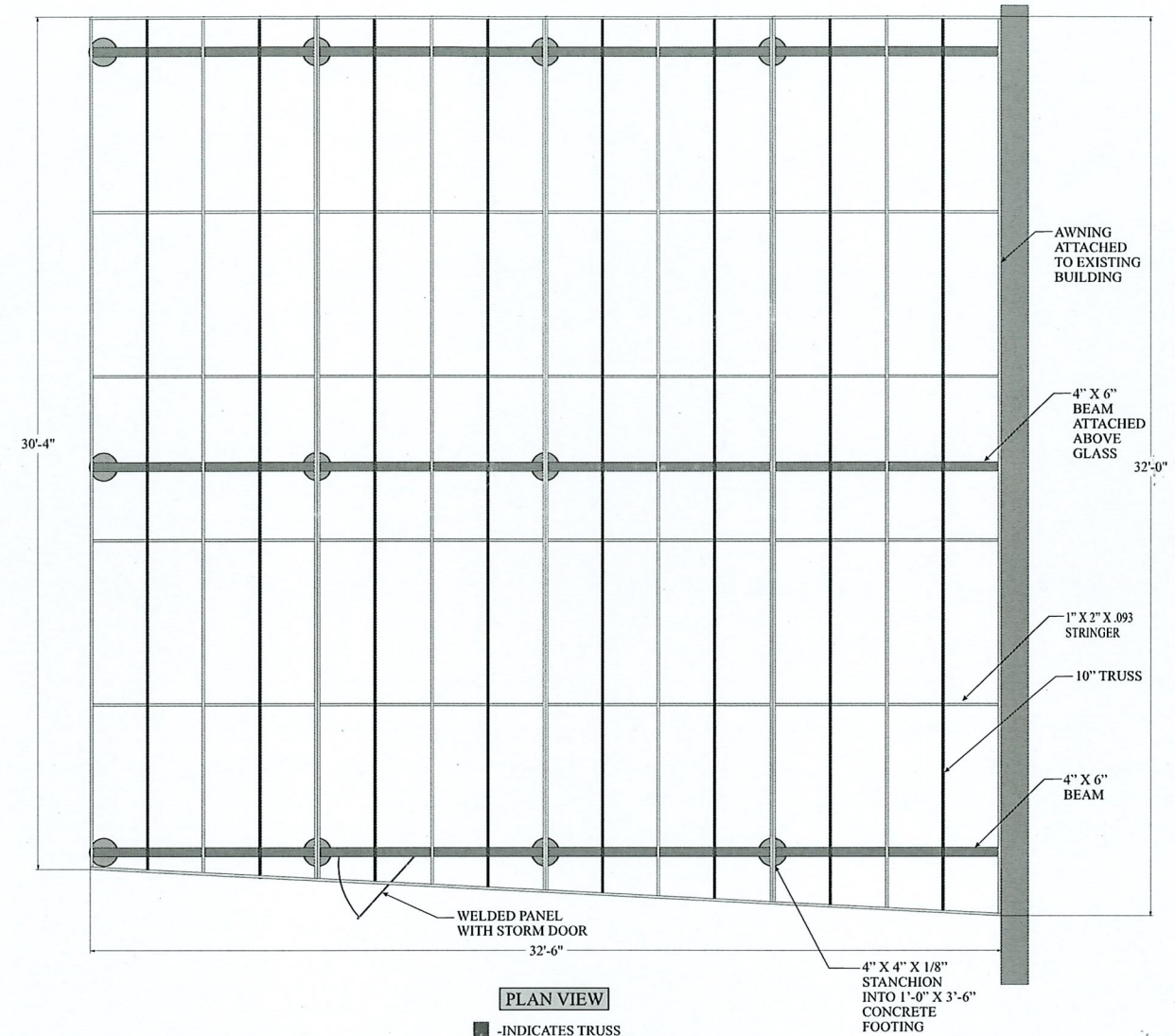

**Marygrove**  
 AWNINGS  
 TONY LOCKARD  
 BAKERSFIELD DETROIT  
 3100 WOODWARD  
 DETROIT, MI 48201  
 6/23/2022

**NOTES:**  
 ALL FRAMING ALUMINUM  
 1" X 1" X .093 UNLESS NOTED  
 FRAMES & SUBSTRUCTURE: BLACK  
 FABRIC: FERRARI SATIN BLACK 502V2-8450C

SEALED AWNING PLANS  
 BLD2022-04111  
 07/28/2022