



**EAST ELEVATION** East Elevation = 100' L x 11' H  
SCALE: NTS



**NORTH ELEVATION** North Elevation = 198' L x 11'/20'/24' H  
SCALE: NTS (Various Heights on Building)



**WEST ELEVATION** West Elevation = 67' L x 20'/30' H (Various Heights)  
SCALE: NTS



**SOUTH ELEVATION** South Elevation = 198' L x 11'/20'/24' H (Various Heights)  
SCALE: NTS

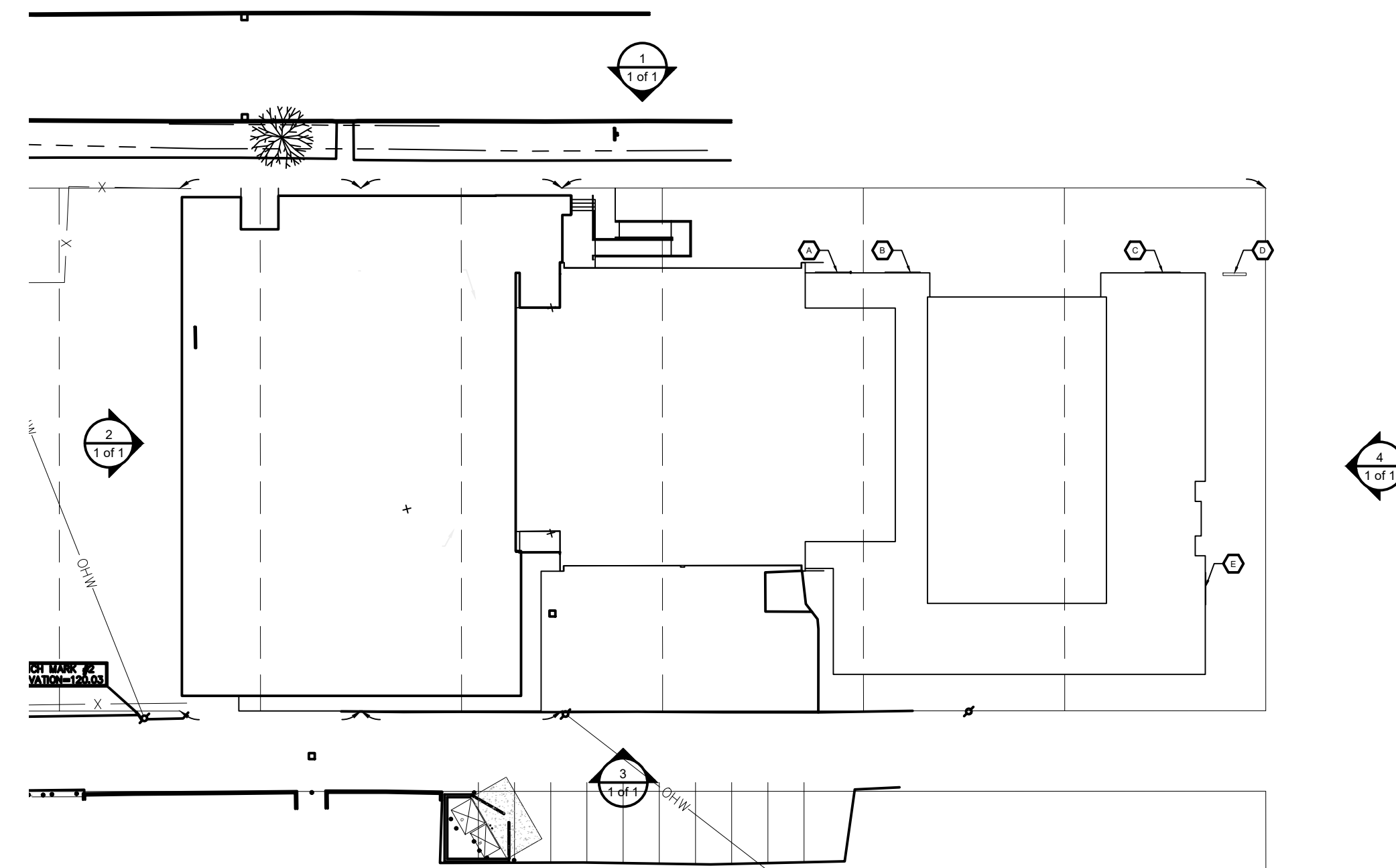

**1 SITE LOCATOR**  
SCALE: 1/32" = 1'-0"

E  
D  
C  
B  
A

6 | 5 | 4 | 3 | 2 | 1