

V:\19300-000- Jefferson East Parking Lots 2017\Civil Engineering\Plans\4 Construction Documents\CAD\19017-16D Jefferson East Lot 4\C304 Lot 4 SEESC Plan.dwg

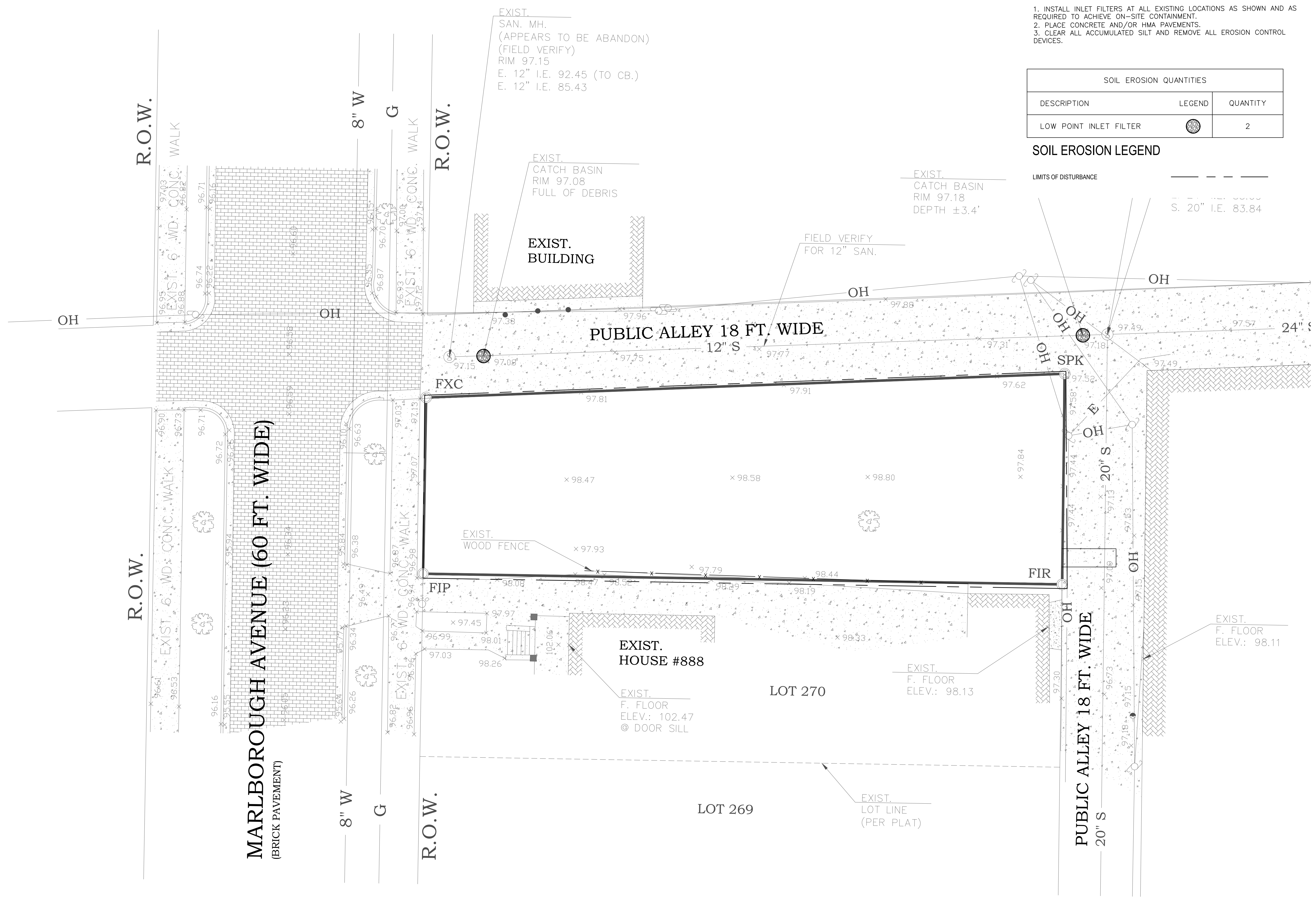

**EROSION CONTROL SEQUENCE**

1. INSTALL INLET FILTERS AT ALL EXISTING LOCATIONS AS SHOWN AND AS REQUIRED TO ACHIEVE ON-SITE CONTAINMENT.
2. PLACE CONCRETE AND/OR HMA PAVEMENTS.
3. CLEAR ALL ACCUMULATED SILT AND REMOVE ALL EROSION CONTROL DEVICES.

SOIL EROSION QUANTITIES		
DESCRIPTION	LEGEND	QUANTITY
LOW POINT INLET FILTER		2

**SOIL EROSION LEGEND**

**LIMITS OF DISTURBANCE**

	S. 20" I.E. 83.84
--	-------------------

Engineers  
Surveyors  
Planners  
Landscape Architects

28 West Adams Road  
Suite 1200  
Detroit, MI 48226  
p (313) 962-4442  
f (313) 962-5068  
www.giffelswebster.com

Executive:	STC
Manager:	MGD
Designer:	JPK
Quality Control:	MGD
Section:	

Professional Seal:



Know what's below.  
Call before you dig.

DATE	ISSUE
11.14.2017	UPDATE
03.08.2018	UPDATE REVIEW
06.08.2018	HDC SUBMITTAL
08.31.2018	ADDENDUM 2

Developed For:  
**Jefferson East Inc.**

300 River Place Dr. Ste 5250  
Detroit, MI 48215

P: 313.331.7929  
F: 313.331.0311

**Lot 4 SEESC Plan**

Jefferson East Parking Lots

City of Detroit  
Wayne County  
MICHIGAN

Date:	10.02.2017
Scale:	1"=20'
Sheet:	C304
Project:	19017-16D

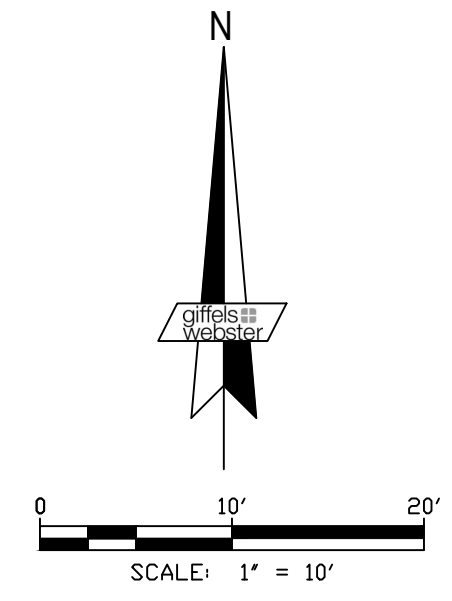

Copyright © 2017 Giffels Webster.  
No reproduction shall be made without the prior written consent of Giffels Webster.