

CITY OF DETROIT
HISTORIC DISTRICT COMMISSION

2 WOODWARD, SUITE 808
DETROIT, MICHIGAN 48226
PHONE 313-224-6536
FAX 313-224-1310

April 20, 2021

CERTIFICATE OF APPROPRIATENESS

Ms. Jacquelin Duncan
4245 Fullerton St.
Detroit, MI 48238

RE: Application Number 21-7148; 4245 Fullerton; Russell Woods-Sullivan Historic District

Dear Ms. Duncan:

At the regular scheduled meeting held virtually on April 14, 2021, the Detroit Historic District Commission (“Commission”) reviewed the above-referenced application for building permit. Pursuant to Section 5(10) of the Michigan Local Historic District Act, as amended, being MCL 399.205, MSA 5-3407(5)(10) and Section 21-2-73 of the 2019 Detroit City Code; the Commission has reviewed the above-referenced application for building permit and hereby issues a Certificate of Appropriateness, which is effective as of April 20, 2021.

The following proposed work meets the defined elements of design for the historic district and the Secretary of the Interior’s Standards for Rehabilitation and guidelines for rehabilitating historic buildings (36 CFR Part 67).

Per the attached documents, the project consists of the following components:

- Roof replacement

Please retain this COA for your files. You should now proceed to obtain a building permit from the City of Detroit Buildings, Safety, Engineering and Environmental Department. It is important to note that approval by the Detroit Historic District Commission does not waive the applicant's responsibility to comply with any other applicable ordinances or statutes.

For the Commission:



Daniel Rieden
Staff
Detroit Historic District Commission

THIS IS A 3-PAGE FORM - ALL INFORMATION IS REQUIRED FOR PROJECT REVIEW

HISTORIC DISTRICT COMMISSION PROJECT REVIEW REQUEST

City of Detroit - Planning & Development Department
2 Woodward Avenue, Suite 808
Detroit, Michigan 48226

Date: 1-6-2021

PROPERTY INFORMATION

ADDRESS: 4245 FULLERTON ST

AKA: _____

HISTORIC DISTRICT: _____

SCOPE OF WORK:
(Check ALL that apply)

Windows/
Doors

Roof/Gutters/
Chimney

Porch/
Deck

Landscape/Fence/
Tree/Park

General
Rehab

New
Construction

Demolition

Addition

Other: _____

APPLICANT IDENTIFICATION

Property Owner/
Homeowner

Contractor

Tenant or
Business Occupant

Architect/Engineer/
Consultant

NAME: RICH HOTEA

COMPANY NAME: PERFORMANCE REMODELING

ADDRESS: 14017 23 MILE RD

CITY: SHELBY TOWN

STATE: MI

ZIP: 48315

PHONE: 586.991.8802

MOBILE: _____

EMAIL: JOE@PR2.GLOBAL

PROJECT REVIEW REQUEST CHECKLIST

Please attach the following documentation to your request:

PLEASE KEEP FILE SIZE OF ENTIRE SUBMISSION UNDER 30MB

Completed Building Permit Application (highlighted portions only)

ePLANS Permit Number (only applicable if you've already applied for permits through ePLANS)

Photographs of ALL sides of existing building or site

Detailed photographs of location of proposed work (photographs to show existing condition(s), design, color, & material)

Description of existing conditions (including materials and design)

Description of project (if replacing any existing material(s), include an explanation as to why replacement--rather than repair--of existing and/or construction of new is required)

Detailed scope of work (formatted as bulleted list)

Brochure/cut sheets for proposed replacement material(s) and/or product(s), as applicable

NOTE:

Based on the scope of work, additional documentation may be required.

See www.detroitmi.gov/hdc for scope-specific requirements.

Upon receipt of this documentation, staff will review and inform you of the next steps toward obtaining your building permit from the Buildings, Safety Engineering and Environmental Department (BSEED) to perform the work.

SUBMIT COMPLETED REQUESTS TO HDC@DETROITMI.GOV

P2 - BUILDING PERMIT APPLICATION

Date: 1-6-2021

PROPERTY INFORMATION

Address: 4245 FULLERTON ST Floor: Suite#: Stories:
AKA: Lot(s): Subdivision:
Parcel ID#(s): 14004818 Total Acres: Lot Width: Lot Depth:
Current Legal Use of Property: RESIDENTIAL Proposed Use:
Are there any existing buildings or structures on this parcel? Yes No

PROJECT INFORMATION

Permit Type: New Alteration Addition Demolition Correct Violations
Foundation Only Change of Use Temporary Use Other:
Revision to Original Permit #: (Original permit has been issued and is active)

Description of Work: (Describe in detail proposed work and use of property, attach work list)
TEAR OF AND RE-ROOF, REMOVE (3) LAYERS, INSTALL NEW LANDMARK PRO HD SHINGLES (3) LAYERS.

MBC use change No MBC use change

Included Improvements (Check all applicable; these trade areas require separate permit applications)

HVAC/Mechanical Electrical Plumbing Fire Sprinkler System Fire Alarm

Structure Type

New Building Existing Structure Tenant Space Garage/Accessory Building
Other: Size of Structure to be Demolished (LxWxH) cubic ft.

Construction involves changes to the floor plan? Yes No

(e.g. interior demolition or construction to new walls)

Use Group: Type of Construction (per current MI Bldg Code Table 601)

Estimated Cost of Construction \$ 9600 By Contractor By Department

Structure Use

Residential-Number of Units: 1 Office-Gross Floor Area Industrial-Gross Floor Area
Commercial-Gross Floor Area Institutional-Gross Floor Area Other-Gross Floor Area

Proposed No. of Employees: List materials to be stored in the building:

PLOT PLAN SHALL BE submitted on separate sheets and shall show all easements and measurements (must be correct and in detail). SHOW ALL streets abutting lot, indicate front of lot, show all buildings, existing and proposed distances to lot lines. (Building Permit Application Continues on Next Page)

For Building Department Use Only

Intake By: Date: Fees Due: DngBld? No

Permit Description:

Permit #:

Current Legal Land Use: Proposed Use:

Permit#: Date Permit Issued: Permit Cost: \$

Zoning District: Zoning Grant(s):

Lots Combined? Yes No (attach zoning clearance)

Revised Cost (revised permit applications only) Old \$ New \$

Structural: Date: Notes:

Zoning: Date: Notes:

Other: Date: Notes:



IDENTIFICATION (All Fields Required)

Property Owner/Homeowner Property Owner/Homeowner is Permit Applicant

Name: JACQUELINE DUNCAN Company Name: _____
Address: 4245 FULLERTON ST City: DETROIT State: MI Zip: 48238
Phone: 586.991.8802 Mobile: 586.991.8872
Driver's License #: _____ Email: JOE@PR2.GLOBAL

Contractor Contractor is Permit Applicant

Representative Name: RICHARD HOTEA Company Name: PERFORMANCE RESIDENTIAL REMODELING
Address: 14017 23 MILE RD City: SHELBY TOWNSHIP State: MI Zip: 48313
Phone: 586.991.8802 Mobile: 586.991.8872 Email: JOE@PR2.GLOBAL
City of Detroit License #: LIC2018-00283

TENANT OR BUSINESS OCCUPANT Tenant is Permit Applicant

Name: _____ Phone: _____ Email: _____

ARCHITECT/ENGINEER/CONSULTANT Architect/Engineer/Consultant is Permit Applicant

Name: _____ State Registration#: _____ Expiration Date: _____
Address: _____ City: _____ State: _____ Zip: _____
Phone: _____ Mobile: _____ Email: _____

HOMEOWNER AFFIDAVIT (Only required for residential permits obtained by homeowner)

I hereby certify that I am the legal owner and occupant of the subject property and the work described on this permit application shall be completed by me. I am familiar with the applicable codes and requirements of the City of Detroit and take full responsibility for all code compliance, fees and inspections related to the installation/work herein described. I shall neither hire nor sub-contract to any other person, firm or corporation any portion of the work covered by this building permit.

Print Name: _____ Signature: _____ Date: _____
(Homeowner)

Subscribed and sworn to before me this _____ day of _____ 20 ____ A.D. _____ County, Michigan

Signature: _____ My Commission Expires: _____
(Notary Public)

PERMIT APPLICANT SIGNATURE

I hereby certify that the information on this application is true and correct. I have reviewed all deed restrictions that may apply to this construction and am aware of my responsibility thereunder. I certify that the proposed work is authorized by the owner of the record and I have been authorized to make this application as the property owner(s) authorized agent. Further I agree to conform to all applicable laws and ordinances of jurisdiction. **I am aware that a permit will expire when no inspections are requested and conducted within 180 days of the date of issuance or the date of the previous inspection and that expired permits cannot be**

Print Name: RICHARD HOTEA Signature: _____ Date: 1-6-2021
(Permit Applicant)

Driver's License #: H300738585138 Expiration: 2-22-2023

Subscribed and sworn to before me this 6th day of JAN 20 21 A.D. MACOMB County, Michigan

Signature: _____ My Commission Expires: 3-26-2024
(Notary Public)

FRANCA ANN VANASSCHE
Notary Public, State of Michigan
County of Macomb
My Commission Expires 03-26-2021

Section 23a of the state construction code act of 1972, 1972PA230, MCL 215.1525A, prohibits a person from conspiring to circumvent the licensing requirements of this state relating to persons who are to perform work on a residential building or a residential structure. Visitors of Section 23a are subject to civil fines.

This application can also be completed online. Visit detroitmi.gov/bsecd/elaps for more information.





Roofing Project Labor Estimate

STEEP SLOPE = SAFTEY JACKS!

Job Name: Duncan, Jacqueline : 20-922-919
Address: 4245 Fullerton St.
City/Zip: Detroit, 48238
X-Streets: Davison / Livernois

Package: 3 - Performance Systems Plus
Pitch: 10/12 + Low Slope
Layers: 2-Layer

<u>Installed Material</u>
3 Layer - Steep Slope > 8/12
Cedar Shake Tear-off
Low Slope Roofing
Wood Replacement - 4' x 8' Sheet
Wood Replacement - 1" x 6" Board
Install Ridge Vent
Install Edge Vent
Install Can Vent
Install Kitchen / Bath Exhaust Vents
Install Soffit Vents
Build Saddle/Cricket (Small)
Build Saddle/Cricket (Large)
Install New Apron Flashing
Install New Counter Flashing
Chimney Flashing
Install New Skylight
Flash Existing Skylight
Close Off Gable Vents
Ground Drop
Perform Lead Safe Work
Dumpster Fee - Your Dumpster (Add to Bill)
Dumpster Fee - Our Dumpster (Deduct from Bill)





Mr. First _____ Mrs./Ms. First Jacqueline Last Duncan
 Job Address 4245 Fullerton St City Detroit State MI Zip 48238 Main Cross Streets _____
 Home Phone _____ Mr. Work _____ Mr. Cell _____
 Email Jacquelyne61@gmail.com DL # CONFIDENTIAL CONFIDENTIAL Mrs./Ms. Cell 313-333-0529
DL # joe, 09:39:47, 25/09/2020 joe, 09:39:53, 25/09/2020
 Type of Home: House Condo MHC - 1-Story, 2-Story, 3-Story Design: Brick Frame Bungalow Ranch Colonial Contemporary

Job # 20-922-919
 Page _____ of _____
 Sign Posted _____ Days.
 Social Media Package _____ INIT.

Source JOHN C / Facebook
 Year House Built 1929
 Lead Test Required

CONTRACT AND AGREEMENT

I/we, the owners of the premises mentioned below, hereby contract with and authorize you as contractor, to furnish all necessary materials, labor and workmanship, to install, construct and place the improvements according to the following specifications, terms and conditions, on premises below described:

ROOF STYLE: Gable Hip Gambrel Mansard Flat

<input checked="" type="checkbox"/> Home <u>169.00 Flat</u> # Sq. Ft. <u>1197.45 Gable</u>	<input type="checkbox"/> Garage # Sq. Ft. _____	<input type="checkbox"/> Home/Garage Attach. # Sq. Ft. _____	<input type="checkbox"/> Additional Layer Tear Off Charge (if applicable) Charge Per Layer _____
<input type="checkbox"/> Tear Off Only # of Layers: <input type="checkbox"/> 1 <input type="checkbox"/> 2 <input checked="" type="checkbox"/> 2+	<input type="checkbox"/> Tear Off Only # of Layers: <input type="checkbox"/> 1 <input type="checkbox"/> 2 <input type="checkbox"/> 2+	<input type="checkbox"/> Tear Off Only # of Layers: <input type="checkbox"/> 1 <input type="checkbox"/> 2 <input type="checkbox"/> 2+	<input type="checkbox"/> Tear Off Only # of Layers: <input type="checkbox"/> 1 <input type="checkbox"/> 2 <input type="checkbox"/> 2+
Pitch <u>10/12</u>	Pitch _____	Pitch _____	Pitch _____

Shingle Color Max Def Atlantic Blue Drip Edge Color White Existing Vent Type Canned

- 1 Essentials Package** INIT.
 • CertainTeed Landmark Dimensional / 3 Tab Cap
 • Standard Water/Ice Shield (Code) / Includes Valleys
 • 15 Lb. Felt Paper
 • # _____ 550 Can Vents/ Includes Ridge Vents if existing
 • New Drip Edge and Flash Cards / Plastic Pipe Boot
 • Clean Up & Removal (Magnetic Sweep)
 • 1-Time Transferable Warranty
 • 1-Year Labor Warranty
- 2 Performance Plus Package** INIT.
 • CertainTeed Landmark Dimensional / 3 Tab Cap
 • Water/Ice Shield (Code) / Includes Valleys
 • Synthetic Felt Underlayment
 • # _____ 750 Can Vents Alum./Ridge Vents if existing
 • New Drip Edge and Flash Cards / Aluminum Pipe Boot
 • Clean Up & Removal (Magnetic Sweep)
 • 1-Time Transferable Warranty
 • 5-Year Labor Warranty
- 3 Performance Systems Plus Package** INIT.
 • Lifetime CertainTeed Landmark Pro HD Shingle
 • Shadow Ridge Premium Ridge Cap
 • Minimum 6-Foot Water/Ice Shield (all edges, valleys, chimneys and pipe vent)
 • Premium Synthetic Felt Underlayment
 • 128 sq. feet of Decking or 128 linear feet of 1 x 6 Covered (if needed)
 • Aluminum Pipe Boot & Cover
 • New Drip Edge, Chimney Flashing
 • Solar Seal #900 (terpolymer rubber sealant)
 • Edge Vent and Chimney Cricket (if applicable)
 • # _____ 750-G Can Vents Galvanized
 • Ft. 25 Ridge Vents (if applicable)
 • Clean Up & Removal (magnetic sweep)
 • 1-Time Transferable Lifetime Material/Labor Guarantee NDL
- 4 Designer Plus Package** INIT.
 • Lifetime CertainTeed Designer Shingle
 • Shangle Ridge Designer Ridge Cap
 • Minimum 6-Foot Water/Ice Shield (all edges, valleys, chimneys and pipe vent)
 • Diamond Deck Synthetic Underlayment
 • 200 sq. ft. Wood Covered (if needed) Pipe/Vent Flashing,
 • Aluminum Pipe Boot & Cover
 • New Drip Edge, Chimney Flashing
 • Solar Seal #900 (terpolymer rubber sealant)
 • Edge Vent and Chimney Cricket (if applicable)
 • # _____ 750-G Can Vents Galvanized
 • Ft. _____ Ridge Vents (if applicable)
 • Clean Up & Removal (magnetic sweep)
 • Unlimited Transferable Lifetime Labor/Material Guarantee NDL
- 5 Star Warranty Upgrade** INIT.

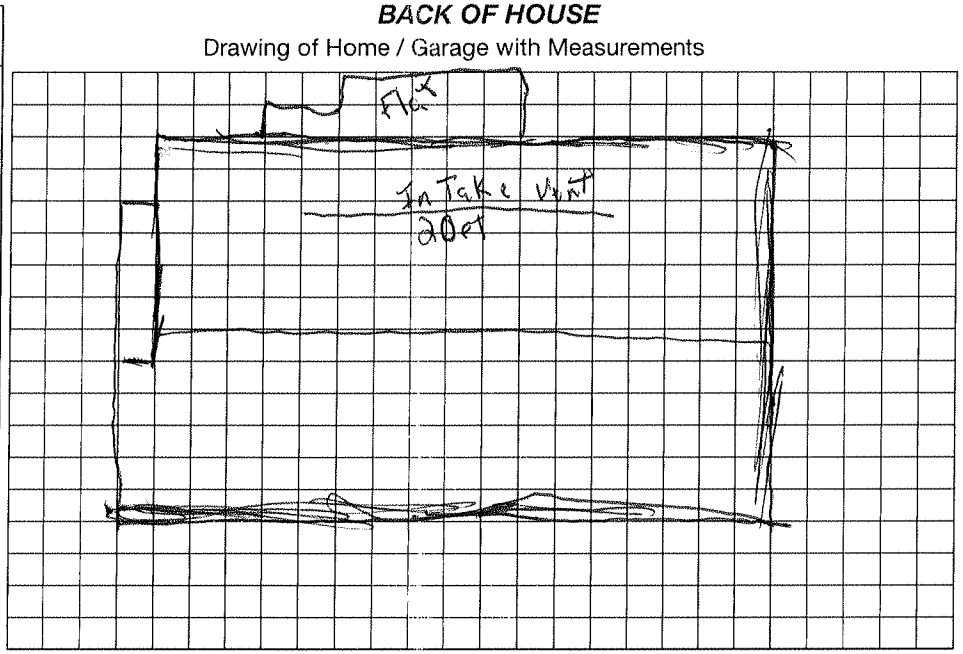

FRONT OF HOUSE

Comments/Notes: 1) Remove old roof (3 layers) included in price
 2) Furnish & Install CertainTeed Landmark Pro HD Shingles on House
 3) Furnish & Install Flat Roofing system to Back Roof on House
 4) Furnish & Install Ridge Vent to House
 5) Furnish & Install Intake Vent to House
 6) Clean up & Dispose of all Debris
 7) All Taxes & Discounts Included
 8) Permit cost ~~included~~ included

Areas NOT being done on home: _____

Total price of \$ 9,600
 Deposit (Check One) \$ 3,200
 Cash Check # _____ Credit Card
 Final amount due upon substantial completion (Check One) \$ 6,400
 Cash Check # _____ Credit Card
 Name as it appears on card: _____
 Credit card account no.: _____
 Exp. date: _____ 3 or 4 digit CPU code: _____
 Amount to be financed by financial company \$ _____
 Finance Company: _____ Finance Plan # _____
 Number of months: _____ Interest Rate _____
 Equal Minimal Deferred: Number of months _____
 Monthly payment amount \$ _____

BUYERS RIGHT TO CANCEL – You the buyer, may cancel this transaction at any time prior to midnight of the third business day after the date of this transaction. See reverse side for notice of cancellation form and explanation of this right.:

IN WITNESS WHEREOF the parties have hereunto signed their name(s) this 22 day of Sep 2020
 MICHIGAN HOME SOLICITATION SALES ACT rescission cut off date: 25 day of Sep 2020

Homeowner waives Right to Cancel to expedite install: _____ INIT.
 Lead Pamphlet Received _____ INIT.
 Owner Signature: Jacqueline Duncan
 Owner Signature: _____
 Salesperson Signature: John Terranova
 Witnessed by Salesperson (Print Name): John Terranova
 Salesperson Cell: 248 635-8069

Rotted Wood or Cedar Shake Roof is beyond our control. There will be an extra charge per 4x8 sheet of OSB Wood of ~~\$50.00~~ Extra charge for 1x6 at \$6.00 per linear ft. This is in addition to price ~~180.00~~
 Refusal of rooftop material delivery and/or dumpster delivery will add \$ 300 to the total price of the contract.
 Customer agrees to pay for all building permit costs.
 Includes Clean Up and Haul Away, Taxes & Discounts Included

ROOFING - Choose Only On



4245

4253



4245





