



**MOTOWN**  
MUSEUM



# Campus Milestones

Work on Motown Museum Campus has been progressing!



Hitsville USA

## Hitsville USA Exterior completed!

Reopening February 2023  
Expected opening final renovations Q3 2025



Expansion

- ① LOBBY
- ② THEATER
- ③ PRE-FUNCTION
- ④ RETAIL
- ⑤ CAFE
- ⑥ MONUMENTAL STAIR

## Expansion

Expected opening Q4 2025

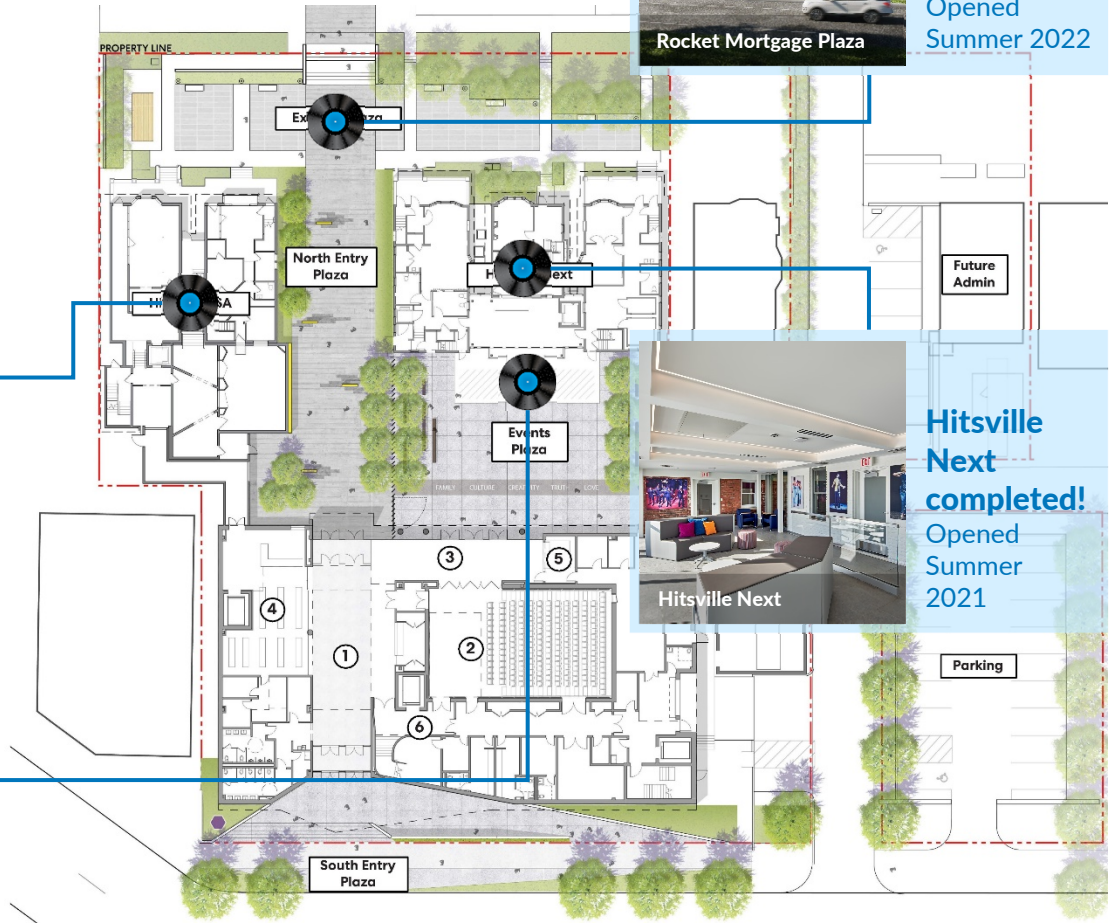

Rocket Mortgage Plaza

**Rocket Mortgage Plaza Completed!**  
Opened Summer 2022

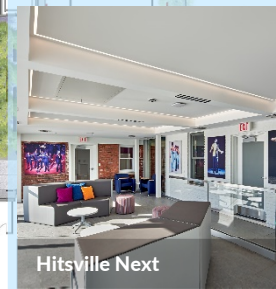

Hitsville Next

**Hitsville Next completed!**  
Opened Summer 2021



Hitsville U.S.A.

AM MOTOWN

MOTOWN MUSEUM



MR. & MRS. JESIE AFRARO

MR. & MRS. CHARLIE & CHELSEA JONES

MR. ERIC & MRS. ANN MILLER

MR. & MRS. SMITH

MISS SARAH HARRACH

MR. & MRS. MCNAMARA

MR. & MRS. SMITH

MR. CHARLIE & MRS. CHELSEA JONES

MR. DANIEL LOGAN

MR. & MRS. JESIE AFRARO

MR. ERIC & MRS. ANN MILLER

MR. & MRS. SMITH

MR. CHARLIE & MRS. CHELSEA JONES

MR. DANIEL LOGAN

MR. & MRS. JESIE AFRARO

MR. ERIC & MRS. ANN MILLER

MR. & MRS. SMITH

MR. CHARLIE & MRS. CHELSEA JONES

MR. DANIEL LOGAN

MR. & MRS. JESIE AFRARO

MR. ERIC & MRS. ANN MILLER

MR. & MRS. SMITH

MR. CHARLIE & MRS. CHELSEA JONES

MR. DANIEL LOGAN

MR. & MRS. JESIE AFRARO

MR. ERIC & MRS. ANN MILLER

MR. & MRS. SMITH

MR. CHARLIE & MRS. CHELSEA JONES

MR. DANIEL LOGAN

MR. & MRS. JESIE AFRARO

MR. ERIC & MRS. ANN MILLER

MR. & MRS. SMITH

MR. CHARLIE & MRS. CHELSEA JONES

MR. DANIEL LOGAN

MR. & MRS. JESIE AFRARO

MR. ERIC & MRS. ANN MILLER

MR. & MRS. SMITH

MR. CHARLIE & MRS. CHELSEA JONES

MR. DANIEL LOGAN

MR. & MRS. JESIE AFRARO

MR. ERIC & MRS. ANN MILLER

MR. & MRS. SMITH

MR. CHARLIE & MRS. CHELSEA JONES

MR. DANIEL LOGAN

MR. & MRS. JESIE AFRARO

MR. ERIC & MRS. ANN MILLER

MR. & MRS. SMITH

MR. CHARLIE & MRS. CHELSEA JONES

MR. DANIEL LOGAN

CULTURE

TRUTH

STUDIO A



MS. LILY

FORD MOTOR CENTER

FAMILY LOVE



MOTOWN  
MUSEUM

FORD MOTOR COMPANY THEATER

MOTOWN  
MUSEUM



FORD MOTOR COMPANY THEATER

DOWNTOWN MUSEUM

**CONSULTANTS**

**CIVIL**  
 GIFFELS WEBSTER  
 28 West Adams, Suite 1200  
 Detroit, MI 48226

**STRUCTURAL**  
 DESAI NASR  
 6765 Daly Road  
 West Bloomfield, MI 48322

**MEP**  
 WSP | PARSONS BRINCKERHOFF  
 One Penn Plaza, 2nd floor, 230 W 34th Street  
 New York, NY 10119

**EXHIBIT DESIGN**  
 GALLAGHER & ASSOCIATES  
 454 8th Avenue, 11th Floor  
 New York, NY 10001

**OWNER**  
 MOTOWN MUSEUM  
 2648 W Grand Blvd  
 Detroit, MI 48208

PROGRESS SET FOR REVIEW ONLY  
 THESE DOCUMENTS ARE FOR  
 DESIGN REVIEW AND NOT  
 INTENDED FOR CONSTRUCTION,  
 BIDDING, OR PERMIT PURPOSES.  
 THEY WERE PREPARED BY OR  
 UNDER SUPERVISION OF:

**PROJECT**

**MOTOWN MUSEUM EXPANSION**  
 2648 W Grand Blvd  
 Detroit, MI 48208

**MOTOWN MUSEUM**  
 2648 W Grand Blvd  
 Detroit, MI 48208  
**KEYPLAN**

100% DESIGN DEVELOPMENT SEPTEMBER 13, 2017

**ISSUE CHART**

**MOTOWN REZONING EXHIBIT**

10.16.2023

MARK	DATE
P+W Job Number	830400
HAA Job Number	2015055.01
Drawn	
Checked	
Approved	

**TITLE**  
 Existing Conditions - Overall

**SHEET NUMBER**  
**C01-00**

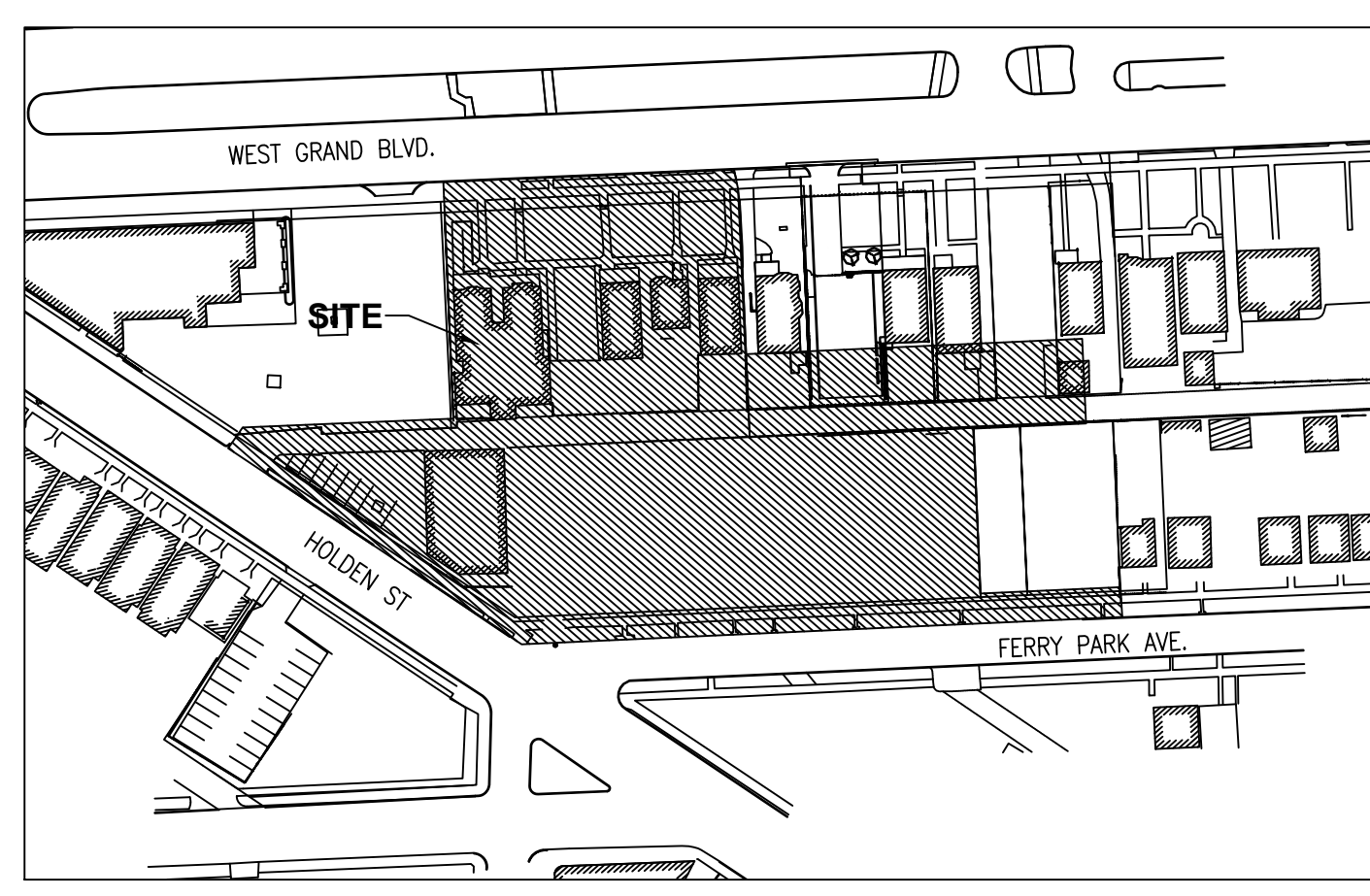

**SITE LOCATION MAP**  
 SCALE: 1" = 120'

**LEGEND - EXISTING**

— E/ PAVEMENT	○ HYDRANT	— SIGN
— CURB	⊗ WATER VALVE	○ PROT. POST/GUARD POST
— E/ GRAVEL	⊗ WATER METER	— GUY
— CL. ROAD	— FDC CONNECTION	— UTILITY FLAG
— RAILROAD	⊗ IRRIGATION CONTROL BOX	★ BLDG. CORNER (FIELD LOCATED)
— E/ WALK	— STORM MH	○ HANDICAP PARKING
— FENCE	— CATCH BASIN	○ PARKING METER
— GUARD RAIL	— BEEHIVE CB	○ RESIDENTIAL MAILBOX
— WALL	⊗ ROOF/DOWN SPOUT	○ U.S. MAILBOX
— BLDG. LINE	○ C.O. STORM CLEAN OUT	— LAWN IRRIG. HEAD
— OH — OH — OVERHEAD WIRES	○ ROUND CB	★ MISC. TOPO. SHOT
— RAILING	○ LIGHT POLE	○ SURVEY CONTROL POINT
— OVERHANG LINE	○ UTILITY POLE	○ FOUND IRON
— STM — STM — STORM LINE	○ ELEC. TRANS.	○ FOUND NAIL
— SAN. LINE	○ AIR CONDITIONER	— F. CUT CROSS
— WATER LINE	○ ELEC. MH	○ SECTION COR.
— GAS LINE	○ ELEC. METER	○ FENCE POST
— UGE — UGE — UG ELEC. LINE	○ ELEC. RISER	○ BENCHMARK
— UGT — UGT — UG TELE. LINE	○ TRAFFIC CONTROL BOX	○ FOUND PIPE
— UG CABLE TV LINE	○ PUBLIC LIGHTING MH	○ FOUND MON.
— PAINT STRIPE	○ GAS METER	○ ASPH. ASPHALT
— COMBINED SEWER	○ GAS RISER	○ CONC. CONCRETE
— PLD LINE	○ GAS VALVE	○ O.H. OVERHANG
— STEAM LINE	○ GAS MH	○ F.I. FOUND IRON
— SECTION LINE	○ TELE. RISER	○ S.I. SET IRON
— ELECTRIC OVERHEAD	○ TELE. MH	○ F.I.P. FOUND IRON PIPE
— TELEPHONE OVERHEAD	○ TELE. CROSS BOX	○ M. MEASURED
○ SAN. MH	○ CABLE RISER	○ R. RECORD
○ C.O. SAN. CLEAN OUT	○ MANHOLE	○ F.M. FOUND MONUMENT
○ SAN. RISER		○ S.N. SET NAIL
○ P.S. SAN. PUMP STATION		○ CMP CORRUGATED METAL PIPE
○ COMB. MH		○ RCP REINFORCED CONCRETE PIPE
○ GATE VALVE		

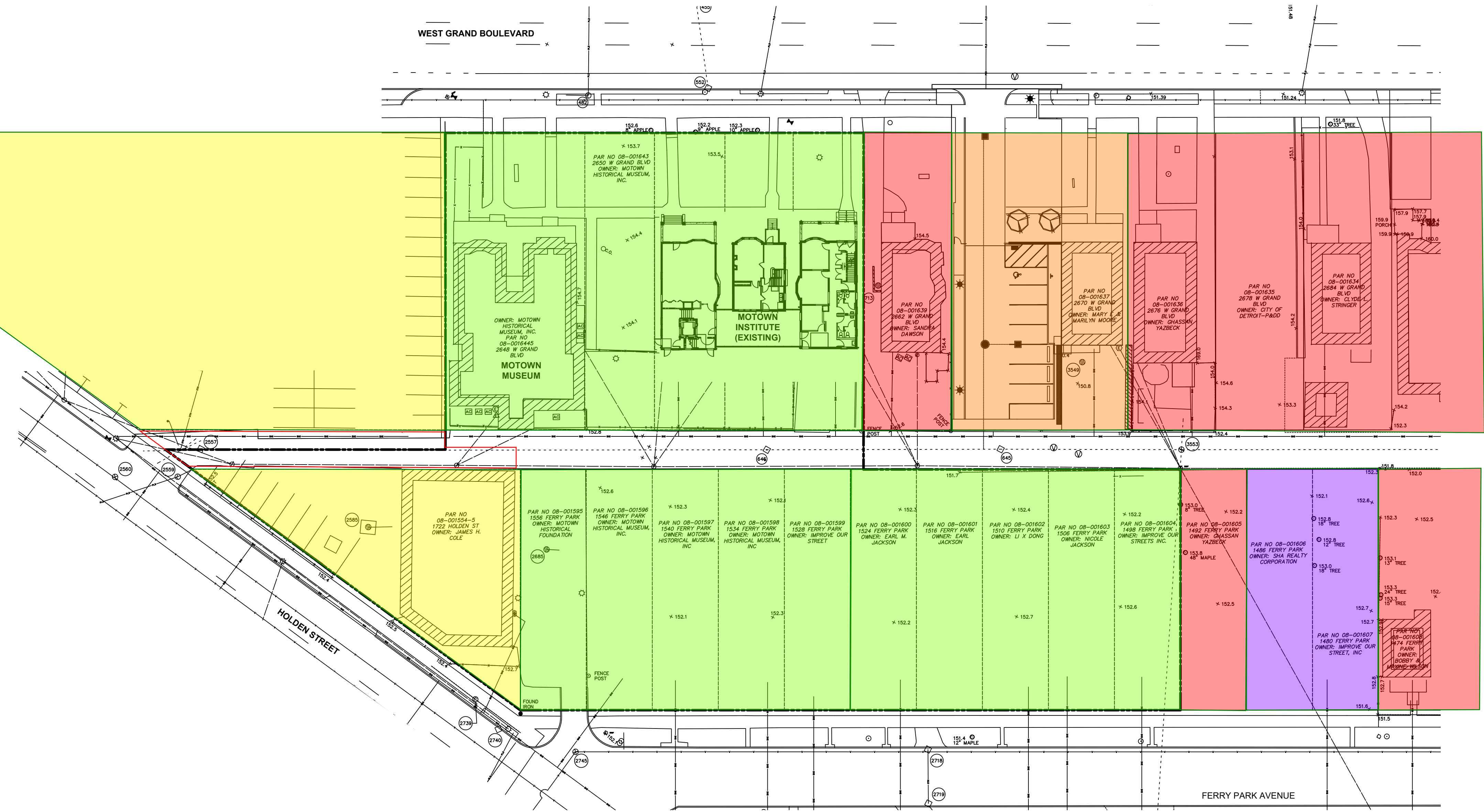

**NOTE:**

- ORANGE PARCELS ARE OWNED BY MOTOWN OR RELATED ENTITY AND CURRENTLY ZONED B4
- PURPLE PARCELS ARE OWNED BY MOTOWN AND CURRENTLY ZONED R2
- GREEN PARCELS ARE OWNED BY MOTOWN, CURRENTLY ZONED NORTH OF ALLEY B4, SOUTH OF ALLEY R2, AND PROPOSED TO BE REZONED TO SD2
- YELLOW PARCELS ARE OWNED BY COLE FUNERAL HOME AND CURRENTLY ZONED NORTH OF ALLEY B4, SOUTH OF ALLEY R2
- RED PARCELS ARE OWNED BY OTHERS. NORTH OF ALLEY ZONED B4, SOUTH OF ALLEY ZONED R2.

**UTILITY STATEMENT**

THE UNDERGROUND UTILITIES SHOWN HAVE BEEN LOCATED FROM FIELD SURVEY INFORMATION AND EXISTING DRAWINGS. THE SURVEYOR MAKES NO GUARANTEE THAT THE UNDERGROUND UTILITIES SHOWN COMPRISE ALL SUCH UTILITIES IN THE AREA, EITHER IN SERVICE OR ABANDONED. THE SURVEYOR FURTHER DOES NOT WARRANT THAT THE UNDERGROUND UTILITIES SHOWN ARE IN THE EXACT LOCATION INDICATED ALTHOUGH HE DOES CERTIFY THAT THEY ARE LOCATED AS ACCURATELY AS POSSIBLE FROM INFORMATION AVAILABLE.

(R) = UTILITY SHOWN FROM RECORDS OR PLANS, & FIELD LOCATED WHERE POSSIBLE.  
 PRIOR TO THE PLANNED BUILDING IMPROVEMENTS, AND/ OR CONSTRUCTION, THE RESPECTIVE UTILITY COMPANIES MUST BE NOTIFIED TO STAKE THE PRECISE LOCATION OF THEIR UTILITIES.

**SURVEY NOTES**

- NO TELEPHONE, OR STEAM UTILITY MAPS WERE MADE AVAILABLE AT THE TIME OF SURVEY.
- TREE SIZES AND SPECIES ARE THE BEST ESTIMATION OF THE FIELD SURVEYOR. SPECIFIC QUESTIONS REGARDING INDIVIDUAL TREES SHOULD BE DIRECTED TO A QUALIFIED FORESTER.
- NO TITLE COMMITMENT POLICY WAS PROVIDED, THEREFORE EASEMENTS MAY EXIST THAT ARE NOT SHOWN.
- NO CERTIFICATION CAN BE MADE AS TO LIMITS OF OWNERSHIP.

