

Referrals
4.2.19

**NEIGHBORHOOD
AND COMMUNITY
SERVICES STANDING
COMMITTEE**

**OFFICE OF CONTRACTING
AND PROCUREMENT**

March 27, 2019

HONORABLE CITY COUNCIL:

The Purchasing Division of the Finance Department recommends a Contract with the following firm(s) or person(s):

6001558 100% City Funding – To Provide General Contracting Services for Detroit Police Department’s 10th Precinct. – Contractor: W-3 Construction Company – Location: 7601 Second Ave., Detroit, MI 48202 – Contract Period: Upon City Council Approval through July 9, 2019 –Total Contract Amount: \$878,500.00. **GENERAL SERVICES**

Respectfully submitted,

Boysie Jackson, Chief Procurement Officer
Office of Contracting and Procurement

BY COUNCIL PRESIDENT PRO TEM _____ SHEFFIELD _____

RESOLVED, that Contract No. 6001558 referred to in the foregoing communication dated March 27, 2019, be hereby and is approved.



CITY OF DETROIT
RECREATION DEPARTMENT
ADMINISTRATION OFFICE

18100 MEYERS
DETROIT, MICHIGAN 48235
(313) 224-1100 • TTY:711
(313) 224-3544
WWW.DETROITMI.GOV

21

March 22, 2018

Honorable City Council:

Re: Authorization to accept a donation of park improvements from Chandler Park Conservancy to design and install marshland at the southeast corner of Chandler Park.

Detroit General Services Department requests authorization from your Honorable Body to accept a donation of park improvements from Chandler Park Conservancy. Park improvements will consist of the design and installation of marshland at the southeast corner of Chandler Park. The purpose of this improvement is to reduce the volume of storm water draining into the city system. The estimated value of \$1.1 million will be funded through grants and donations.

Installation of the park improvements will take place in spring, 2019. The organization has worked with community representatives to ensure the improvements are desired. The selected contractor will maintain the marshland for the first three seasons (2019, 20, and 21); and ask that the General Services Department will take over at the fourth season weeding, removing invasive species and trash to maintain the site throughout the year.

We respectfully request your authorization to accept this donation of park improvements with a Waiver of Reconsideration

Sincerely,

Janet Anderson
Director



Resolution

Council Member _____

Whereas, the General Services Department is requesting authorization to accept a donation of park improvements from Chandler Park Conservancy to be installed at the southeast corner of Chandler Park.

Whereas, park improvements will consist of the installation of marshland at an estimated cost of \$1.1 million, which will be funded through grant funding and donations. The selected contractor will maintain the marshland for the first three seasons (2019-2021) and ask the General Services Department to take over in the fourth season with removal of invasive species, weeding, and trash to maintain the site throughout the year.

Resolved, the General Services Department is authorized to accept a donation of park improvements from the Chandler Park Conservancy to install a marshland at the southeast corner of Chandler Park to reduce the volume of storm water draining into the city system.



APPLICANT SECTION

Requesting Organization Name: Chandler Park Conservancy Today's Date: 3-12-2019
Contact Name: Alex Allen DPRD Property Name: Chandler Park #37
Phone: 313-264-1314 Property Address: 12831 Frankfort St.
Email: aallen@chandlerparkconservancy.org Location within the Property: Southeast area of park
Address: 4401 Conner St., Detroit, MI 48215 at Dickerson and Chandler Park Dr.

Improvement Type:

- Park Physical Improvement
 Facility (ie Rec Center) Not-Art → fill out Donation Letter
 Art → fill out Art Donation Letter
 Maintenance → fill out SLA Letter

Improvement Project Description:

(Please specify if any listed funding are for an event / program, or not for a permanent, physical improvement.)

The purpose of this project is to decrease volume of stormwater draining into city system and provide wildlife habitat opportunities in Chandler Park. The project will install a marshland to capture runoff from the east side of the park, improving drainage of Aquatic Center parking lot, and separating a portion of the combined sewer system to convey street runoff into the marshland. The project will install a wet well and pump to convey water to the marshland where a recirculation pump will feed a waterfall for aesthetics and water quality. An educational plaza and boardwalks will be installed.

Estimated Value of Improvement: \$1.1 million

By submitting this request I/We/Our Organization agree(s) to abide by all rules and policies of the City of Detroit and the General Services Department, Parks and Recreation Division. I/We also agree that all information submitted in this Park Improvement Authorization Form is true and accurate to the best of my/our knowledge and I/We hereby request that the Parks and Recreation Division consider my/our Project for approval. I/We agree at my/our own expense to defend, indemnify, save and hold harmless the City of Detroit, its officers, employees and agents against and from any and all liabilities, obligations, damages, penalties, claims, costs, charges, and expenses (including without limitation, fees and expenses of attorneys, expert witnesses and other consultants) which may be imposed upon, incurred by or asserted against myself/us and/or the City of Detroit by reason of or resulting from my/our use of the DPRD Property named above and construction of this Project as described herein.

Signature: 

Date: 3/12/19

Print Name: Alex Allen

Organization on behalf of: Chandler Park Conservancy



Recreation • Conservation • Education

3-12-2019

Jan Anderson, Director
Detroit Parks and Recreation Division
General Services Department
18100 Meyer Rd
Detroit, MI

Dear Ms. Anderson,

On behalf of the Chandler Park Conservancy, I am writing to offer our full assistance in designing and installing the Marshland at the southeast corner in Chandler Park. The costs, approximately \$1.1 Million, will be funded through grants and donations made to the Chandler Park Conservancy. These improvements will take place Spring 2019 through Spring 2020. We have worked with community representatives to ensure these improvements are desired and are in accordance of the Chandler Park Master Plan.

The installing contractor will maintain the marshland and all mechanical features for the first 3 seasons (2020, 21, 22) and we ask that GSD take over at the 4th season to remove invasive species and trash, clean out debris from the pump vault, remove accumulated sediments in the marsh conveyance basin to maintain this site throughout the year.

Thank you for your time and consideration.

Sincerely,

Alex J. Allen, III, President & CEO

Board of Directors

*Phil Pierce, Chair, Managing Member - Pierce, Monroe & Associates • Joel Kellman, Vice Chair, Dykema Gosssett
Bill McLaughlin, Treasurer, Vice President, Global Tax & Trade LEAR Corporation • Maggie DeSantis, Initiative Manager, Building the Engine of Community Development in Detroit
Donna Givens CEO, Eastside Community Network • Lisa L. Howze, Vice President for Detroit Campuses and Strategic Partnerships, Davenport University,
Andrew Humphrey, Anchor, WDIV Channel 4 • Russell Lacoursiere, Gensler • Charles Mahone, Commander, Detroit Police Department
Donna McDuffie, Chandler Park Community Resident • Jim Ridgeway, Environmental Consulting & Technology, Inc.
Jeffery D. Robinson, Ph.D, Senior Pastor, Mt. Calvary Missionary Baptist Church
Asha Shajahan, MD, MHA, Medical Director, Community Health, Beaumont Grosse Pointe • Andre Spivey, Detroit City Councilman – District 4, City of Detroit
Beverly Kindle-Walker, Detroit Eastside Community Collaborative • Alex Allen, President & CEO Chandler Park Conservancy*

Board of Advisors

*Elliott Hall • Nina Holden • Mary Kramer • Beth Konrad • Stephen Ogden • David Stephens • Laura Trudeau • James VanDyke
4401 Conner • Detroit, MI 48215 • 313-264-1415*

CHANDLER PARK MARSHLAND PROJECT

CHANDLER PARK CONSERVANCY DETROIT, MICHIGAN DRAFT

JANUARY 2019

PREPARED BY:



DRAWING INDEX

1. COVER SHEET
2. EXISTING CONDITIONS
3. SE&C AND SITE DEMO PLAN
4. PROPOSED OVERALL SITE PLAN
5. PROPOSED UTILITY PLAN
6. UTILITY PROFILE PLAN VIEW
7. UTILITY PROFILE LAYOUTS
8. PROPOSED GRADING PLAN
9. PROPOSED MARSHLAND SITE LAYOUT
10. PROPOSED MARSHLAND PLANTING PLAN
11. CONVEYANCE BASIN AND BIOSWALE DETAILS
12. DETAILS
13. PUMP DETAILS
14. ELECTRICAL DETAILS
15. OUTFALL DETAILS
16. BOARDWALK DETAILS
17. BOARDWALK DETAILS
18. CROSS SECTIONS
19. NOTES

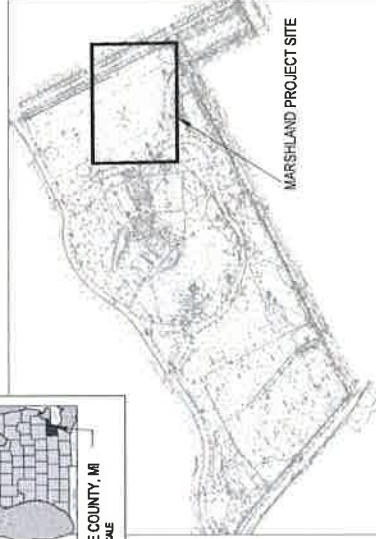
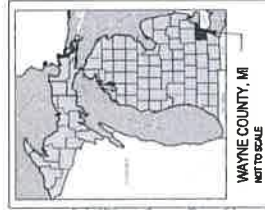

PROJECT SITE MAP
NOT TO SCALE



PROJECT VICINITY MAP
NOT TO SCALE

**CHANDLER PARK
 MARSHLAND PROJECT
 CHANDLER PARK
 CONSERVANCY
 DETROIT, MICHIGAN**

DATE	DESCRIPTION
11/15/11	FINAL DESIGN
11/15/11	REVISED DESIGN
11/15/11	PHASE 1 DESIGN
11/15/11	PHASE 2 DESIGN
11/15/11	PHASE 3 DESIGN
11/15/11	PHASE 4 DESIGN
11/15/11	PHASE 5 DESIGN
11/15/11	PHASE 6 DESIGN
11/15/11	PHASE 7 DESIGN
11/15/11	PHASE 8 DESIGN
11/15/11	PHASE 9 DESIGN
11/15/11	PHASE 10 DESIGN
11/15/11	PHASE 11 DESIGN
11/15/11	PHASE 12 DESIGN
11/15/11	PHASE 13 DESIGN
11/15/11	PHASE 14 DESIGN
11/15/11	PHASE 15 DESIGN
11/15/11	PHASE 16 DESIGN
11/15/11	PHASE 17 DESIGN
11/15/11	PHASE 18 DESIGN
11/15/11	PHASE 19 DESIGN
11/15/11	PHASE 20 DESIGN
11/15/11	PHASE 21 DESIGN
11/15/11	PHASE 22 DESIGN
11/15/11	PHASE 23 DESIGN
11/15/11	PHASE 24 DESIGN
11/15/11	PHASE 25 DESIGN
11/15/11	PHASE 26 DESIGN
11/15/11	PHASE 27 DESIGN
11/15/11	PHASE 28 DESIGN
11/15/11	PHASE 29 DESIGN
11/15/11	PHASE 30 DESIGN
11/15/11	PHASE 31 DESIGN
11/15/11	PHASE 32 DESIGN
11/15/11	PHASE 33 DESIGN
11/15/11	PHASE 34 DESIGN
11/15/11	PHASE 35 DESIGN
11/15/11	PHASE 36 DESIGN
11/15/11	PHASE 37 DESIGN
11/15/11	PHASE 38 DESIGN
11/15/11	PHASE 39 DESIGN
11/15/11	PHASE 40 DESIGN
11/15/11	PHASE 41 DESIGN
11/15/11	PHASE 42 DESIGN
11/15/11	PHASE 43 DESIGN
11/15/11	PHASE 44 DESIGN
11/15/11	PHASE 45 DESIGN
11/15/11	PHASE 46 DESIGN
11/15/11	PHASE 47 DESIGN
11/15/11	PHASE 48 DESIGN
11/15/11	PHASE 49 DESIGN
11/15/11	PHASE 50 DESIGN

PROPOSED OVERALL SITE PLAN

SCALE: 1" = 80' @ 27" x 34"

DATE: 11/15/11

SHEET NUMBER: **4**

3 WORKING DAYS BEFORE YOU DIG CALL MISS DIG 1-800-482-7171

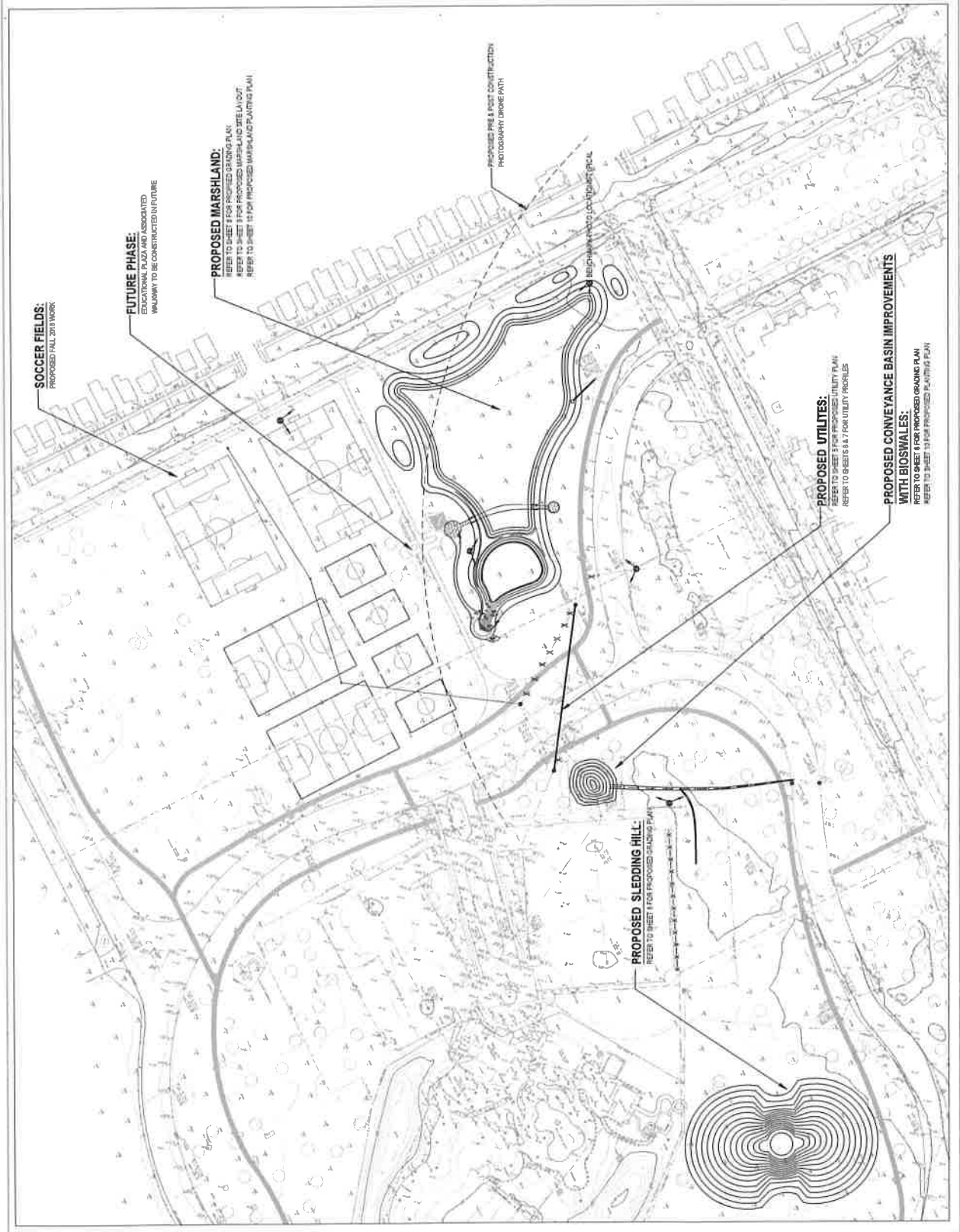

**CHANDLER PARK
PARK
MARSHLAND
PROJECT
CHANDLER PARK
CONSERVANCY
DETROIT, MICHIGAN**

FINAL DESIGN	DATE
REV. COMPLETE	DATE
REV. REVIEW	DATE
REV. APPROVAL	DATE
REV. PROJECT	DATE
REV. DESIGN	DATE
REV. CHECK	DATE
REV. DRAW	DATE
REV. PLOT	DATE
REV. PRINT	DATE
REV. FILE	DATE

SHEET NAME

**UTILITY
PROFILE
PLAN VIEW**

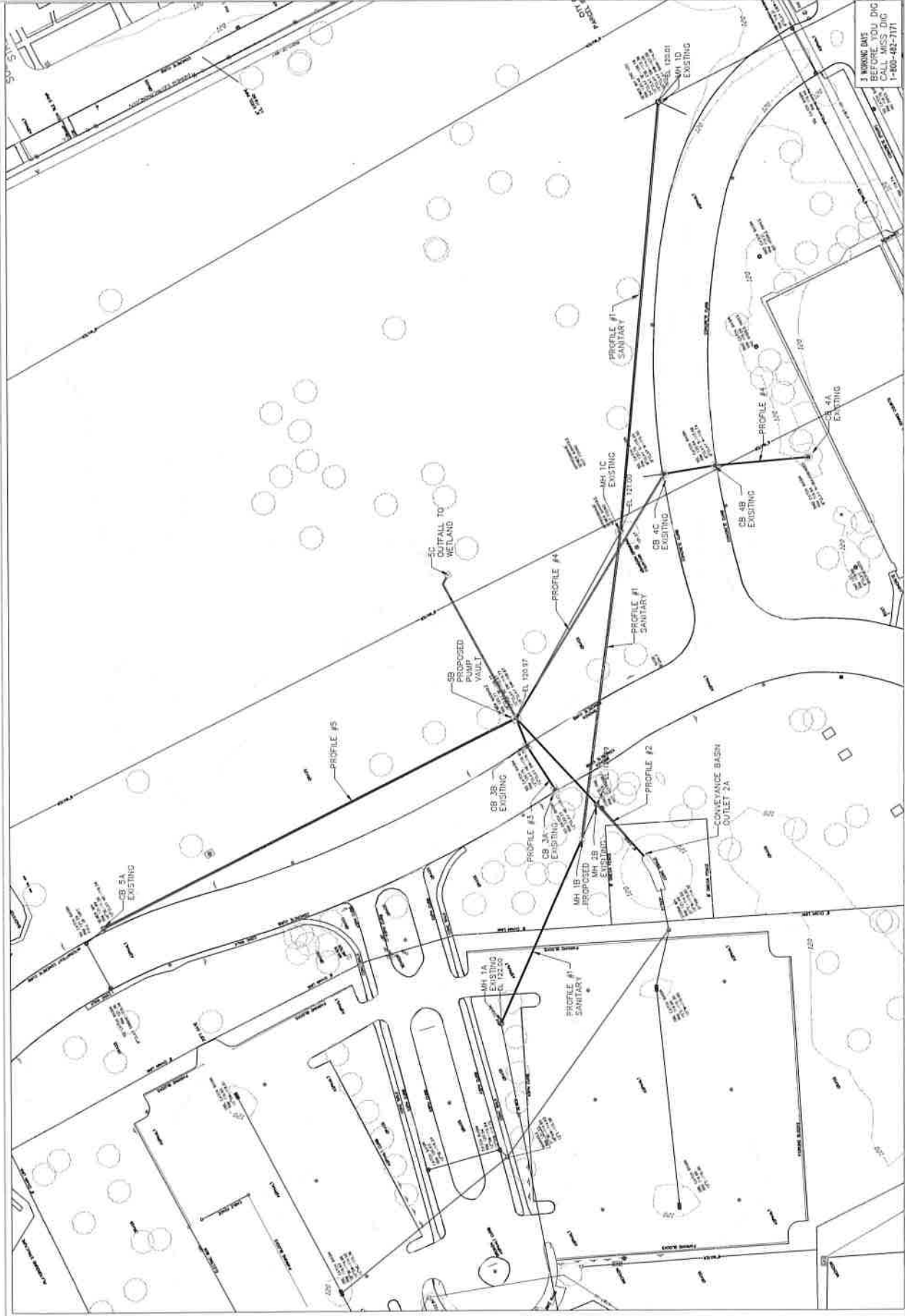

**BEFORE YOU DIG
CALL MISS.DIG
1-800-487-7171**

**Profile 2
 STORM SEWER -
 RG11 to OUTFALL**

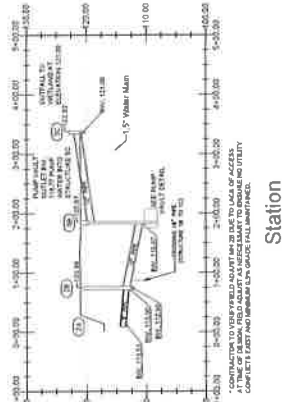

Station

**Profile 5
 STORM SEWER -
 CB5A to OUTFALL**

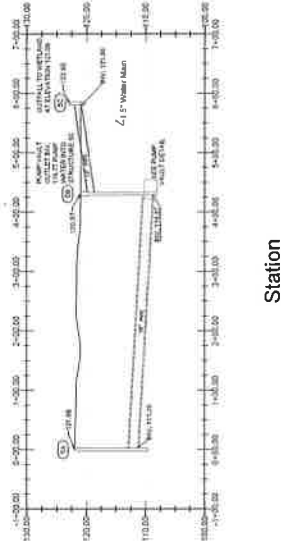

Station

**Profile 1
 SANITARY SEWER**

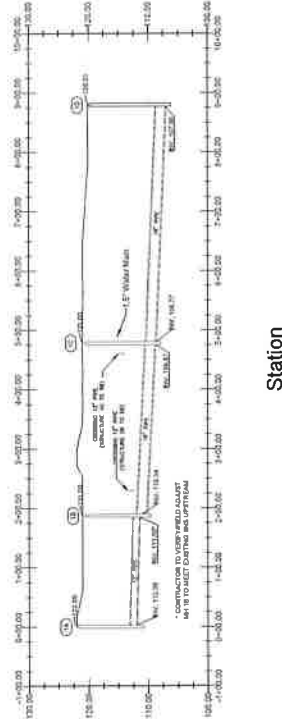

Station

**Profile 4
 STORM SEWER -
 CB4A to OUTFALL**

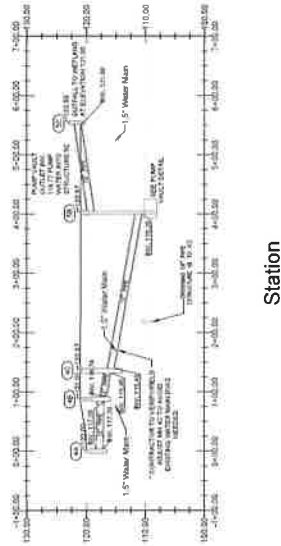

Station

**Profile 3
 STORM SEWER -
 CB3A to OUTFALL**

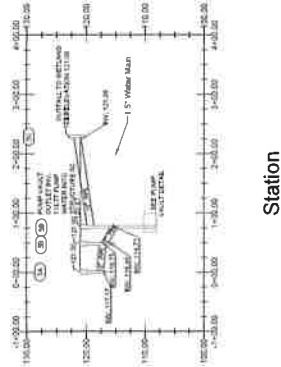

Station

IF WORKING DAYS BEFORE YOU DIG CALL MISS DIG 1-800-487-7171

FINAL DESIGN	ALBERT
REV. 02 FROM	10/2013
DESIGNER	ALBERT
PROJECT DESIGN	ALBERT
PROJECT CHECK	ALBERT
CONCEPT	ALBERT
FOR REVIEW	ALBERT
DATE	10/2013
INTENDED FOR CONTRACT	
REVISIONS	DATE/NO.
DATE	APPROVED BY

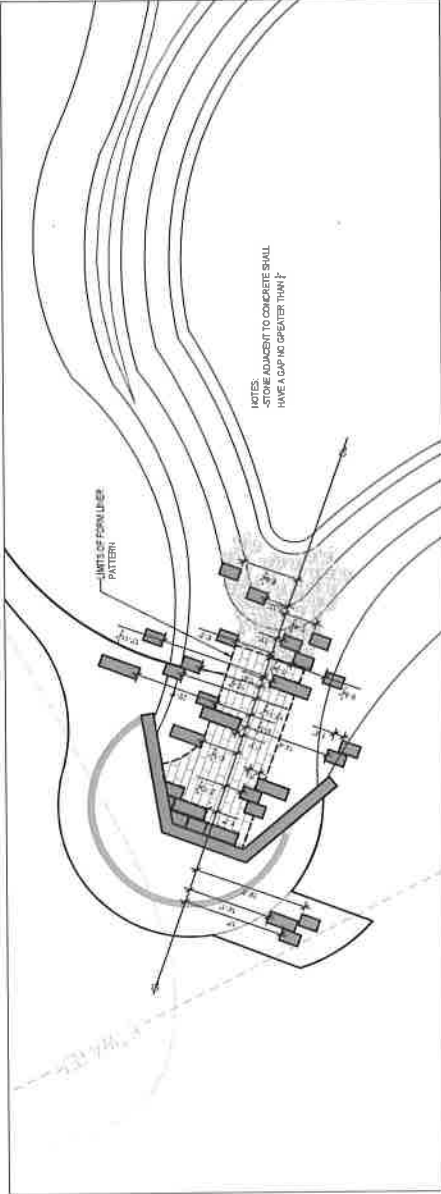

2 DETAILED LIMESTONE LAYOUT

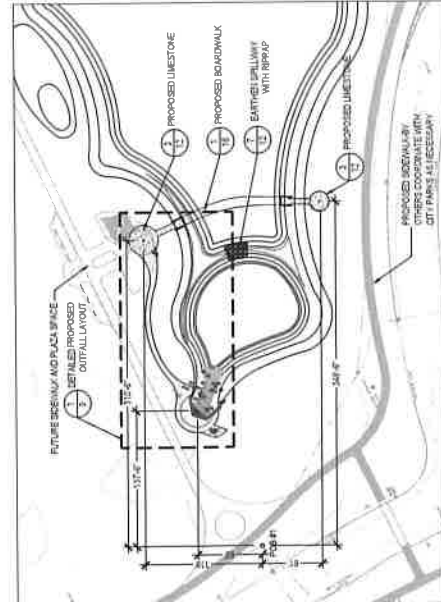

OVERALL PROPOSED MARSHLAND SITE LAYOUT

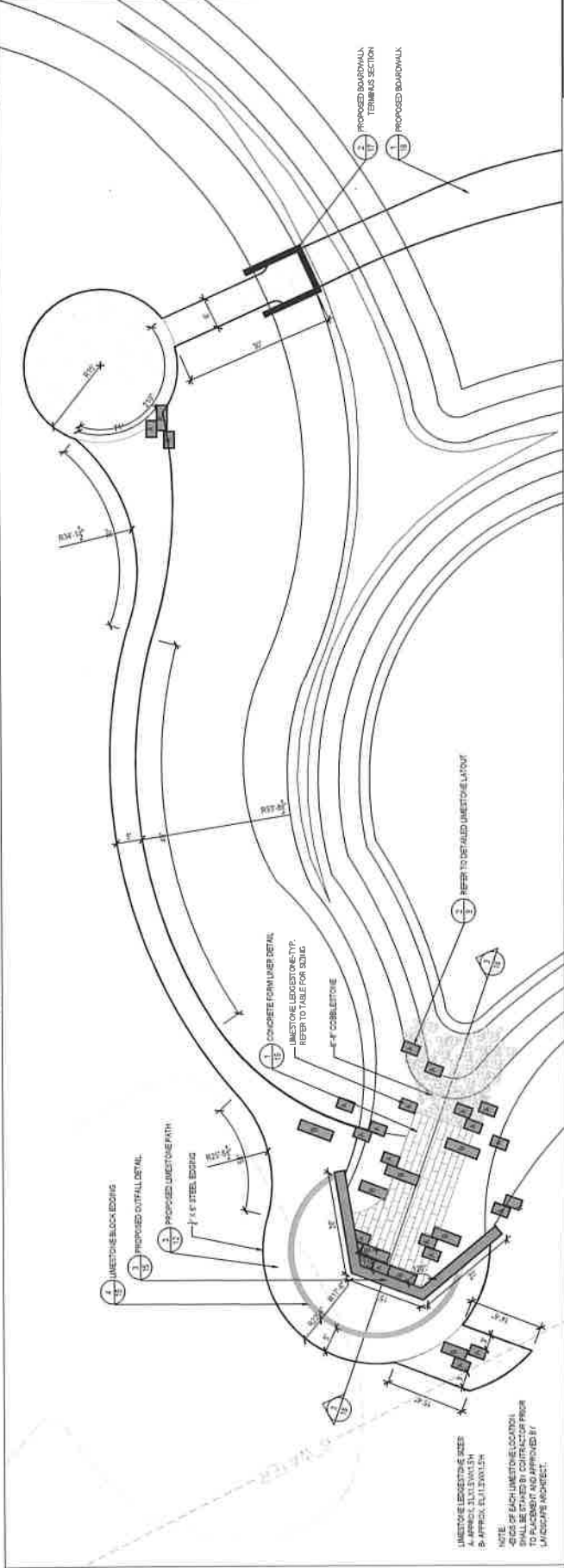

1 DETAILED PROPOSED OUTFALL LAYOUT

1 WORKING DAYS BEFORE YOU DIG CALL MISS DIG 1-800-482-7171



LIMESTONE LAYOUT ZONE
 A- APPROX. SLAT. SWALE
 B- APPROX. SLAT. SWALE
 NOTE: 1. SIDE OF EACH LIMESTONE LOCATION SHALL BE DETERMINED BY CONTRACTOR PRIOR TO INSTALLATION AND APPROVED BY LANDSCAPE ARCHITECT.

DATE	12/12/12
PROJECT	CHANDLER PARK MARSHLAND PROJECT
CLIENT	CHANDLER PARK CONSERVANCY
DESIGNER	ECT
SCALE	AS SHOWN
SHEET NAME	DETAILS
SHEET NUMBER	12

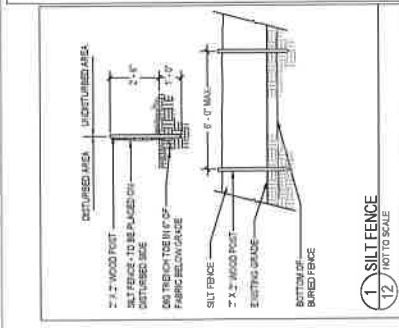

1 SILT FENCE
 NOT TO SCALE

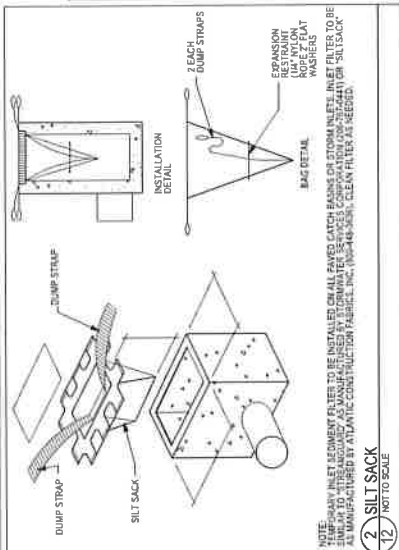

2 SILT SACK
 NOT TO SCALE

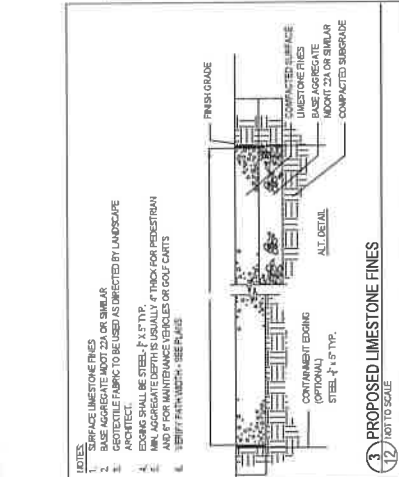

3 PROPOSED LIMESTONE FINES
 NOT TO SCALE

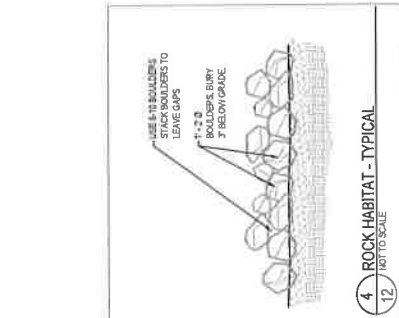

4 ROCK HABITAT - TYPICAL
 NOT TO SCALE

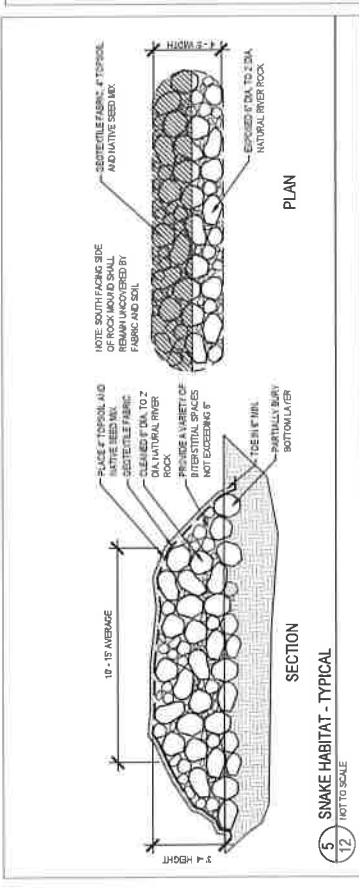

5 SNAKE HABITAT - TYPICAL
 NOT TO SCALE

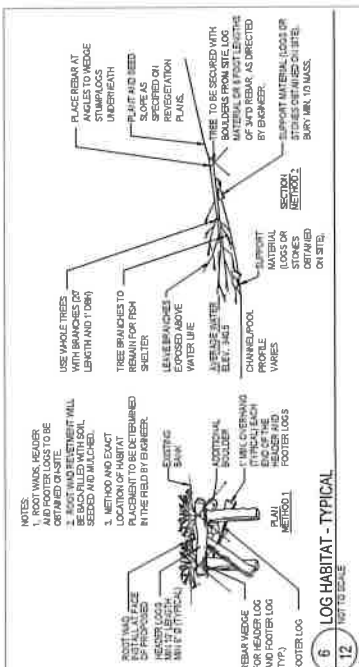

6 LOG HABITAT - TYPICAL
 NOT TO SCALE

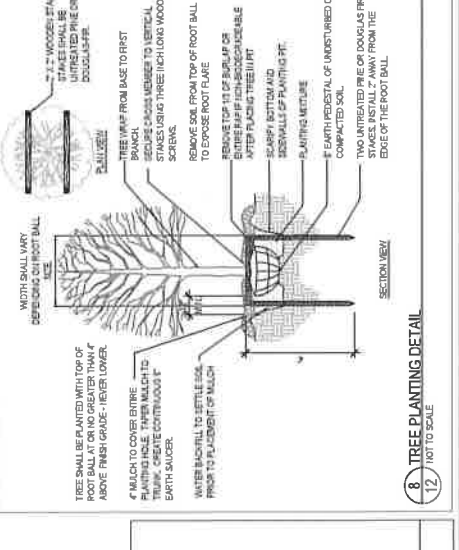

7 TREE PLANTING DETAIL
 NOT TO SCALE

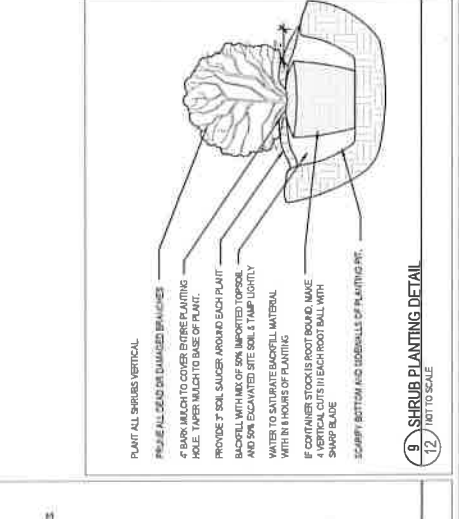

8 SHRUB PLANTING DETAIL
 NOT TO SCALE

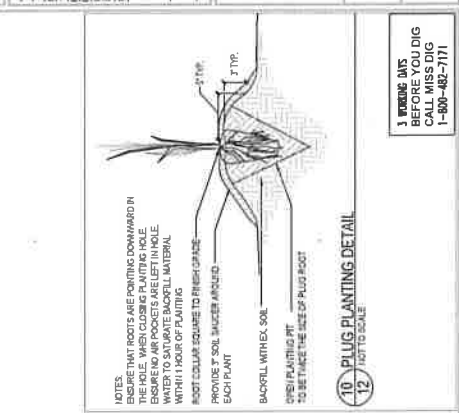

9 PLUG PLANTING DETAIL
 NOT TO SCALE

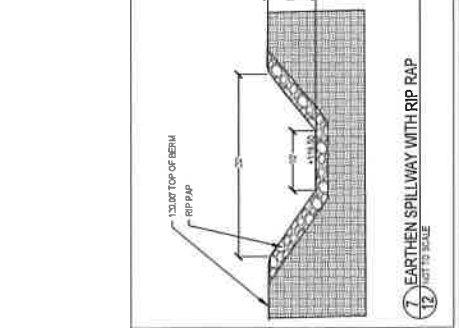

10 EARTHEN SPILLWAY WITH RIP RAP
 NOT TO SCALE

1 WORKING DAYS BEFORE YOU DIG CALL MISS DIG 1-800-482-7171

DATE	DESCRIPTION
01/15/11	ISSUED FOR PERMITS
02/15/11	ISSUED FOR PERMITS
03/15/11	ISSUED FOR PERMITS
04/15/11	ISSUED FOR PERMITS
05/15/11	ISSUED FOR PERMITS
06/15/11	ISSUED FOR PERMITS
07/15/11	ISSUED FOR PERMITS
08/15/11	ISSUED FOR PERMITS
09/15/11	ISSUED FOR PERMITS
10/15/11	ISSUED FOR PERMITS
11/15/11	ISSUED FOR PERMITS
12/15/11	ISSUED FOR PERMITS
01/15/12	ISSUED FOR PERMITS
02/15/12	ISSUED FOR PERMITS
03/15/12	ISSUED FOR PERMITS
04/15/12	ISSUED FOR PERMITS
05/15/12	ISSUED FOR PERMITS
06/15/12	ISSUED FOR PERMITS
07/15/12	ISSUED FOR PERMITS
08/15/12	ISSUED FOR PERMITS
09/15/12	ISSUED FOR PERMITS
10/15/12	ISSUED FOR PERMITS
11/15/12	ISSUED FOR PERMITS
12/15/12	ISSUED FOR PERMITS
01/15/13	ISSUED FOR PERMITS
02/15/13	ISSUED FOR PERMITS
03/15/13	ISSUED FOR PERMITS
04/15/13	ISSUED FOR PERMITS
05/15/13	ISSUED FOR PERMITS
06/15/13	ISSUED FOR PERMITS
07/15/13	ISSUED FOR PERMITS
08/15/13	ISSUED FOR PERMITS
09/15/13	ISSUED FOR PERMITS
10/15/13	ISSUED FOR PERMITS
11/15/13	ISSUED FOR PERMITS
12/15/13	ISSUED FOR PERMITS
01/15/14	ISSUED FOR PERMITS
02/15/14	ISSUED FOR PERMITS
03/15/14	ISSUED FOR PERMITS
04/15/14	ISSUED FOR PERMITS
05/15/14	ISSUED FOR PERMITS
06/15/14	ISSUED FOR PERMITS
07/15/14	ISSUED FOR PERMITS
08/15/14	ISSUED FOR PERMITS
09/15/14	ISSUED FOR PERMITS
10/15/14	ISSUED FOR PERMITS
11/15/14	ISSUED FOR PERMITS
12/15/14	ISSUED FOR PERMITS
01/15/15	ISSUED FOR PERMITS
02/15/15	ISSUED FOR PERMITS
03/15/15	ISSUED FOR PERMITS
04/15/15	ISSUED FOR PERMITS
05/15/15	ISSUED FOR PERMITS
06/15/15	ISSUED FOR PERMITS
07/15/15	ISSUED FOR PERMITS
08/15/15	ISSUED FOR PERMITS
09/15/15	ISSUED FOR PERMITS
10/15/15	ISSUED FOR PERMITS
11/15/15	ISSUED FOR PERMITS
12/15/15	ISSUED FOR PERMITS
01/15/16	ISSUED FOR PERMITS
02/15/16	ISSUED FOR PERMITS
03/15/16	ISSUED FOR PERMITS
04/15/16	ISSUED FOR PERMITS
05/15/16	ISSUED FOR PERMITS
06/15/16	ISSUED FOR PERMITS
07/15/16	ISSUED FOR PERMITS
08/15/16	ISSUED FOR PERMITS
09/15/16	ISSUED FOR PERMITS
10/15/16	ISSUED FOR PERMITS
11/15/16	ISSUED FOR PERMITS
12/15/16	ISSUED FOR PERMITS
01/15/17	ISSUED FOR PERMITS
02/15/17	ISSUED FOR PERMITS
03/15/17	ISSUED FOR PERMITS
04/15/17	ISSUED FOR PERMITS
05/15/17	ISSUED FOR PERMITS
06/15/17	ISSUED FOR PERMITS
07/15/17	ISSUED FOR PERMITS
08/15/17	ISSUED FOR PERMITS
09/15/17	ISSUED FOR PERMITS
10/15/17	ISSUED FOR PERMITS
11/15/17	ISSUED FOR PERMITS
12/15/17	ISSUED FOR PERMITS
01/15/18	ISSUED FOR PERMITS
02/15/18	ISSUED FOR PERMITS
03/15/18	ISSUED FOR PERMITS
04/15/18	ISSUED FOR PERMITS
05/15/18	ISSUED FOR PERMITS
06/15/18	ISSUED FOR PERMITS
07/15/18	ISSUED FOR PERMITS
08/15/18	ISSUED FOR PERMITS
09/15/18	ISSUED FOR PERMITS
10/15/18	ISSUED FOR PERMITS
11/15/18	ISSUED FOR PERMITS
12/15/18	ISSUED FOR PERMITS
01/15/19	ISSUED FOR PERMITS
02/15/19	ISSUED FOR PERMITS
03/15/19	ISSUED FOR PERMITS
04/15/19	ISSUED FOR PERMITS
05/15/19	ISSUED FOR PERMITS
06/15/19	ISSUED FOR PERMITS
07/15/19	ISSUED FOR PERMITS
08/15/19	ISSUED FOR PERMITS
09/15/19	ISSUED FOR PERMITS
10/15/19	ISSUED FOR PERMITS
11/15/19	ISSUED FOR PERMITS
12/15/19	ISSUED FOR PERMITS
01/15/20	ISSUED FOR PERMITS
02/15/20	ISSUED FOR PERMITS
03/15/20	ISSUED FOR PERMITS
04/15/20	ISSUED FOR PERMITS
05/15/20	ISSUED FOR PERMITS
06/15/20	ISSUED FOR PERMITS
07/15/20	ISSUED FOR PERMITS
08/15/20	ISSUED FOR PERMITS
09/15/20	ISSUED FOR PERMITS
10/15/20	ISSUED FOR PERMITS
11/15/20	ISSUED FOR PERMITS
12/15/20	ISSUED FOR PERMITS
01/15/21	ISSUED FOR PERMITS
02/15/21	ISSUED FOR PERMITS
03/15/21	ISSUED FOR PERMITS
04/15/21	ISSUED FOR PERMITS
05/15/21	ISSUED FOR PERMITS
06/15/21	ISSUED FOR PERMITS
07/15/21	ISSUED FOR PERMITS
08/15/21	ISSUED FOR PERMITS
09/15/21	ISSUED FOR PERMITS
10/15/21	ISSUED FOR PERMITS
11/15/21	ISSUED FOR PERMITS
12/15/21	ISSUED FOR PERMITS
01/15/22	ISSUED FOR PERMITS
02/15/22	ISSUED FOR PERMITS
03/15/22	ISSUED FOR PERMITS
04/15/22	ISSUED FOR PERMITS
05/15/22	ISSUED FOR PERMITS
06/15/22	ISSUED FOR PERMITS
07/15/22	ISSUED FOR PERMITS
08/15/22	ISSUED FOR PERMITS
09/15/22	ISSUED FOR PERMITS
10/15/22	ISSUED FOR PERMITS
11/15/22	ISSUED FOR PERMITS
12/15/22	ISSUED FOR PERMITS
01/15/23	ISSUED FOR PERMITS
02/15/23	ISSUED FOR PERMITS
03/15/23	ISSUED FOR PERMITS
04/15/23	ISSUED FOR PERMITS
05/15/23	ISSUED FOR PERMITS
06/15/23	ISSUED FOR PERMITS
07/15/23	ISSUED FOR PERMITS
08/15/23	ISSUED FOR PERMITS
09/15/23	ISSUED FOR PERMITS
10/15/23	ISSUED FOR PERMITS
11/15/23	ISSUED FOR PERMITS
12/15/23	ISSUED FOR PERMITS
01/15/24	ISSUED FOR PERMITS
02/15/24	ISSUED FOR PERMITS
03/15/24	ISSUED FOR PERMITS
04/15/24	ISSUED FOR PERMITS
05/15/24	ISSUED FOR PERMITS
06/15/24	ISSUED FOR PERMITS
07/15/24	ISSUED FOR PERMITS
08/15/24	ISSUED FOR PERMITS
09/15/24	ISSUED FOR PERMITS
10/15/24	ISSUED FOR PERMITS
11/15/24	ISSUED FOR PERMITS
12/15/24	ISSUED FOR PERMITS

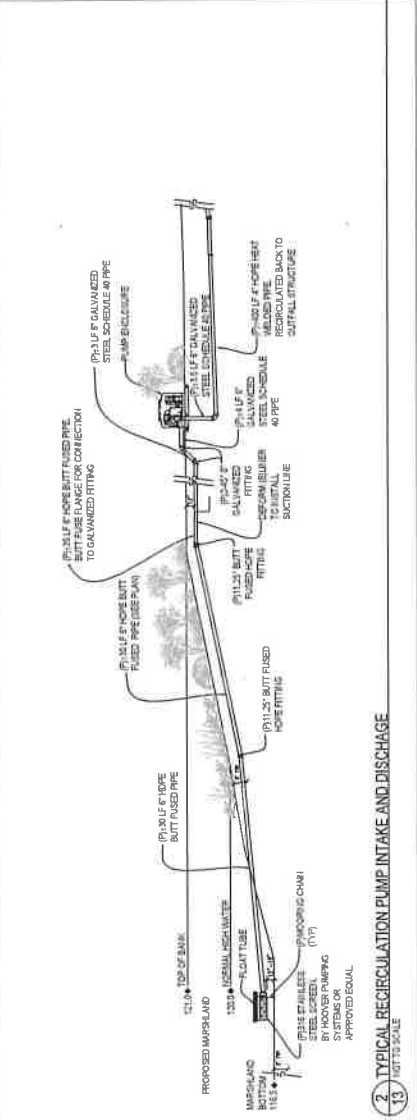

2 TYPICAL RECIRCULATION PUMP INTAKE AND DISCHARGE
 NOT TO SCALE

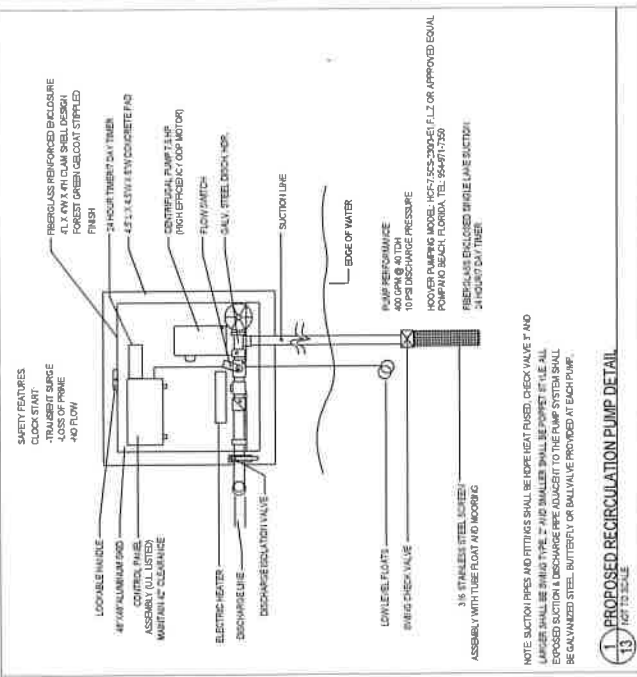

1 PROPOSED RECIRCULATION PUMP DETAIL
 NOT TO SCALE

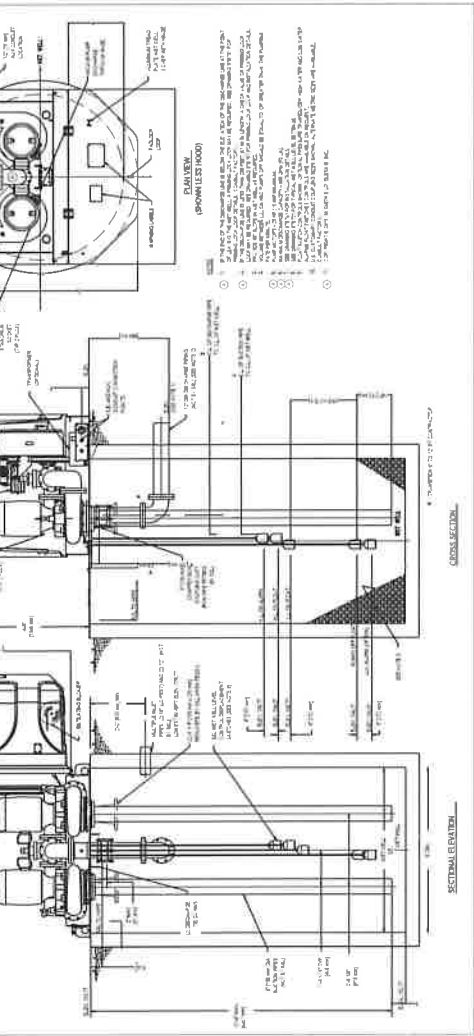

4 PROPOSED PUMP VAULT WITH PUMP DETAIL
 NOT TO SCALE

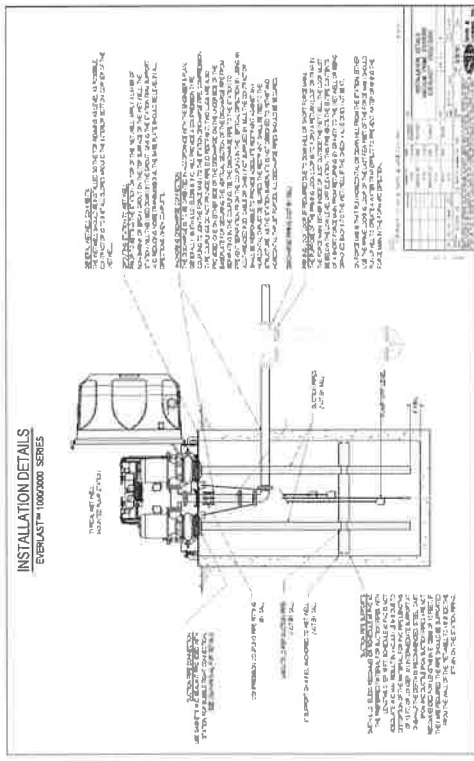

3 PUMP INSTALLATION DETAIL
 NOT TO SCALE



CITY OF DETROIT
RECREATION DEPARTMENT
ADMINISTRATION OFFICE

18100 MEYERS
DETROIT, MICHIGAN 48235
(313) 224-1100 • TTY:711
(313) 224-3544
WWW.DETROITMI.GOV

22

March 22, 2018

Honorable City Council:

Re: Authorization to accept a donation of park improvements from People for Palmer Park for the installation of commemorative signage.

Detroit General Services Department requests authorization from your Honorable Body to accept a donation of park improvements from the People for Palmer Park. Park improvements will consist of the installation of commemorative signage to be placed at the Community House, bike fit it station, and at the corner of 7 mile and Pontchatrain. The estimated value of \$1750.00 will be borne by People for Palmer Park.

Installation of the park improvements will take place under the guidance of the General Services Department. The organization has worked with community representatives to ensure the improvements are desired. People for Palmer Park will maintain the commemorative signs and replace them as needed.

We respectfully request your authorization to accept this donation of park improvements with a Waiver of Reconsideration

Sincerely,

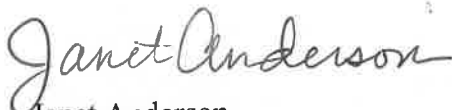
Janet Anderson
Director



Resolution

Council Member _____

Whereas, the General Services Department is requesting authorization to accept a donation of park improvements from People for Palmer Park to be installed in various locations within Palmer Park.

Whereas, park improvements will consist of the installation of commemorative signage at an estimated cost of \$1,750.00 which will be borne by People for Palmer Park. The organization will maintain the signs and replace them as needed.

Resolved, the General Services Department is authorized to accept a donation of park improvements from the People for Palmer Park for the installation of commemorative signage to be placed at various locations inside Palmer Park.



APPLICANT SECTION

Requesting Organization Name: People for Palmer Park Today's Date: 2/26/2019
 Contact Name: Rochelle Lento (President) DPRD Property Name: Palmer Park
 Phone: 313-727-9925 Property Address: 910 Merrill Plaisance, Detroit, MI 48203
 Email: rlento@dykema.com Location within the Property: Multiple
 Address: PO Box 43735, Detroit, MI 48243

Improvement Type:

Park

Facility (ie Rec Center)

Physical Improvement

Not-Art ———> fill out Donation Letter

Art ———> fill out Art Donation Letter

Maintenance ———> fill out SLA Letter

Improvement Project Description:

(Please specify if any listed funding are for an event / program, or not for a permanent, physical improvement.)

1. Sign commemorating "Reflections Portal" sculpture at 7 Mile & Pontchartrain.
2. Sign posted on the Palmer Park Community House
3. Small plaque on the Bike Fix-it Station (next to Community House)

* Sign locations to be verified by City Representative prior to installation
 * Signs to be maintained by People for Palmer Park.

Estimated Value of Improvement: \$1750.00

By submitting this request I/We/Our Organization agree(s) to abide by all rules and policies of the City of Detroit and the General Services Department, Parks and Recreation Division. I/We also agree that all information submitted in this Park Improvement Authorization Form is true and accurate to the best of my/our knowledge and I/We hereby request that the Parks and Recreation Division consider my/our Project for approval. I/We agree at my/our own expense to defend, indemnify, save and hold harmless the City of Detroit, its officers, employees and agents against and from any and all liabilities, obligations, damages, penalties, claims, costs, charges, and expenses (including without limitation, fees and expenses of attorneys, expert witnesses and other consultants) which may be imposed upon, incurred by or asserted against myself/us and/or the City of Detroit by reason of or resulting from my/our use of the DPRD Property named above and construction of this Project as described herein.

Signature: Rochelle E. Lento

Date: 2/26/2019

Print Name: Rochelle E. Lento, President

Organization on behalf of: People for Palmer Park

Please return this form to: **Juliana Fulton**
fultonj@detroitmi.gov
313-628-2365

General Services
18100 Meyers Rd, Upper Level
Detroit MI 48235

Page 2

GSD STAFF SECTION

Asset Information:

DPRD Property Number: 133 Asset Life Cycle: 10 Years

Asset Value: Sign for Community House = \$336 Decommission Cost: \$250.00

Sign for Bike station = \$54, Sign for sculpture = \$492

Installation = \$420, Design Work = \$180.

Maintenance Information:

GSD Maintenance Requirements: None GSD Operations Requirements: None

GSD Project Coordinator: Janet Date: 3/5/2019

Authorization:

- Project Denied
- Project Approved as Submitted
- Project Approved with Changes: _____

*Approved by GSD Director: Janet Anderson Date: March 11, 2019

*Requesting Group shall not have approval to make the requested park improvement without the approval of the General Services Department Director

Community House

Proposed sign placement: *On the band above the colorful brick wall.*

Proposed sign will read: *"Palmer Park Community House" with the City of Detroit Parks & Rec logo/PFPP logo above that.*

Sign dimensions: *Approximately 60 inches wide x 24 inches tall (could be little bigger)*

See mockup below for proposed sign location

Bike Station

This is located next to the Community House at Merrill Plaisance & Pontchartrain.

Proposed sign placement: *The plaque needs to be mounted flat on a metal bike station post.*

Proposed sign will read: *"Bike Station provided with support from [People for Palmer Park logo] 2016."*

Plaque dimensions: *4 inches wide x 3 inches tall*

See mockup below for proposed plaque location

Reflections Sculpture

This is located at Pontchartrain and 7 Mile Rd north entrance to the park.

Proposed sign placement: *The plaque needs to be mounted on a separate base and posted in the ground next to the sculpture in the grass off the pathway.*

Proposed sign will read:

Reflections Portal

Artist: John Rizzo

"The gateway acts as a point of transformation for those passing through it to reinterpret the space that surrounds them, and to heighten their perception of things normally unnoticed."

2016 Donation of the artist, with support of People for Palmer Park, the City of Detroit and Michigan Recreational Construction

Plaque dimensions: *Approx. 24 inches wide x 10 inches tall*

See mockup below for proposed sign location



People *for* Palmer Park 

Palmer Park

COMMUNITY  HOUSE

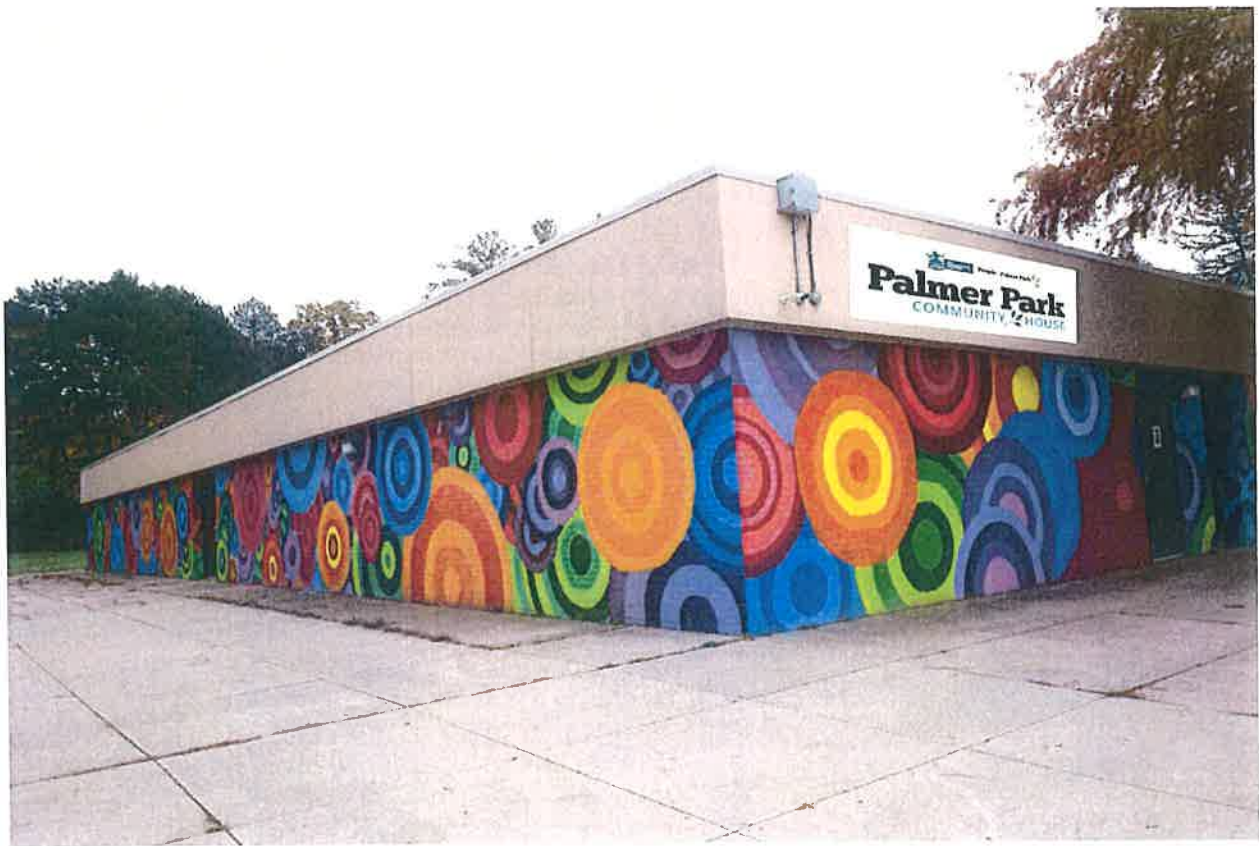

*Bike Station provided
with support from*



Detail

Reflections Portal

Artist: John Rizzo

"The gateway acts as a point of transformation for those passing through it to reinterpret the space that surrounds them, and to heighten their perception of things normally unnoticed."

2016 Donation of the artist, with support of People for Palmer Park, the City of Detroit and Michigan Recreational Construction





CITY OF DETROIT
RECREATION DEPARTMENT
ADMINISTRATION OFFICE

18100 MEYERS
DETROIT, MICHIGAN 48235
(313) 224-1100 • TTY:711
(313) 224-3544
WWW.DETROITMI.GOV

23

March 22, 2018

Honorable City Council:

Re: Authorization to accept a donation of park improvements from Chandler Park Conservancy to decrease volume of storm water draining into the system.

Detroit General Services Department requests authorization from your Honorable Body to accept a donation of park improvements from Chandler Park Conservancy. Park improvements will consist of the installation of bio-swales (rain gardens) to decrease the volume of storm water draining into the city water system. The estimated value of \$28,321 will be borne by the conservancy through grant funding and fund raising.

Installation of the park improvements will take place in spring, 2019. The organization has worked with community representatives to ensure the improvements are desired. The selected contractor will maintain the rain garden for the first three seasons (2019, 20, and 21); and ask that the General Services Department will take over at the fourth season weeding, removal of invasive species and trash to maintain the site throughout the year.

We respectfully request your authorization to accept this donation of park improvements with a Waiver of Reconsideration

Sincerely,

Janet Anderson
Director



Resolution

Council Member _____

Whereas, the General Services Department is requesting authorization to accept a donation of park improvements from Chandler Park Conservancy to be installed at Chandler Park.

Whereas, park improvements will consist of the installation of a bioswale (rain garden) at an estimated cost of \$28,321. The selected contractor will maintain the rain garden for the first three seasons and ask the General Services Department to take over in the fourth season with removal of invasive species, weeding, and trash to maintain the site throughout the year.

Resolved, the General Services Department is authorized to accept a donation of park improvements from the Chandler Park Conservancy to install a bioswale in Chandler Park to reduce the volume of storm water draining into the city system.



APPLICANT SECTION

Requesting Organization Name: Chandler Park Conservancy Today's Date: 3-12-2019
 Contact Name: Alex Allen DPRD Property Name: Chandler Park #37
 Phone: 313-264-1314 Property Address: 12831 Frankfort St.
 Email: aallen@chandlerparkconservancy.org Location within the Property: South area of park
 Address: 4401 Conner St., Detroit, MI 48215 next to tennis courts

Improvement Type:

- Park Physical Improvement
 Facility (ie Rec Center) Not-Art → fill out Donation Letter
 Maintenance → fill out SLA Letter Art → fill out Art Donation Letter

Improvement Project Description:

(Please specify if any listed funding are for an event / program, or not for a permanent, physical improvement.)

The purpose of this project is to decrease volume of stormwater draining into city system.
The project will install a bioswale/rain garden east of the tennis courts to capture runoff from the courts.

Estimated Value of Improvement: \$28,321

By submitting this request I/We/Our Organization agree(s) to abide by all rules and policies of the City of Detroit and the General Services Department, Parks and Recreation Division. I/We also agree that all information submitted in this Park Improvement Authorization Form is true and accurate to the best of my/our knowledge and I/We hereby request that the Parks and Recreation Division consider my/our Project for approval. I/We agree at my/our own expense to defend, indemnify, save and hold harmless the City of Detroit, its officers, employees and agents against and from any and all liabilities, obligations, damages, penalties, claims, costs, charges, and expenses (including without limitation, fees and expenses of attorneys, expert witnesses and other consultants) which may be imposed upon, incurred by or asserted against myself/us and/or the City of Detroit by reason of or resulting from my/our use of the DPRD Property named above and construction of this Project as described herein.

Signature:  Date: 3/12/19

Print Name: Alex Allen

Organization on behalf of: Chandler Park Conservancy



Recreation • Conservation • Education

3-12-2019

Jan Anderson, Director
Detroit Parks and Recreation Division
General Services Department
18100 Meyer Rd
Detroit, MI

Dear Ms. Anderson,

On behalf of the Chandler Park Conservancy, I am writing to offer our full assistance in designing and installing a Rain Garden at the tennis courts in Chandler Park. The costs, approximately \$28,321, will be funded through grants and donations made to the Chandler Park Conservancy. These improvements will take place in Spring 2019. We have worked with community representatives to ensure these improvements are desired and are in accordance of the Chandler Master Plan. The installing contractor will maintain the rain garden for the first 3 season,(2019, 20, 21) and we ask that GSD take over at the 4th season to weed, remove invasive species and trash to maintain this site throughout the year.

Thank you for your time and consideration.

Sincerely,

Alex J. Allen, III, President & CEO

Board of Directors

*Phil Pierce, Chair, Managing Member - Pierce, Monroe & Associates • Joel Kellman, Vice Chair, Dykema Gossett
Bill McLaughlin, Treasurer, Vice President, Global Tax & Trade LEAR Corporation • Maggie DeSantis, Initiative Manager, Building the Engine of Community Development in Detroit
Donna Givens CEO, Eastside Community Network • Lisa L. Howze, Vice President for Detroit Campuses and Strategic Partnerships, Davenport University,
Andrew Humphrey, Anchor, WDIV Channel 4 • Russell Lacoursiere, Gensler • Charles Mahone, Commander, Detroit Police Department
Donna McDuffie, Chandler Park Community Resident • Jim Ridgeway, Environmental Consulting & Technology, Inc.
Jeffery D. Robinson, Ph.D, Senior Pastor, Mt. Calvary Missionary Baptist Church
Asha Shajahan, MD, MHSA, Medical Director, Community Health, Beaumont Grosse Pointe • Andre Spivey, Detroit City Councilman – District 4, City of Detroit
Beverly Kindle-Walker, Detroit Eastside Community Collaborative • Alex Allen, President & CEO Chandler Park Conservancy*

Board of Advisors

*Elliott Hall • Nina Holden • Mary Kramer • Beth Konrad • Stephen Ogden • David Stephens • Laura Trudeau • James VanDyke
4401 Conner • Detroit, MI 48215 • 313-264-1415*

PROPOSED GARDEN



CHANDLER PARK TENNIS COURTS EASTSIDE COMMUNITY NETWORK DETROIT, MICHIGAN

SCALE: 1" = 20' 0"

SHEET NUMBER 2

WORKING DATE: BEFORE YOU DIG CALL 811 TO LOCATE UTILITIES 1-800-482-7111

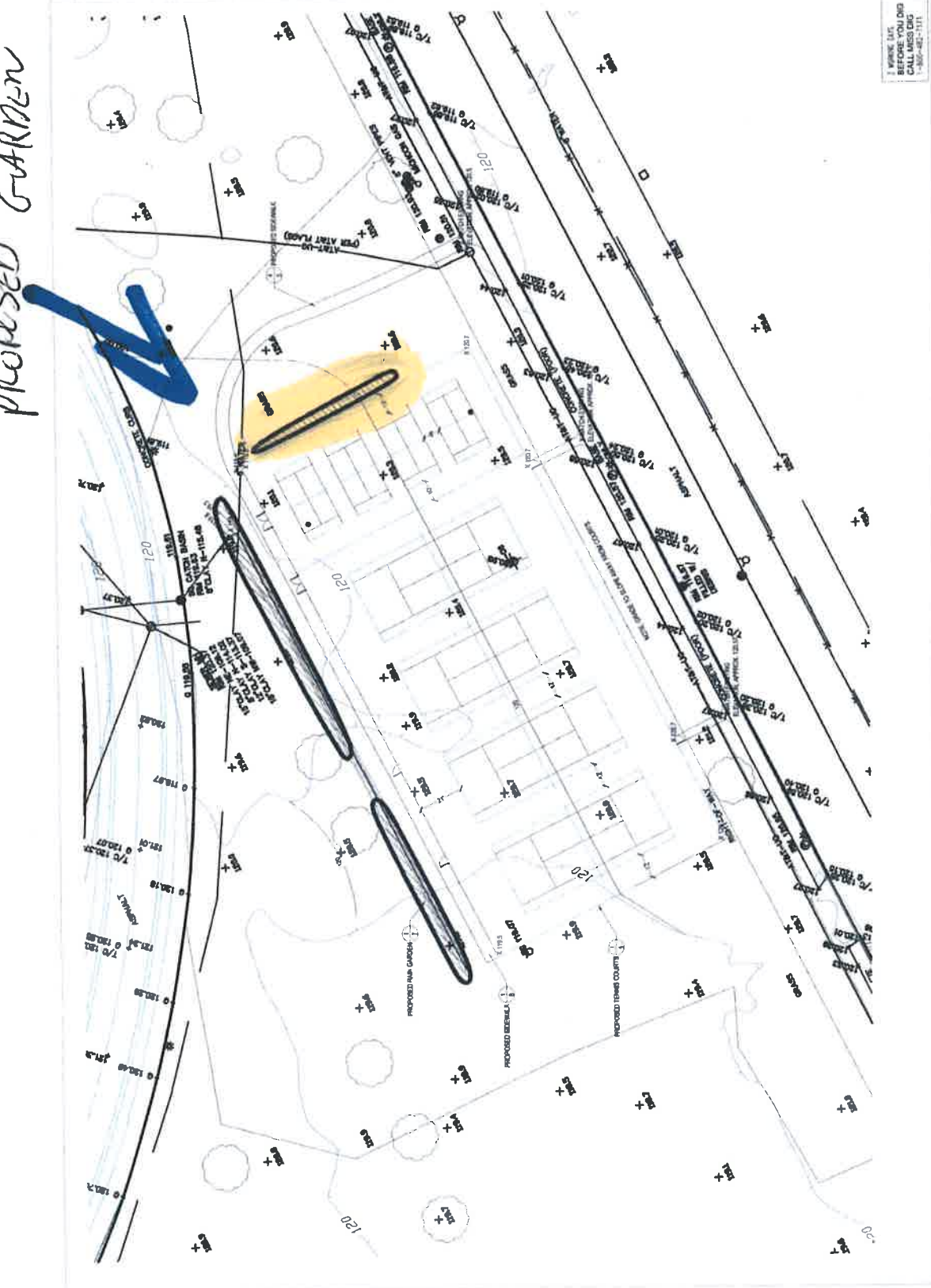

Site plan details including labels for 'PROPOSED GARDEN', 'PROPOSED BEHOLD', 'PROPOSED TENNIS COURTS', and various utility markers like '120' and '121'.



Rain Garden

23

Frankfort St

Cherry Park

Frankfort St